



Lexon

 **LUNAR**

Lightweight touring 2007

## Contents

- 2 Lunar landscape 2007**
- 3 Zenith 4, 5 and 6 berth**  
A great value, lightweight with a choice of family berth options to meet every need.
- 5 Ariva 2 berth**  
Narrower and lighter than ANY of its rivals, Ariva has led the way in compact touring luxury since its introduction.
- 7 Solaris 4 berth**  
Amazing value and great specification with the luxury of fixed bed layouts.
- 9 Stellar 2 berth**  
Compact size and easy to manage, yet amazingly roomy.
- 11 Quasar 2, 4, 5 and 6 berth**  
Exceptional value, light-in-weight and packed with quality features.
- 13 Lexon 4 berth**  
The innovative Lexon uses its extra width and specially developed interior layouts to amazing spacious effect.
- 15 Clubman 2 berth**  
The appeal of the Clubman's classic styling and craftsman built quality makes it a much envied flagship range.
- 17 Delta 2 berth**  
The superb Delta applies Lunar design and Clubman quality to create an innovative caravan with great looks and a specification to match.
- 19 Thoughtful features that make Lunar special**
- 20 Weightlessness**  
The secrets behind Lunar's legendary high quality, lightweight construction.
- 21 The 2007 Lunar Range**  
A complete breakdown of the impressive range of features for every caravan in the Lunar range.
- 23 Detailed specification tables**



# The Lunar landscape 2007

Building on over 35 years as THE leaders in lightweight touring technology, Lunar's 2007 caravan collection is quite simply superb.

New layouts, intelligent design and high quality fittings and furnishings are matched with smooth, external styling in a package that is famously **MUCH LIGHTER THAN ANY OF OUR RIVALS**.

2007 ushers in a series of completely redesigned models, each with sleek, bright exteriors complimented by stylish, modern soft furnishings and attractive new woodwork.

We are particularly proud of our cabinet work with its newly designed doors.. Attention to detail is everywhere, whilst the subtle curves and angles we use create spacious, pleasing, eminently comfortable interiors.

Of course this brochure can only offer you a taste of Lunar quality. With so many great reasons to choose Lunar it's time you paid a visit to one of our national network of dealers, and with 21 models in eight ranges to choose from, **WE KNOW THERE'S A SUPERB LIGHTWEIGHT LUNAR THAT'S PERFECT FOR YOU!**

## Pictured:

The simply operated flush-fit slide-out table extension that is a notable new feature on every 2007 Lunar is a major user-friendly improvement [E]. A high quality Blaupunkt CD/DVD audio/Radio/MP3 player offers cutting edge sound quality in the Clubman and Delta [B].

Adding to the modern styling of the interiors, large, shaggy cushions feature in numerous 2007 models [C]. NEW for 2007, the Wok burner that now features in every model reflects a changing approach to modern British cookery [D], cooking on the run is catered for too with the fitted microwave [F] that comes as standard in many Lunar models. Smart, rugged household quality taps have long been a feature of Lunar kitchens, all models now come with a handy drainer/chopping board giving more free work space in the kitchen [G].

The easily removed, easy-clean loose fit carpetover the parquet-style cushioned flooring featured in all models are a practical answer to modern all-weather, all season touring [H].

The new profiled front window sections are both stylish and substantial [I]. Alloy wheels are a feature that you'd have to pay extra for on your car! They come as standard on most models and are matched with attractive wheel arch spats [J], whilst the high quality alarm system [K] is another key feature now fitted as standard to all Lexon, Clubman and Deltas.

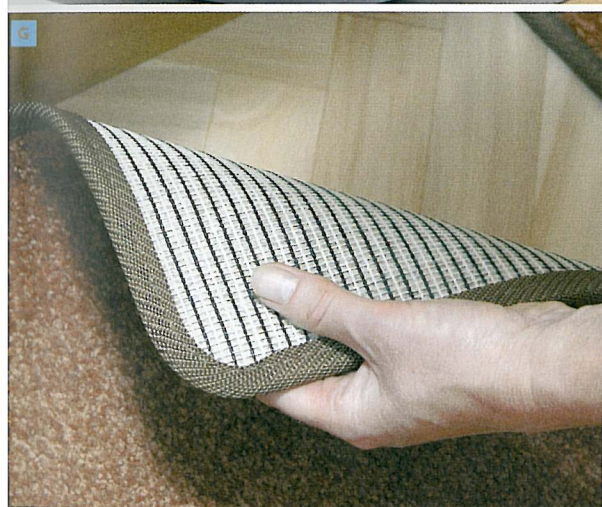

# Zenith

Lunar's three great looking 2007 Zenith models represent fantastic value for all the family.

Available in 4, 5 berth and 6 berth models, the 2007 season sees the introduction of the new fixed bed Zenith EB - a sure-fire winner with caravanners who are looking for luxurious comfort as well as great value.

The bright exterior graphics of the 2007 models are complimented by stylish new 'Kirsch' cherry coloured woodwork and attractive new furnishings and wallboard.

Lunar's years of experience ensure practicality is also top of the list. Every Zenith is mounted on a single axle chassis, offering maximum tow-ability for a wide variety of family cars, whilst the easy-clean loose-fit carpeting makes the Zenith a great choice for all-year, any weather touring.





**Fresh Zenith features for 2007**

- Easy-clean loose fit carpets.
- High quality furniture handles.
- Sink giving a larger work surface.
- Handy removable draining board.
- Special Wok-friendly burner.
- Attractive new front panel and window design.
- Support struts for gas locker door.
- Colour keyed grab handles.
- Stylish new graphics.
- New look redesigned rear panel and light clusters.
- New wall and ceiling finish.
- Attractive new furniture colour and laminate.
- New wheelspats.
- Handy bedside cabinet with easy-open flush-fit table extension.

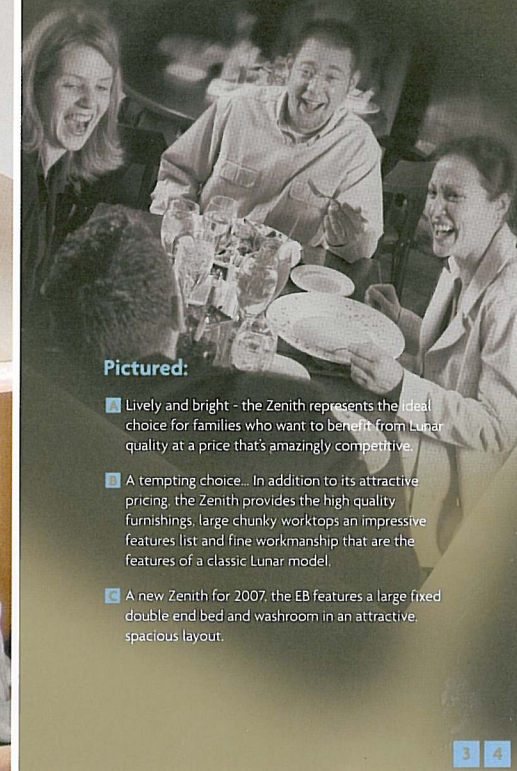

**Pictured:**

- Lively and bright - the Zenith represents the ideal choice for families who want to benefit from Lunar quality at a price that's amazingly competitive.
- A tempting choice... In addition to its attractive pricing, the Zenith provides the high quality furnishings, large chunky worktops an impressive features list and fine workmanship that are the features of a classic Lunar model.
- A new Zenith for 2007, the EB features a large fixed double end bed and washroom in an attractive, spacious layout.

# Ariva

Narrower and lighter than ANY of its rivals, the luxurious Ariva is totally unique in its class, offering serious caravanning luxury in an easy to handle, lightweight body.

The Ariva's clever design utilises a classic rear-end kitchen layout with a large fridge featuring a full width freezer that's ideal for storing those little indulgences. Combining features like the attractive curved, integrated roof lockers that offer ample storage and the swivel toilet in the surprisingly large, light shower room, the Ariva delivers top specification in an amazingly spacious compact package.

For the adventurous tourer, this roomy model is also ideal for year-round caravanning. Ample insulation and a powerful gas/electric room heater with ducted blown air ensure the Ariva stays snug in the coldest weather.





### Fresh Ariva features for 2007

- Easy-clean loose fit carpets.
- New roof locker door design.
- New high quality furniture handles.
- Fitted CD/Radio with two speakers.
- Special Wok-friendly burner.
- New internal mains lights.
- Status 530 multi-directional TV aerial.
- Attractive new front panel and window design.
- Support struts for gas locker door.
- Colour keyed grab handles.
- Stylish new graphics.
- New look redesigned rear panel and light clusters.
- New ceiling finish.
- New wheelspats.
- Handy bedside cabinet with easy-open flush-fit table extension.



### Pictured:

- A Lunar's 2 berth Ariva has a longstanding reputation for packing an awful lot of caravan into a compact, easily towed unit. In 2007 the full kitchen, drinks cabinet, ample storage and shower/toilet are set off by fresh, bright soft furnishings.
- B Despite its small size clever design features like the toughened glass hob cover ensure there's plenty of space to prepare a fine feast for two.
- C In 2007 the Ariva's smart new graphics compliment a sleek new rear panel and light clusters that recall classic Art Deco design.

# Solaris

First introduced as special limited editions, the Solaris have proved so popular that they have been added to the famous Lunar range.

Solaris offers a world of touring comfort based around variations of a fixed bed arrangement with a wide body creating an amazingly spacious interior.

The light, airy feel is matched with quality furniture and soft furnishings, plus a host of extra high specification features that make these models something really special.

Combining exceptional value and touring comfort in an attractive lightweight package, Solaris has already proved enormously popular. Now 2007 sees a third model in the series with a separate shower and a luxurious walk around double bed at the rear.

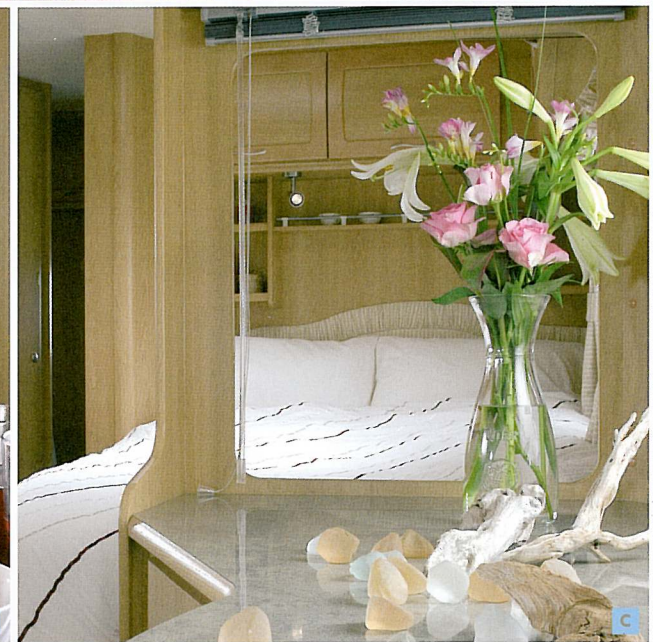





**Fresh Solaris features for 2007**

- Easy-clean loose fit carpets.
- Handy chopping board/drainers.
- Special Wok-friendly burner.
- New ceiling finish.
- New wheels/pats.
- Handy bedside cabinet with easy-open flush-fit table extension.

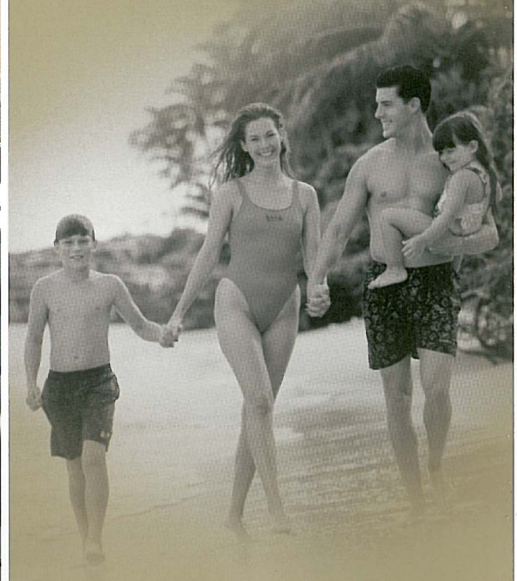

**Pictured:**

- ▲ The fixed bed that is a signature feature of Lunar's premium value Solaris range adds luxurious comfort to a remarkably spacious layout.
- Intelligence in design: the little details, like accessible, neatly grouped controls and exceptional levels of finish mark the Solaris out as a Lunar.
- Ample large windows and roof lights and an open, spacious interior help flood the Solaris models with natural daylight.
- Real quality AND real value: every Solaris model offers incredible comfort and a raft of great features at a remarkably competitive price.



# Stellar

Lunar's award winning Stellar was especially created to deliver an unrivalled and invaluable level of spaciousness in a luxurious caravan of an easily manageable wide bodied, yet compact size.

The Stellar has an attractive rear-offside kitchen which is set off by 'Kirsch' cherry coloured woodwork and wallboard and new ceiling board that is complemented by the beautiful re-styled natural wood framed roof locker doors.

Building on an already highly respected pedigree, Stellar sees a host of further features added in 2007 to deliver an ultra-high specification caravan that is an ever popular choice for discerning couples.





#### Fresh Stellar features for 2007

- Easy-clean loose fit carpets
- Status 530 multi-directional TV aerial
- New roof locker door design
- New high quality furniture handles
- New sink giving a larger work surface
- Handy chopping board/drainer
- Special Wok-friendly burner
- Fitted CD/ Radio with two speakers
- New internal mains lights
- Attractive new front panel and window design
- Support struts for gas locker door
- Colour keyed grab handles
- Stylish new graphics
- New look redesigned rear panel and light clusters
- New high level brake light
- New larger capacity Thetford fridge
- New ceiling finish
- New wheelspats
- Handy bedside cabinet with easy-open flush-fit table extension

#### Pictured:

- ▲ The kitchen, which is located at the rear of the Stellar, features a cleverly designed locker layout that offers loads of storage as well as ample work surfaces and a large free floor area - a perfect example of Lunar design know-how.
- Stellar's wider body ensures a remarkably spacious interior that promises luxurious touring for two.

# Quasar

Quasar's emphasis on delivering more features, more value, more luxury and LESS weight has proved to be an outstanding success for Lunar's design team.

With an attractive price tag, the Quasar also offers numerous quality features that are normally associated with premium model ranges. You'll be impressed by the restyled natural wood framed locker doors which are complemented by a big 97 litre fridge and fitted Microwave, a Radio/CD, a multi-directional TV aerial and an AKS Stabiliser.

One of the keys to the Quasar's success has been the sheer variety of layouts on offer. Models range from 2 berth right up to 6 berths, single to twin axle, each one boasting the impressive lightness that puts every Lunar out in front.





#### Fresh Quasar features for 2007

- Easy-clean loose fit carpets.
- Status 530 multi-directional TV aerial.
- New roof locker door design.
- New high quality furniture handles.
- New sink giving a larger work surface.
- Handy reversible chopping board/drainer.
- Special Wok-friendly burner.
- Fitted CD/Radio with two speakers.
- Fitted Microwave oven.
- Attractive new front panel and window design.
- Support struts for gas locker door.
- Colour keyed grab handles.
- Stylish new graphics.
- New look redesigned rear panel and light clusters.
- New high level brake light.
- New larger capacity Thetford fridge.
- New ceiling finish.
- New wheelspats.
- Handy bedside cabinet with easy-open flush-fit table extension.

#### Pictured:

- The Quasar FB is the perfect antidote to touring with children. This spacious model combines comfy twin kids' bunks with their own 'private' seating area - a real winner amongst the most seasoned touring youngsters!
- Throughout the extensive Quasar range, the smart new fabrics, clean lines and light tone of the woodwork combine to create a welcoming modern, airy interior.



# Lexon

Wider than most other caravans, the Lexon has developed into a range of unique layouts that fully maximise the additional space.

The combination of 'Kirsch' cherry coloured woodwork, co-ordinated laminates and chunky work surfaces add a friendly warmth to Lexon models, giving them an extra-special appeal that welcomes you home. There are a host of other new features this season to further enhance the ever-popular Lexon range.

The Lexon EB remains a firm favourite among the fixed bed models, as does the twin-axled Lexon EW. However, the ultimate in spacious touring luxury has to be the Lexon 640 with its large walk around bed that gives a comforting sense of permanence.

For those couples who prefer the luxurious comfort of their own fixed beds, Lunar are pleased to introduce the Lexon SB. The SB has a large single plus an extra large super-length single, a spacious washroom and ample shower at the rear, whilst still boasting a large, extremely comfortable lounge area.





### Fresh Lexon features for 2007

- Easy-clean loose fit carpets.
- Status 530 multi-directional TV aerial.
- New roof locker door design.
- New high quality furniture handles.
- New sink giving a larger work surface.
- Handy reversible chopping board/drainage.
- Special Wok-friendly burner.
- Alarm fitted as standard.
- New internal mains lights.
- Fitted CD/Radio with two speakers.
- Fitted Microwave oven.
- Attractive new front panel and window design.
- Support struts for gas locker door.
- Colour keyed grab handles.
- Stylish new graphics.
- New look redesigned rear panel and light clusters.
- New high level brake light.
- New ceiling finish.
- New wheelspats.
- Handy bedside cabinet with easy-open flush-fit table extension.



### Pictured:

- A** The wider body that is a key feature of Lunar's respected Lexon range creates ample space that is combined with a high specification and top quality fittings, fabrics and woodwork to offer touring at its luxurious best.
- B** New for 2007, the Lexon SB offers an inviting combination of 2 large fixed single beds and a spacious rear washroom.
- C** The flagship Lexon 640 boasts a large, inviting walk-round bed with separate shower and toilet.

# Clubman

The special combination of superb quality, style and traditional appeal has ensured that the Clubman has built a long and enviable reputation amongst caravanners.

The Clubman's finely styled, craftsman made wood framed locker doors help make the 2007 model stand out as particularly special, whilst it retains all those great features that have established this caravan as a touring classic.

The 2007 Clubman is better than ever with yet more improvements on the classic formula. Special features include an easily cleaned parquet-style cushioned floor with removable carpets, a new eye catching exterior that's enhanced by sleek tinted front windows and the added peace of mind of a quality alarm system - now fitted as standard.







**Fresh Clubman features for 2007**

- Easy-clean loose fit carpets.
- New sink giving a larger work surface.
- Handy reversible chopping board/drain.
- Glass lid over sink.
- Special Wok-friendly burner.
- Alarm fitted as standard.
- New internal mains lights.
- DVD player connections.
- New front window design.
- Stylish new graphics.
- New high level brake light.
- New ceiling finish.
- New wheelspats.
- Handy bedside cabinet with easy-open flush-fit table extension.

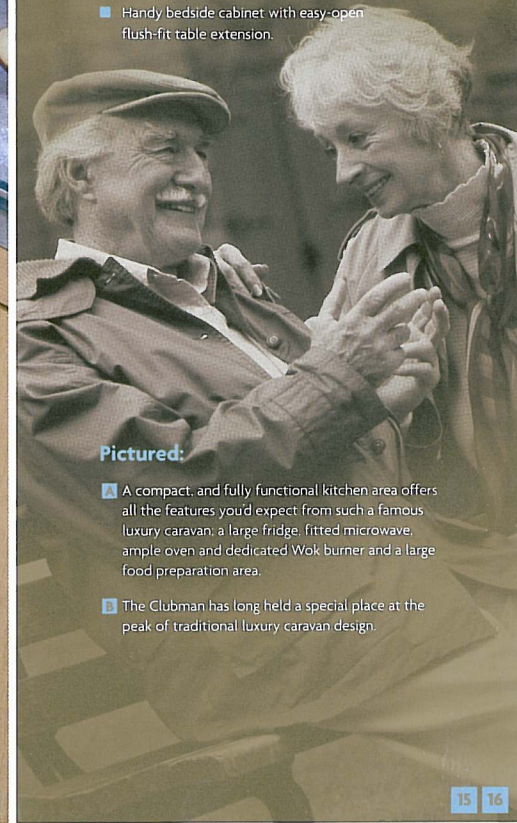

**Pictured:**

- ▲ A compact, and fully functional kitchen area offers all the features you'd expect from such a famous luxury caravan: a large fridge fitted microwave, ample oven and dedicated Wok burner and a large food preparation area.
- The Clubman has long held a special place at the peak of traditional luxury caravan design.

# Delta

An undoubted design classic, the Delta represents the peak of modern luxury caravan styling. The discreet graphics, eye catching tinted front windows and stylish light clusters are combined with the fresh 'Kirsch' cherry coloured woodwork and matching laminate and luxury fittings to create a truly exclusive caravan.

The elegant curves of the furniture draw the eye past the spacious work surfaces and increased storage to alight on pleasing and practical details; the large 95 litre fridge; the fitted microwave oven, the cutting-edge sound system with CD, radio and MP3 playing functions through to the connections for your DVD player. The unique single axle Delta also has a tasteful kitchen layout with oodles of storage space, whilst an easy sliding door takes you into the huge rear washroom.

With such a desirable model you'll be concerned about security too - the Delta is fitted with a quality alarm system so you can relax with real peace of mind.





#### Fresh Delta features for 2007

- Easy-clean loose fit carpets
- New sink giving a larger work surface.
- Handy reversible chopping board / drainer.
- Glass lid over sink.
- Special Wok-friendly burner.
- Alarm fitted as standard.
- New internal mains lights.
- DVD player connections.
- New front window design.
- Stylish new graphics.
- New high level brake light.
- New ceiling finish.
- New wheelspats.
- Handy bedside cabinet with easy-open flush-fit table extension.

#### Pictured:

▲ The Delta is indisputably Lunar's flagship model. From the elegant handmade wood framed locker doors, to the superb comfortable seating, this caravan simply oozes quality, style and comfort.

■ The cook's kitchen is a key feature of the Delta. Created especially for those who enjoy cooking up a sumptuous holiday dinner, it combines masses of storage with a large high quality fridge, a re-designed sink with toughened glass cover and substantial chunky work surfaces, plus a large oven and hob featuring the new Wok-friendly burner.

## Thoughtful features that make every Lunar special.

Tangible quality, design know-how and sheer class, makes EVERY Lunar caravan something special.

Thoughtful attention to detail is at the core of the Lunar ideal.. Notice the quality of the doors, the finish inside the cabinets, the lighting and the integrated styling of the roof lockers with their matching handles.

This season sees Lunar add a host of extra features to compliment the range's already famous specification, making the 2007 models an unbeatable combination of great looks, impressive specifications and genuine value for money.

- A** The new mains corner lights featured in the 2007 Ariva, Stellar, Lexon, Clubman and Delta models have an elegant charm that is designed to compliment the stylish curved locker doors.
- B** Awning light with integral spotlight - an attractively designed and practical feature that's fitted to Clubman and Delta.
- C** The easily accessed spare wheel carrier is a practical feature that is now standard on ALL single axle Lunar models (except Ariva).
- D** High level spoiler mounted brake light, an important safety feature.
- E** Right across the Lunar ranges luxury and quality is fitted as standard!
- F** With volume storage at a premium, Lunar's underbed areas can not only be accessed from the drop front, but also directly through the top simply by sliding back the bed slats (except Zenith and Solaris).
- G** A multi-directional Status TV aerial is fitted as standard to models (excluding Zenith).
- H** Easy-slide drawers with rugged, high quality runners feature on every Lunar.
- I** Smart new rear panels, with attractive redesigned light arrays and co-ordinated graphics and fitting are a keynote feature.
- J** 2007 sees the introduction of stylish new furniture handles with matching wood insets.
- K** Lunar caravans feature big fridges from Dometic and Thetford.
- L** The Quasar FB's attractive, spacious washroom typifies the luxury Lunar approach.
- M** Every 2007 model (excluding Ariva and Zenith) features a handy external mains socket and gas barbecue point.
- N** Pressure balanced gas locker struts save you wrestling with the door on those stormy nights when the gas always seems to run out! (except Solaris)
- O** The extendible radio aerial that helps keep reception crystal clear (except Zenith).
- P** The quality's in the detail; rugged hinges and other fittings are a feature in every Lunar.
- Q** The tilt and slide sunroof is a popular feature across Lunar's ranges.
- R** The receiver is fitted as standard to all alloy wheeled models in readiness for an Al-Ko Secure wheel lock (not supplied).
- S** The powerful 3 speed, 2 way roof extractor that's fitted to every model (excluding Ariva and Zenith).

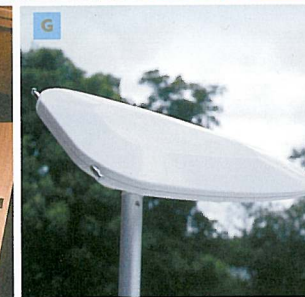

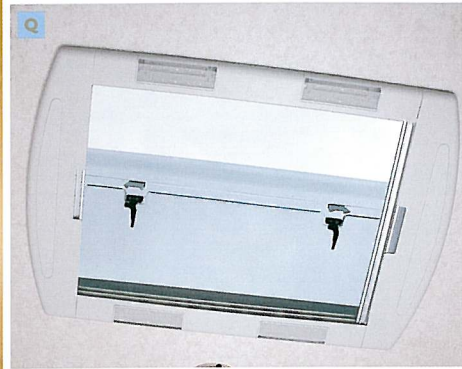
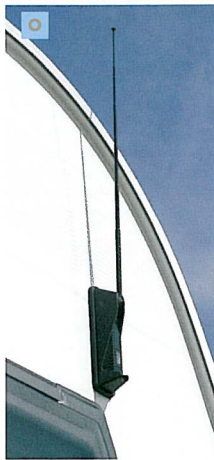

# Weightlessness

Lunars are of course best known for their weight... or rather LACK of it. In all the years we've led the way there has been no serious competition to our weight advantage from the ordinary caravan manufacturers.

How do we do it?... Well to the casual observer, apart from our obvious quality, there might seem little difference between a Lunar and the others... It's what lies beneath that makes the difference, we utilise only the lightest, strongest materials and pay meticulous attention to the smallest details.

As an example, check out the 'wooden' shaped profiles on an ordinary caravan - the same? Our's is the REAL THING; not the heavy wood effect MDF that most caravan manufacturers use; but special, expensive imported Obeche hardwood that's up to THIRTY PERCENT LIGHTER.

The story doesn't end there, Lunar has honed weights throughout our 35 years of caravan building. It's a skill which today is second nature in our construction processes... shaving a few millimetres here and there within the framed furniture, selecting lightweight Poplar ply instead of the cheaper, heavier alternatives.

Lightweight yes - and WITHOUT compromising on strength, quality, durability practicality OR great looks.

**Below:**  
The Obeche hardwood moulding that is used in every Lunar giving substantial weight savings over the heavier alternatives used by most manufacturers.

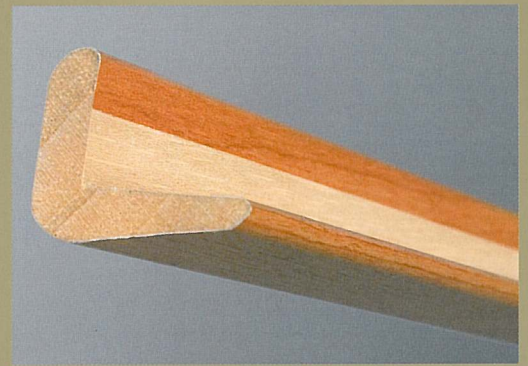

# The 2007 Lunar ranges

Model range	Zenith	Ariva	Solaris	Stellar	Quasar	Lexon	Clubman	Delta
<b>Special features</b>								
Clear rooflight in washroom and over fixed beds	●	●	●	●	●	●	●	●
Lunar entrance tray and doormat	●	●	●	●	●	●	●	●
Smoke alarm	●	●	●	●	●	●	●	●
One key number fits all locks	●	●	●	●	●	●	●	●
Low-level night time courtesy light	-	-	-	-	-	-	●	●
Quality Radio/CD/DVD audio/MP3 player with two speakers	-	-	-	-	-	-	●	●
Quality Radio/CD with two speakers	-	●	●	●	●	●	-	-
Fully adjustable and directional Status 530 TV aerial	-	●	●	●	●	●	●	●
Tilt and slide sunroof to lounge	●	●	●	●	●	●	●	●
CRIS identity etched onto windows	●	●	●	●	●	●	●	●
Hidden unique identity tag	●	●	●	●	●	●	●	●
Receiver for Al-Ko Secure	-	-	●	●	●	●	●	●
<b>Exterior</b>								
New exterior colours and graphics	●	●	●	●	●	●	●	●
Stylish GRP front panel with specially designed flush fit windows	-	-	●	-	-	-	●	●
Acrylic capped ABS front panel	●	●	-	●	●	●	-	-
Stylish new one piece rear panel featuring high level brake light	-	-	●	●	●	●	●	●
Stylish wraparound rear light clusters	●	●	●	●	●	●	●	●
Double glazed windows fitted with blinds and flyscreens throughout	●	●	●	●	●	●	●	●
Fully adjustable window stays with night latch ventilation position	●	●	●	●	●	●	●	●
Two part exterior door including flyscreen	●	●	●	●	●	●	●	●
Exterior door storage pocket	-	●	●	●	●	●	●	●
Al-Ko galvanised steel chassis with one action easy handbrake	●	●	●	●	●	●	●	●
AKS 3004 stabiliser	-	-	●	-	●	●	●	●
Separate entrance step	●	●	●	●	●	●	●	●
External battery locker	●	●	●	●	●	●	●	●
External near side locker compartment	-	-	-	-	●	●	●	●
14" Alloy wheels	-	-	●	●	●	●	●	●

Key: ● Fitted as STANDARD - NOT fitted to this range

Model range	Zenith	Ariva	Solaris	Stellar	Quasar	Lexon	Clubman	Delta
<b>Exterior continued</b>								
Underfloor spare wheel carrier (excluding twin axle models)	●	-	●	●	●	●	●	●
Stylish wheel trims	●	●	-	-	-	-	-	-
Shaped side and rear windows	●	●	●	●	●	●	●	●
High gloss aluminium	●	●	●	●	●	●	●	●
Pressurised water system with semi-rigid piping	●	●	●	●	●	●	●	●
Mud flaps	-	-	●	●	●	●	●	●
Fully insulated walls, floor and ceiling to grade II classification	●	●	●	●	●	●	●	●
<b>Plumbing and electrical</b>								
Truma gas and electric flued room heater with ducted blown air	●	●	●	●	●	●	●	●
Truma gas and electric flued water heater, fully plumbed in	●	●	●	●	●	●	●	●
Isolation taps for all gas appliances	●	●	●	●	●	●	●	●
Awning light ('S' with additional spotlight)	●	●	●	●	●	●	●S	●S
Colour co-ordinated main sockets (minimum of 2)	●	●	●	●	●	●	●	●
25 metre mains connection lead	●	●	●	●	●	●	●	●
230v mains reading lights	●	●	●	●	●	●	●	●
Adjustable 12v spot reading lights	●	●	●	●	●	●	●	●
External mains socket	-	-	●	●	●	●	●	●
External barbecue point	-	-	●	●	●	●	●	●
12v charger/mains transformer	●	●	●	●	●	●	●	●
Mains inlet with ELCB protection	●	●	●	●	●	●	●	●
On-board 65 litre water tank	-	-	-	-	-	-	-	●
<b>Furniture</b>								
Natural wood framed roof locker doors	-	●	●	●	●	●	●	●
Shaped 2 drawer chest with pull-out coffee table	●	●	●	●	●	●	●	●
Split front bed seats for easy bed make up	●	●	-	●	●	●	●	●
Roll-out slats for double bed make-up	●	●	●	●	●	●	●	●
Scatter cushions (S) and bolster cushions (B)	2B	2S/2B	2S/2B	2S/4B	2S/4B	2S/4B	2S/4B	2S/4B

Model range	Zenith	Ariva	Solaris	Stellar	Quasar	Lexon	Clubman	Delta
<b>Furniture continued</b>								
Bed ventilation boards to improve airflow and reduce condensation	–	●	●	●	●	●	●	●
Drop-flap access to front bed box storage	–	●	–	●	●	●	●	●
Slide-to-side bed slats, allowing unobscured storage access	–	●	●	●	●	●	●	●
'Kirsch' cherry furniture board	●	–	–	●	–	●	–	●
Colour matched worktop laminates	●	●	●	●	●	●	●	●
Integrated, curved roof locker designs	●	●	●	●	●	●	●	●
Dedicated table storage locker	●	–	●	●	●	●	●	●
Large freestanding table	●	●	●	●	●	●	●	●
Colour co-ordinated fittings, including ceiling lights, switches etc.	●	●	●	●	●	●	●	●
Long front lounge seats (6'2"/1.88m)	● NOT EB	–	–	●	● NOT EB	●	●	●
<b>Kitchen and bathroom</b>								
3 speed, 2 way extractor/rooflight	–	–	●	●	●	●	●	●
Grill and oven with spark ignition and flame failure device	●	●	●	●	●	●	●	●
3 burner hob, including dedicated Wok burner and flame failure device	●	●	●	●	●	●	●	●
Stainless steel sink with separate draining board	●	–	●	●	●	●	●	●
Easy to use lever action tap	●	–	●	●	●	●	●	●
Halogen downlighters over kitchen	●	●	●	●	●	●	●	●
Easy slide drawer runners	●	●	●	●	●	●	●	●
Fitted eye level microwave oven	–	–	●	–	●	●	●	●
Shower with dedicated controls	–	●	●	●	●	●	●	●
Fitted cassette toilet	●	●	●	●	●	●	●	●
Large window in washroom (selected models)	●	●	●	●	●	●	●	●

#### Important note on specifications and details:

The contents of this brochure are correct at time of going to print, however Lunar Caravans reserve the right to alter materials, specification and prices without prior notification. It should be noted that distributors and dealers are not the agents of Lunar Caravans Limited and are therefore NOT authorised to bind the Company by any specific or implied undertaking or representation. The information and images contained in this brochure are strictly copyright ©2006 Lunar Caravans and may not be reproduced in any way without express permission.

\* **Furnishing and layout options:** It should be noted that the furnishing and 'L' format options are subject to availability and sufficient advanced notice. Ask your local Lunar dealer who will be able to provide full details on this option.

## Peace-of-mind warranty

Lunars are famously well built and reliable, but for total peace of mind EVERY Lunar caravan receives a full factory-backed THREE year warranty (subject to an annual service and inspection and excluding items subject to normal wear and tear).

Each Lunar model has been certified by the NATIONAL CARAVAN COUNCIL for compliance with stringent European Standards, British Standards AND the industry set Codes of Practice that specifically relate to health and safety issues.

The approvals process covers the testing and inspection of all critical areas of the product from fire safety, weights and dimensions through to gas, electrics and ventilation. In order to ensure continuing compliance with their stringent standards, the NCC also carry out unannounced spot inspections at the factory.

Every caravan carries the 'NCC Approved Caravan' badge that gives you the peace of mind knowledge that your caravan's both fully legal AND safe.

Touring caravans are designated by the model year which runs from 1 September to 31 August. The despatch of 2007 models commences on 1 September 2006.



NATIONAL CARAVAN  
COUNCIL LIMITED

## Soft furnishing options\*

Lunar have carefully selected the standard soft furnishings for each model range. However for a small additional fee you may choose any soft furnishing combination from the 2007 range for your caravan.

## Estimated weights

At the time of going to print some Lunar models have not yet been weighed. As a result some weights are estimated and may be subject to revision, your dealer will be notified of the exact figures as soon as possible.

## MRO - important information

The stated Mass in Running Order, 'MRO', includes a manufacturer's tolerance that reflects the varying individual weights of component parts. It is anticipated that the stated figure will NEVER be exceeded in the standard ex-works specification.

## Lunar layout options\*

In addition to the numerous layouts available across Lunar's eight model ranges, an 'L' front layout is available to order (excluding Ariva, Zenith, Solaris and the Quasar EB).

Selection of the 'L' front layout option gives a long offside picture window and a floor cabinet, plus a 2.01 x 1.23m (6'7" x 4'0") front double bed.

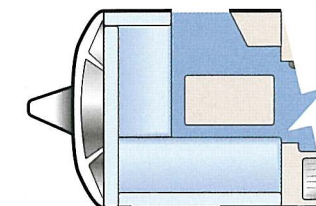

# Detailed specifications 2007

## Ariva 2 berth

Ariva	
Internal body length	3.63m/11'11"
Overall length	5.17m/16'11"
Internal body width	1.90m/6'3"
Overall width	2.02m/6'7"
Maximum internal height	1.90m/6'3"
Overall height	2.60m/8'7"
Tyre size	185 R14
Coupling height	440mm/17"
Mass in running order	800 kg
Total user payload	200 kg
MTPLM	1000kg
Bed sizes	Double 1.90m x 1.43m 6'3" x 4'8"
	or 2 x Single 1.83m x 0.66m 6'0" x 2'2"
Awning guide [check with supplier]	790cm

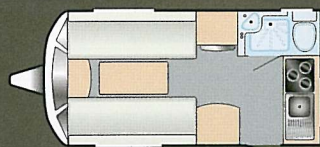

Ariva (2 berth)

## Stellar 2 berth

Stellar	
Internal body length	4.20m/13'9"
Overall length	5.60m/18'4"
Internal body width	2.16m/7'1"
Overall width	2.28m/7'6"
Maximum internal height	1.90m/6'3"
Overall height	2.60m/8'7"
Tyre size	185 R14
Coupling height	440mm/17"
Mass in running order	975 kg
Total user payload	225 kg
MTPLM	1200kg (1300 kg optional)
Bed sizes	Double 2.10m x 1.48m 6'11" x 4'10"
	or 2 x Single 1.88m x 0.74m 6'2" x 2'5"
Awning guide [check with supplier]	840cm

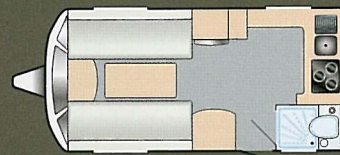

Stellar (2 berth)

## Solaris 4 berth

	Solaris 1	Solaris 2 Twin Axle	Solaris 3
Internal body length	5.80m/19'0"	6.44m/21'1"	5.80m/19'0"
Overall length	7.26m/23'10"	7.82m/25'8"	7.26m/23'10"
Internal body width	2.16m/7'1"	2.16m/7'1"	2.16m/7'1"
Overall width	2.28m/7'6"	2.28m/7'6"	2.28m/7'6"
Maximum internal height	1.90m/6'3"	1.90m/6'3"	1.90m/6'3"
Overall height	2.60m/8'7"	2.60m/8'7"	2.60m/8'7"
Tyre size	185 R14	175 R14	185 R14
Coupling height	440mm/17"	440mm/17"	440mm/17"
Mass in running order	1210 kg	1325 kg	1210 kg
Total user payload	240 kg	275 kg	240 kg
MTPLM	1450 kg	1600 kg	1450 kg
Front Double Bed	2.10m x 1.53m 6'11" x 5'0"	2.10m x 1.53m 6'11" x 5'0"	2.10m x 1.53m 6'11" x 5'0"
Front Single Beds	1.53m x 0.68m 5'0" x 2'3"	1.53m x 0.68m 5'0" x 2'3"	1.53m x 0.68m 5'0" x 2'3"
	1.86m x 0.68m 6'1" x 2'3"	1.86m x 0.68m 6'1" x 2'3"	1.86m x 0.68m 6'1" x 2'3"
Rear Double Bed	2.00m x 1.45m 6'6" x 4'9"	1.91m x 1.34m 6'3" x 4'5"	1.86m x 1.34m 6'1" x 4'5"
Awning guide	995cm	1055cm	995cm

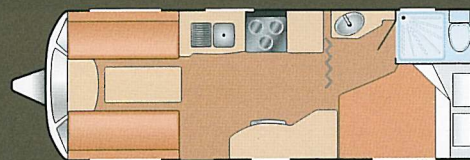

Solaris 1 (4 berth)

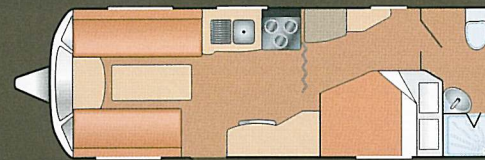

Solaris 2 (4 berth)

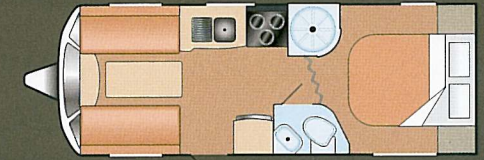

Solaris 3 (4 berth)

Estimated weights: At the time of going to print some Lunar models have not yet been weighed. As a result some weights which are highlighted in RED are estimated and may be subject to revision, your dealer will be notified of the exact figures as soon as possible.



# Quasar 2, 4, 5 and 6 berth

	Quasar 462	Quasar EB	Quasar 524	Quasar 525	Quasar 615 Twin Axle	Quasar FB Twin Axle
Internal body length	4.69m/15'5"	5.23m/17'1"	5.30m/17'5"	5.30m/17'5"	6.13m/20'1"	6.44m/21'1"
Overall length	6.16m/20'2"	6.70m/21'10"	6.82m/22'4"	6.82m/22'4"	7.64m/25'1"	7.82m/25'8"
Internal body width	2.04m/6'8"	2.04m/6'8"	2.04m/6'8"	2.04m/6'8"	2.04m/6'8"	2.04m/6'8"
Overall width	2.16m/7'1"	2.16m/7'1"	2.16m/7'1"	2.16m/7'1"	2.16m/7'1"	2.16m/7'1"
Maximum internal height	1.90m/6'3"	1.90m/6'3"	1.90m/6'3"	1.90m/6'3"	1.90m/6'3"	1.90m/6'3"
Overall height	2.60m/8'7"	2.60m/8'7"	2.60m/8'7"	2.60m/8'7"	2.60m/8'7"	2.60m/8'7"
Tyre size	185 R14	185 R14	185 R14	185 R14	175 R14	175 R14
Coupling height	440mm/17"	440mm/17"	440mm/17"	440mm/17"	440mm/17"	440mm/17"
Mass in running order	1050 kg	1125 kg	1100 kg	1120 kg	1285 kg	1310 kg
Total user payload	200 kg	225 kg	250 kg	230 kg	315 kg	290 kg
MTPLM	1250 kg (1350 kg optional)	1350 kg	1350 kg	1350 kg	1600 kg	1600 kg
Bed sizes	Double	2.01m x 1.48m 6'7" x 4'10"	2.01m x 1.48m 6'7" x 4'10"	2.01m x 1.48m 6'7" x 4'10"	2.01m x 1.48m 6'7" x 4'10"	2.01m x 1.48m 6'7" x 4'10"
	2 x Single	1.88m x 0.69m 6'2" x 2'3"	1.53m x 0.69m 5'0" x 2'3"	1.88m x 0.69m 6'2" x 2'3"	1.88m x 0.69m 6'2" x 2'3"	1.88m x 0.69m 6'2" x 2'3"
Single			1.83m x 0.60m 6'0" x 2'0"		1.83m x 0.74m 6'0" x 2'5"	side single 1.83m x 0.60m side single 6'0" x 2'0"
Side bunk						1.76m x 0.56m 5'10" x 1'10"
Double		1.93m x 1.34m 6'4" x 4'5"		2.01m x 1.29m 6'7" x 4'3"		
Bunk			1.76m x 0.56m 5'10" x 1'10"	1.98m x 0.56m 6'6" x 1'10"	2x 1.83m x 0.64m 2x 6'0" x 2'1"	1.74m x 0.64m 5'8" x 2'1"
Awning guide [check with supplier]	895cm	935cm	945cm	945cm	1030cm	1055cm

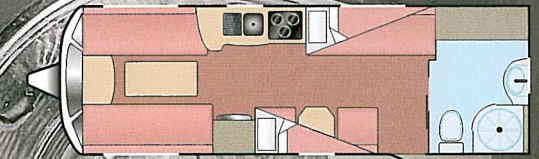
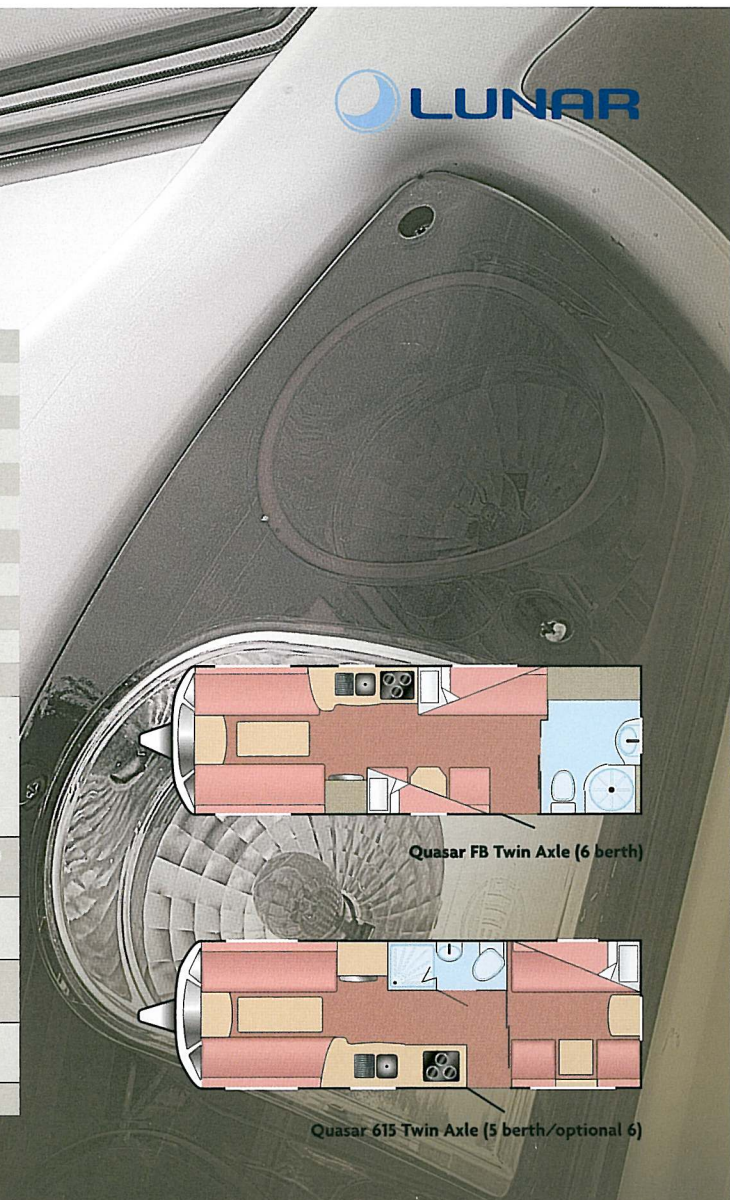

Quasar FB Twin Axle (6 berth)

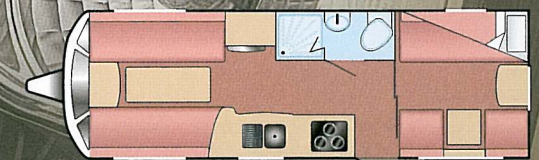

Quasar 615 Twin Axle (5 berth/optional 6)

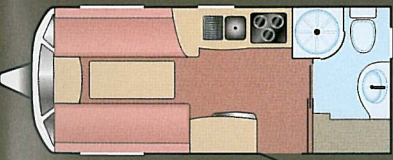

Quasar 462 (2 berth)



Quasar EB (4 berth)

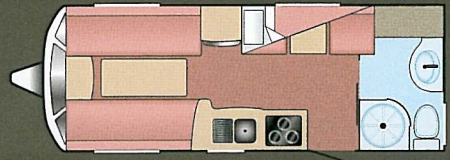

Quasar 524 (4 berth)

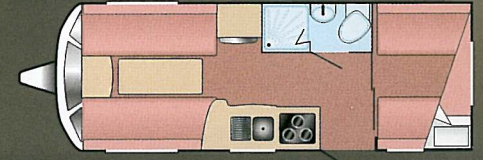

Quasar 525 (5 berth)

# Detailed specifications 2007

## Lexon 4 berth

	Lexon EB	Lexon CS	Lexon EW Twin Axle	Lexon 640 Twin Axle	Lexon SB Twin Axle	
Internal body length	5.56m/18'2"	5.80m/19'0"	6.44m/21'1"	6.44m/21'1"	6.44m/21'1"	
Overall length	7.03m/23'1"	7.26m/23'10"	7.82m/25'8"	7.82m/25'8"	7.82m/25'8"	
Internal body width	2.16m/7'1"	2.16m/7'1"	2.16m/7'1"	2.16m/7'1"	2.16m/7'1"	
Overall width	2.28m/7'6"	2.28m/7'6"	2.28m/7'6"	2.28m/7'6"	2.28m/7'6"	
Maximum internal height	1.90m/6'3"	1.90m/6'3"	1.90m/6'3"	1.90m/6'3"	1.90m/6'3"	
Overall height	2.60m/8'7"	2.60m/8'7"	2.60m/8'7"	2.60m/8'7"	2.60m/8'7"	
Tyre size	185 R14	185 R14	175 R14	175 R14	175 R14	
Coupling height	440mm/17"	440mm/17"	440mm/17"	440mm/17"	440mm/17"	
Mass in running order	1200 kg	1210 kg	1350 kg	1315 kg	1340 kg	
Total user payload	250 kg	240 kg	250 kg	285 kg	260 kg	
MTPLM	1450 kg	1450 kg	1600 kg	1600 kg	1600 kg	
Bed sizes	Double	2.10m x 1.48m 6'11" x 4'10"	2.10m x 1.48m 6'11" x 4'10"	2.10m x 1.48m 6'11" x 4'10"	2.10m x 1.48m 6'11" x 4'10"	2.10m x 1.48m 6'11" x 4'10"
	2 x Single	1.88m x 0.74m 6'2" x 2'5"	1.88m x 0.74m 6'2" x 2'5"	1.88m x 0.74m 6'2" x 2'5"	1.88m x 0.74m 6'2" x 2'5"	1.88m x 0.74m 6'2" x 2'5"
Rear Singles					1x 1.86m x 0.75m 6'1" x 2'5" 1x 2.00m x 0.75m 6'7" x 2'5"	
Double	1.93m x 1.45m 6'4" x 4'9"	1.93m x 1.34m 6'4" x 4'5"	1.89m x 1.37m 6'2" x 4'6"	1.86m x 1.34m 6'1" x 4'5"		
Awning guide [check with supplier]	970cm	995cm	1055cm	1055cm	1055cm	

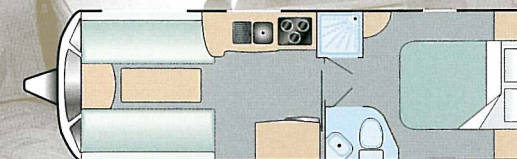
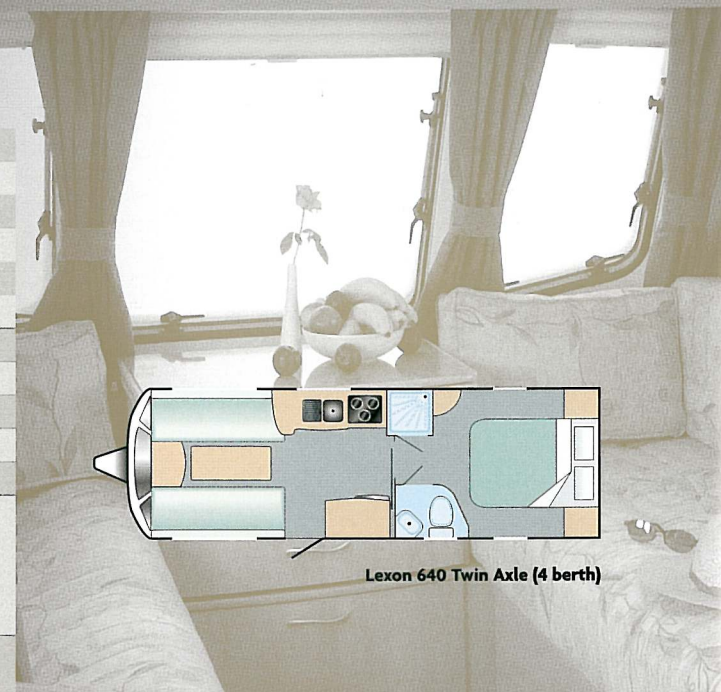

Lexon 640 Twin Axle (4 berth)

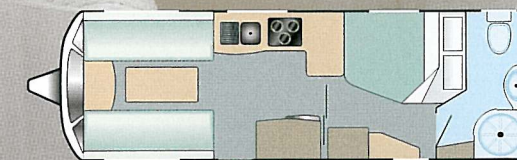

Lexon EW Twin Axle (4 berth)

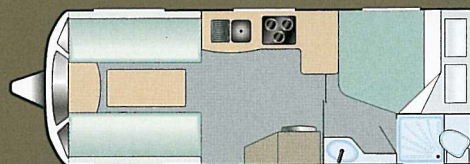

Lexon EB (4 berth)



Lexon CS (4 berth)



Lexon SB (4 berth)

Estimated weights: At the time of going to print some Lunar models have not yet been weighed. As a result some weights which are highlighted in **RED** are estimated and may be subject to revision, your dealer will be notified of the exact figures as soon as possible.

## Zenith 4, 5 and 6 berth

	Zenith Five	Zenith EB	Zenith Six
Internal body length	5.30m/17'5"	5.56m/18'2"	5.79m/19'0"
Overall length	6.82m/22'4"	7.03m/23'1"	7.26m/23'9"
Internal body width	2.04m/6'8"	2.04m/6'8"	2.04m/6'8"
Overall width	2.16m/7'1"	2.16m/7'1"	2.16m/7'1"
Maximum internal height	1.90m/6'3"	1.90m/6'3"	1.90m/6'3"
Overall height	2.56m/8'5"	2.56m/8'5"	2.56m/8'5"
Tyre size	185 R14	185 R14	185 R14
Coupling height	440mm/17"	440mm/17"	440mm/17"
Mass in running order	1030 kg	1090 kg	1080 kg
Total user payload	270 kg	260 kg	270 kg
MTPLM	1300 kg (1350 kg optional)	1350 kg	1350 kg
Bed sizes	Double	2.01m x 1.48m 6'7" x 4'10"	2.01m x 1.48m 6'7" x 4'10"
	or		
2 x Single	1.88m x 0.69m 6'2" x 2'3"	1.53m x 0.69m 5'0" x 2'3"	2.01m x 1.48m 6'7" x 4'10"
	or		
Rear Sgle./Dble	2.01m x 1.29m 6'7" x 4'3"	1.93m x 1.34m 6'4" x 4'5"	2.04m x 0.61m 6'8" x 2'0"
Rear Top Bunk	1.98m x 0.56m 6'6" x 1'10"		2.04m x 0.58m 6'8" x 1'11"
Side Single			1.83m x 0.65m 6'0" x 2'1"
Side Top Bunk			1.76m x 0.57m 5'10" x 1'11"
Awning guide [check with supplier]	950cm	970cm	1000cm

## Clubman 2 berth

	Clubman 475 CK	
Internal body length	4.80m/15'9"	
Overall length	6.25m/20'6"	
Internal body width	2.16m/7'1"	
Overall width	2.28m/7'6"	
Maximum internal height	1.90m/6'3"	
Overall height	2.60m/8'7"	
Tyre size	185 R14	
Coupling height	440mm/17"	
Mass in running order	1090 kg	
Total user payload	260 kg	
MTPLM	1350 kg	
Bed sizes	Double	2.10m x 1.48m 6'11" x 4'10"
	or	
2 x Single	1.88m x 0.74m 6'2" x 2'5"	
	or	
Awning guide [check with supplier]	895cm	

## Delta 2 berth

	Delta 540-2	
Internal body length	5.52m/18'11"	
Overall length	6.90m/22'8"	
Internal body width	2.16m/7'1"	
Overall width	2.28m/7'6"	
Maximum internal height	1.90m/6'3"	
Overall height	2.60m/8'7"	
Tyre size	185 R14	
Coupling height	440mm/17"	
Mass in running order	1215 kg	
Total user payload	285 kg	
MTPLM	1500 kg	
Bed sizes	Double	2.10m x 1.48m 6'11" x 4'10"
	or	
2 x Single	1.88m x 0.74m 6'2" x 2'5"	
	or	
Awning guide [check with supplier]	960cm	

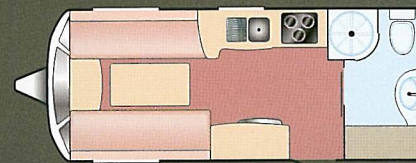

Clubman 475-CK (2 berth)

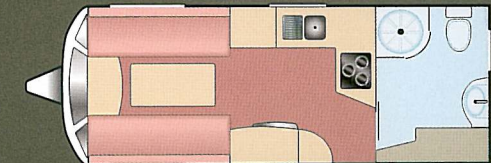

Delta 540-2 (2 berth)

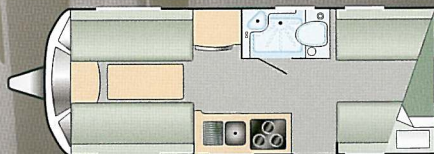

Zenith Five (5 berth)



Zenith EB (4 berth)

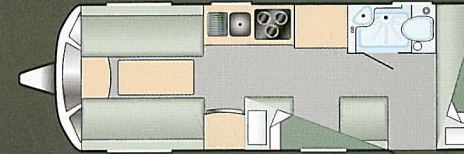

Zenith 6 (6 berth)

## The Lunar Owner's Club

When you choose Lunar you have a great, exclusive opportunity to join the growing band of enthusiasts that enjoy all the special benefits of being a Lunar Owner's Club member.

As a club member you will receive regular information-packed newsletters with all the latest news on forthcoming events, letters from fellow members and the inside track on the new developments from Lunar Caravans themselves.

Every member is welcome at the Club's numerous exclusive rallies across the UK, you'll meet a host of new friends who share a common interest in enjoying caravanning in a Lunar. These seasoned veterans can also offer a wealth of knowledge and expertise to help you enjoy lightweight touring at its VERY BEST.



Sherdley Road Linstock Hall Preston Lancashire PR5 5JF.  
Tel 01772 337628 Fax 01772 627722

[www.lunarcaravans.com](http://www.lunarcaravans.com)

Authorised Lunar dealer:

Updated information (see notes on page 21):