



TC2002/06/11

All models are covered by a six-year bodyshell integrity guarantee and come with a three-year SuperSure manufacturer's warranty - see www.swiftcaravans.co.uk
 For more details and more model pictures, the gallery is constantly updated as more models are available.



Swift Caravans · Dunswell Road · Cottingham · East Yorkshire HU16 4JX
 Tel: 01482 847332 Fax: 01482 841042 email: enquiry@swiftgroup.co.uk

A member of the Swift Group

For more information and to find your nearest retailer visit us at [» www.swiftcaravans.co.uk](http://www.swiftcaravans.co.uk)



This brochure does not constitute an offer by Swift Group Limited (Swift). Swift reserves the right to alter specifications and prices at any time as materials and conditions demand. Distributors and dealers sell Swift products on their own account and not as agents of Swift. Accordingly, they have no authority to bind Swift or to make any representation or undertaking whatsoever on behalf of Swift. All props are for photographic purposes only and are not included in the specification. Issued August 2011

Challenger Sport

www.challengersport.co.uk

Panoramic sunroof (optional)



The New Challenger **Sport**

Swift wants you to have it all with new modern styling and cutting edge interiors.

Whether you want to kick back and relax or explore the great outdoors, the Challenger Sport comes with a choice of eight models including a twin-axle so there is sure to be a layout to suit you.

High specification and careful consideration of weight puts these exciting new models within the range of most average family cars. Combined with its aerodynamic profile this all adds up to better fuel efficiency.



Standard exterior

The exteriors have clean sweeping modern lines with the option of a panoramic front sunroof which gives great views out.

Comfortable and relaxed, professional designers have carefully co-ordinated the interiors with new 'Mali Acacia' wood grain offering richer colouring with a defined wood grain texture and neutral fabrics with a contemporary floral pattern. A stylish front panel incorporates lighting and speakers.

Low energy LED lights in the main habitation area >>



4 x 230V sockets to cater for modern needs, including two in the neat and convenient front shelf pod >>





Positive locker catches for secure storage whilst on the move

A choice of flexible seating and sleeping arrangements combined with well equipped kitchens and washrooms.

Ventilated microwave oven with digital controls built in at an easily accessible level >>



<< Dual fuel hob with 800W electric hotplate and 3 gas burners combined with separate grill and glass-fronted oven

Separate cutlery draw and two wire storage baskets with positive locks >>



<< High capacity inboard pump ensures good water pressure

Stylish and practical granite effect sink with removable drainer >>

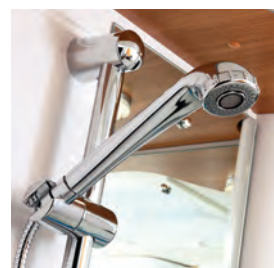
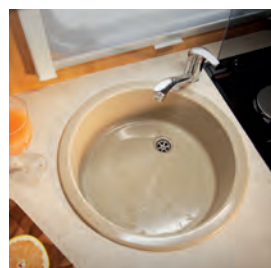

<< Separate shower mixers with adjustable head positions





^^ New chest of drawers design makes it easy to create a small table without disturbing items on top



^^ New bed make-up system with slats retained on track



^^ Seat bases with spaceframe construction, full front access and space for larger items



^^ Large dining table (960mm x 600mm) for full-size place settings



^^ Concealed low energy lighting over the lockers in the seating and bedroom areas



^^ AL-KO ATC trailer control system as standard

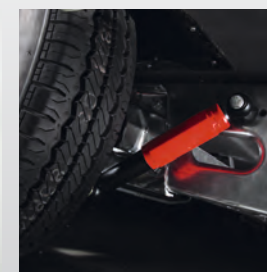

^^ Shock absorbers for a smoother towing experience



^^ Hankook tyres with a minimum of 150kg extra load margin for improved performance and safety



^^ Step on hitch cover for easy cleaning of front windows



^^ Gas regulator with stainless steel braided hose for improved reliability

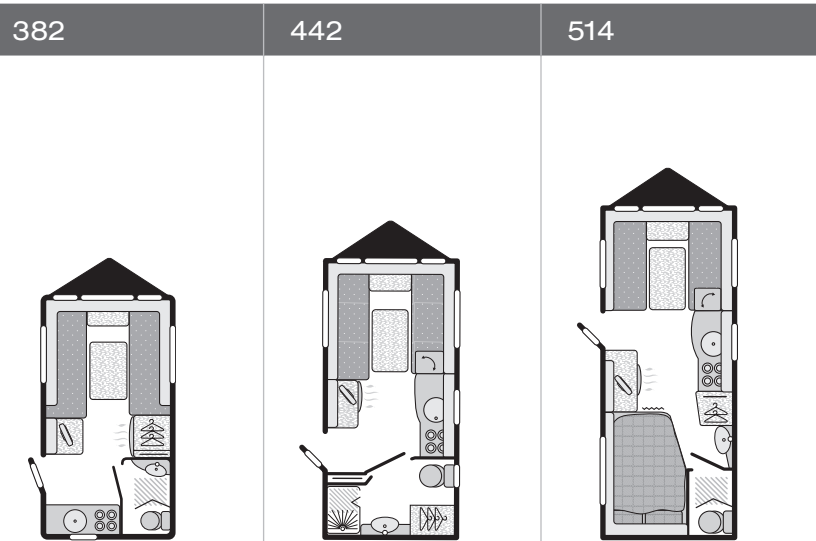

	382	442	514
Berths	2	2	4
Number of Axles	1	1	1
Internal Length (at bed box height)	3.72m / 12' 2"	4.40m / 14' 5"	5.23m / 17' 2"
Overall Width	2.25m / 7' 5"	2.25m / 7' 5"	2.25m / 7' 5"
Overall Height (inc. TV Aerial)	2.64m / 8' 8"	2.64m / 8' 8"	2.65m / 8' 8"
Maximum Internal Headroom	1.95m / 6' 5"	1.95m / 6' 5"	1.95m / 6' 5"
Overall Length	5.37m / 17' 7"	6.06m / 19' 11"	6.88m / 22' 7"
Awning A/A Dimension	8.11m / 26' 7"	8.79m / 28' 10"	9.62m / 31' 7"
Mass in Running Order (inc. tolerance)	1028kg / 20.2cwt	1114kg / 21.9cwt	1230kg / 24.2cwt
Maximum Technical Permissible Laden Mass	1143kg / 22.5cwt	1235kg / 24.3cwt	1380kg / 27.2cwt
Total User Payload	115kg / 2.3cwt	121kg / 2.4cwt	150kg / 3.0cwt
Personal Effects Payload	115kg / 2.3cwt	121kg / 2.4cwt	150kg / 3.0cwt
Tyre Size	175 R14C 99 Q	175 R14C 99 Q	185 R14C 102 Q
Thermal Insulation Grade	THREE	THREE	THREE
Front Double	208cm x 180cm / 6'10" x 5'11"	208cm x 180cm/6'10" x 5'11"	208cm x 159cm / 6'10" x 5'3"
Or Front Nearside Single	190cm x 72cm / 6'3" x 2'4"	190cm x 72cm / 6'3" x 2'4"	
And Front Offside Single	180cm x 72cm / 5'11" x 2'4"	180cm x 72cm / 5'11" x 2'4"	
Rear Double			196cm x 131cm / 6'5" x 4'4"
Side Single Offside			
Side Single Nearside			
Side Bunk Nearside			
Side Bunk Offside			
Side Fixed Lower Bunk			
Side Fixed Mid Bunk			
Side Fixed Upper Bunk			

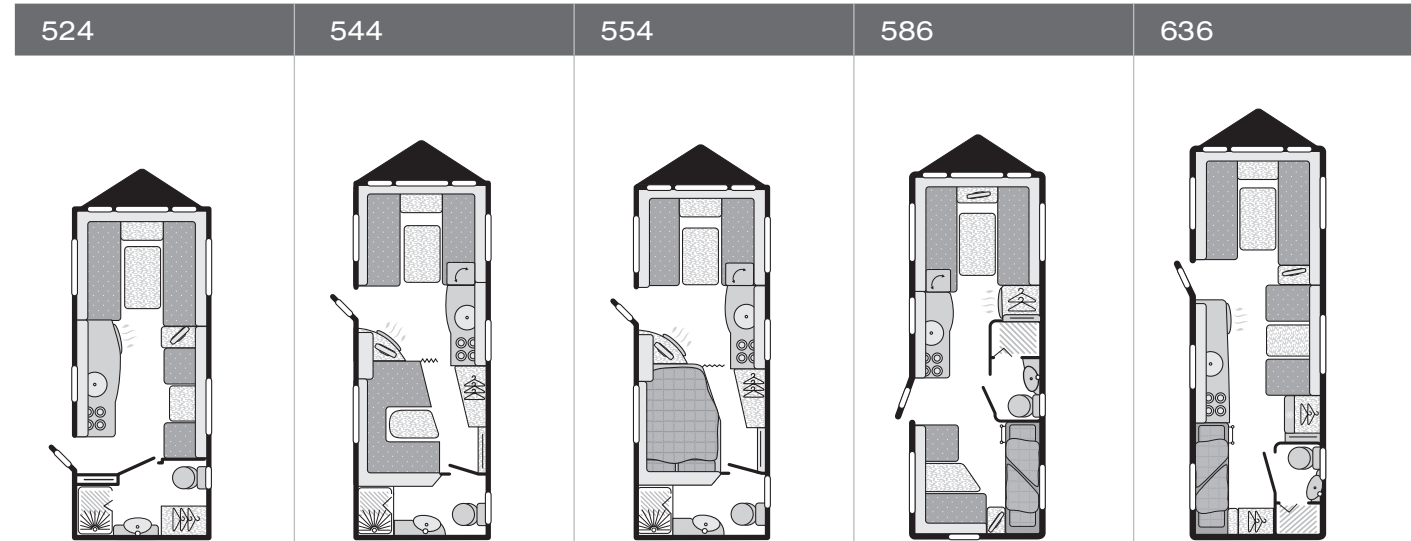

	524	544	554	586	636
Berths	4	4	4	6	6
Number of Axles	1	1	1	1	2
Internal Length (at bed box height)	5.29m / 17' 4"	5.60m / 18' 4"	5.60m / 18' 4"	5.83m / 19' 2"	6.27m / 20' 7"
Overall Width	2.25m / 7' 5"	2.25m / 7' 5"	2.25m / 7' 5"	2.25m / 7' 5"	2.25m / 7' 5"
Overall Height (inc. TV Aerial)	2.65m / 8' 8"	2.65m / 8' 8"	2.65m / 8' 8"	2.65m / 8' 8"	2.62m / 8' 7"
Maximum Internal Headroom	1.95m / 6' 5"	1.95m / 6' 5"	1.95m / 6' 5"	1.95m / 6' 5"	1.95m / 6' 5"
Overall Length	6.94m / 22' 9"	7.25m / 23' 9"	7.25m / 23' 9"	7.48m / 24' 6"	7.93m / 26' 0"
Awning A/A Dimension	9.68m / 31' 9"	9.99m / 32' 9"	9.99m / 32' 9"	10.22m / 33' 6"	10.66m / 35' 0"
Mass in Running Order (inc. tolerance)	1255kg / 24.7cwt	1282kg / 25.2cwt	1277kg / 25.1cwt	1371kg / 27.0cwt	1470kg / 28.9cwt
Maximum Technical Permissible Laden Mass	1405kg / 27.7cwt	1435kg / 28.2cwt	1430kg / 28.1cwt	1547kg / 30.5cwt	1650kg / 32.5cwt
Total User Payload	150kg / 3.0cwt	153kg / 3.0cwt	153kg / 3.0cwt	176kg / 3.5cwt	180kg / 3.5cwt
Personal Effects Payload	150kg / 3.0cwt	153kg / 3.0cwt	153kg / 3.0cwt	176kg / 3.5cwt	180kg / 3.5cwt
Tyre Size	185 R14C 102 Q	185 R14C 102 Q	185 R14C 102 Q	195/70 R15C 104 R	175/65 R14 86 T
Thermal Insulation Grade	THREE	THREE	THREE	THREE	THREE
Front Double	208cm x 180cm / 6'10" x 5'11"	208cm x 159cm / 6'10" x 5'3"	208cm x 159cm / 6'10" x 5'3"	208cm x 180cm / 6'10" x 5'11"	208cm x 180cm / 6'10" x 5'11"
Or Front Nearside Single	180cm x 72cm / 5'11" x 2'4"			190cm x 72cm / 6'3" x 2'4"	180cm x 72cm / 5'11" x 2'4"
And Front Offside Single	190cm x 72cm / 6'3" x 2'4"			180cm x 72cm / 5'11" x 2'4"	190cm x 72cm / 6'3" x 2'4"
Rear Double		194cm x 132cm / 6'4" x 4'4"	189cm x 133cm / 6'2" x 4'4"		
Side Single Offside	180cm x 62cm / 5'11" x 2'0"				
Side Single Nearside				180cm x 67cm / 5'11" x 2'2"	180cm x 92cm / 5'11" x 3'0"
Side Bunk Nearside				176cm x 59cm / 5'9" x 1'11"	
Side Bunk Offside	176cm x 59 / 5'9" x 1'11"				
Side Fixed Lower Bunk				182cm x 57cm / 6'0" x 1'10"	183cm x 56cm / 6'0" x 1'10"
Side Fixed Mid Bunk					183cm x 57cm / 6'0" x 1'10"
Side Fixed Upper Bunk				182cm x 57cm / 6'0" x 1'10"	183cm x 56cm / 6'0" x 1'10"

You can be reassured when you buy a Swift Caravan that they all come with the following market leading features

Swift Plus Points

- > European Whole Vehicle Type Approval ensures compliance with strict weight, dimension and safety regulations
- > EN1645 Grade 3 classification for heating and thermal insulation (Cold chamber tested)
- > 1.95m (6'5") headroom
- > One-piece, 5000 Series marine grade aluminium sidewalls
- > Strong redwood body and floor framing specially treated to resist moisture and fungal attack
- > Hankook branded tyres for improved performance and safety
- > Higher tyre rating - a minimum of 150kg extra load margin at 130kph (law permitting)
- > Shock absorbers for a smoother towing experience
- > Step-on hitch cover for easy cleaning of the front windows
- > Gas regulator fitted with stainless steel braided hose for improved reliability
- > High security entrance lock for peace of mind
- > Aerial point in battery box for portable satellite dish connection
- > TV station with 230V, 12V and aerial sockets (two in 586 model)
- > New bed make-up system with slats retained on track
- > Seat bases with spaceframe construction, full front access and space for larger items
- > Areas under beds and seats warmed by blown air system and underfloor ducting insulated to minimise heat loss
- > Front chest of drawers with convenient slide-out extending top
- > Large dining table (960mm x 600mm) for full-size place settings
- > Positive overhead locker catches for secure storage whilst on the move
- > Dual fuel hob with 800W electric hotplate and 3 gas burners with electronic ignition
- > Ventilated microwave oven with digital controls built in at an easily accessible level
- > New dual fuel Truma Ultrastore water heater, now with two 230V settings - 850W or 1300W for rapid heat-up
- > High flow rate in-board pump with chrome finish brass taps for reliable, high performance water supply
- > Separate shower mixers with adjustable head positions
- > High impact, scratch resistant floor lino
- > Large capacity (15 litre) waste bin on lower door
- > Solar panel connection provision

Additional features

- Exterior**
- > Aerodynamic front in closed-mould GRP with wide front door
 - > Full height moulded rear panel
 - > Fully bonded roof for extra strength and flatness
 - > Semi-recessed body colour awning rail both sides
 - > Overall body width 2.25m/7'4½"
 - > AL-KO galvanised steel chassis with Euro-axle
 - > AL-KO Euro overrun device with two-way assisted handbrake
 - > Exclusive 'Storm' alloy wheels
 - > Steel spare wheel and carrier
 - > 13-pin 'Jaeger' 12V car connector
 - > Status 530 directional digital and analogue TV aerial
 - > Fully double-glazed opening windows (no single-glazed cold areas)
 - > LED awning light
 - > Exterior two-part door with interior moulded liner, window and blind
 - > Exterior access battery box with mains electric inlet (battery not included)
 - > Entrance step
- Interior**
- > Granite effect kitchen sink with removable extension drainer
 - > Kitchen worktop extensions (except 382, 524 and 636 models)
 - > Cutlery drawer on smooth-action steel runners
 - > Two pull-out wire baskets in kitchen cupboard
 - > Door flyscreen with easy concertina action
 - > Beech slat seat and bed bases with sprung hinged tops for extra comfort and easy access
 - > Midi-Heki roof window with flynet and adjustable concertina blind
 - > Cassette flyscreens and blinds on all windows
 - > Multi-directional clear roof lights in kitchens, bedrooms and washrooms
 - > Twin curtain track for improved hanging and ease of use

- > Sprung interior mattresses in fixed bed models
 - > Fixed beds with steel bed frames to maximise strength and storage space
 - > Seat and backrest ventilation boards
 - > Two large scatter cushions
 - > Two bolster cushions
 - > Removable carpets
 - > Retained embroidered entrance mat
 - > Thick washroom doors with domestic style locks and handles
 - > Removable drainer with dedicated storage
 - > Food grade nylon chopping board with dedicated storage
 - > Dual fuel (3kW gas and 2kW mains) central heating with electronic ignition
 - > Blown air ducted to living, sleeping and washroom areas
 - > Isolation taps for gas appliances
 - > Low energy over-locker lighting in seating and bedroom areas
 - > Low energy LED lights in main habitation area (not washrooms)
 - > Four 230V sockets including twin in front shelf pod
 - > 25 metre mains hook-up cable
- Safety and Security**
- > AL-KO ATC trailer stability control fitted as standard
 - > AKS 3004 Stabiliser
 - > Receiver for optional AL-KO Secure wheel lock
 - > Smoke alarm
 - > CRIS identity number etched to windows and caravan chassis
 - > Concealed security data chip within caravan construction
 - > High security entrance lock
 - > Carbon monoxide detector
- Equipment**
- > User-friendly large 12V control panel with battery selection, battery state meter and water pump circuit control
 - > Fully protected mains electric system
 - > 25 Amp switchmode charger/transformer
 - > Radio/CD/MP3 player with iPod connection
 - > Thetford electronic ignition, digital control
 - > 112 litre fridge with metallic door finish
 - > Thetford C250 toilet with electric flush and 18 litre wheeled waste tank
 - > Thetford thermostatic oven and separate grill
 - > Glass hob lid with safety cut-out feature

- Factory-fit Options**
- > Panoramic front sunroof
 - > Alternative fabric scheme from Challenger range
- Dealer-fit Options**
- > Alarm system (infra-red with tilt sensor and key-fob operation)
 - > AL-KO Secure wheel lock
 - > AL-KO side lift jack
 - > Wrap-around seating in addition to drawer chest

AWNING SIZES: Due to the varying awning designs and sizes the awning sizes given are approximate only. Specific awning sizes must be confirmed by your dealer or the awning manufacturer prior to purchase.

Bed Sizes: Please note that the front double bed sizes quoted are for seating configurations without chest of drawers. The front double bed width for a layout with a chest of drawers fitted will be reduced by 0.4m(1'4") from that stated.

Weights: The method of calculating the Mass in Running Order (MRO) and user payload figures has changed in order to bring it in line with European Vehicle Directives.

Allowances for essential equipment (e.g. gas cylinders) previously allowed for in the user payload are now contained within the MRO. A provision for a leisure battery which used to be within the essential equipment payload has now been included within the personal effects payload allowance. Although the method of calculation has changed, the overall effect is that the amount of payload available to the customer has remained the same, it is just calculated in a different manner.