

Sterling Caravans
 Dunswell Road, Cottingham
 East Yorkshire HU16 4JX
 Tel 01482 847332
 Fax 01482 841042
 email enquiry@swiftgroup.co.uk

For more information and to find your nearest retailer visit us at www.swiftgroup.co.uk

All models are covered by a ten-year bodyshell integrity warranty and come with a three-year SuperSure manufacturer's warranty. See www.swiftgroup.co.uk for more details including extra pictures, videos, reviews and much more.



Sterling Caravans

Eccles Sport | Eccles SE | Elite



www.swiftgroup.co.uk

This brochure does not constitute an offer by Swift Group Limited (Swift). Swift reserves the right to alter specifications and prices at any time as materials and conditions demand. Distributors and dealers sell Sterling products on their own account and not as agents of Swift. Accordingly, they have no authority to bind Swift or to make any representation or undertaking whatsoever on behalf of Swift. All props are for photographic purposes only and are not included in the specification. Issued August 2012



Home



Previous



Next



Content



Show Menu



Print



Zoom In



Zoom Out



Save



Find a model
Find a Sterling demonstration model



Swift TV
View exclusive video content online



Stay informed
Sign up to our Swift Group newsletter



Go Social
Social Network for Caravan Enthusiasts



FREE Swift Group Backed Warranty
10 YEAR Bodysell integrity warranty

Tried, tested and fully approved.

As the UK's leading leisure vehicle manufacturer, the Swift Group undertakes what is probably the most extensive research and testing programme in the industry to ensure the design team can create products that set the industry standard for style, value and practicality.

From the detail of which timber is best for the furniture to how to protect the chassis and exterior aluminium from the elements, how to make sure Swift uses the most suitable tyres, to the best chassis and the most suitable equipment for mobile use.

Rigorous safety testing at Millbrook, cold chamber testing down to minus 15°C and beyond, put prototypes through conditions most products will never have to experience in a lifetime, all part of the Swift ethos to deliver the best product possible to you.

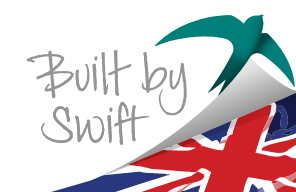



Eccles Sport

With modern styling and cutting edge interiors the Eccles Sport range provides outstanding value at weights that can be towed by most family cars.

All models now come with the feature panoramic front roof window as standard and there is a choice of 10 layouts including a 6 berth family twin axle.



Find a model 
To find a Eccles Sport demonstration model visit swiftgroup.co.uk





Join us online
Social Network for Caravan Enthusiasts
swift-talk.co.uk

Further upgrades for 2013 include fitting the Truma Combi boiler which operates from both gas and 230V mains power for the hot water and blown air system and is controlled by a programmable, touch screen control panel, exclusive to Swift.

The size of a conventional water heater, it enables the space that previously housed the room heater to be used for additional storage.





Eccles

The all new Eccles SE range sets new standards in style, specification and weight in this market sector.

With weight savings of up to 128 kilograms over the previous models, the new models fall within a much larger range of towing vehicles.

Find a model 

To find a Sterling demonstration model visit swiftgroup.co.uk



Join us online

Social Network for Caravan Enthusiasts
swift-talk.co.uk



Amazingly, Sterling designers have been able to massively increase the specification on top of these substantial reductions in weight. Top of the list of improvements is the Alde radiator central heating system, with touch screen controls, exclusive to the Swift Group. A first in this market sector.

Other improvements include a 20 Watt roof mounted solar panel, the latest 110 litre Dometic fridge with removable freezer compartment, new locker design and complimentary fabrics. With six single axle and one twin axle model there is a layout to suit every need.



Home



Previous



Next



Content



Show Menu



Print



Zoom In



Zoom Out



Save



Find a model
Find a Sterling demonstration model



Swift TV
View exclusive video content online



Stay informed
Sign up to our Swift Group newsletter



Go Social
Social Network for Caravan Enthusiasts

Elite

The Eccles Elite range is the ultimate in touring luxury. With class leading width and headroom they house everything you need for 5 star touring.

Available in both single and twin axle layouts they are quite simply the best all round tourers that money can buy.



Home



Previous



Next



Content



Show Menu



Print



Zoom In



Zoom Out



Save



Find a model
Find a Sterling demonstration model



Swift TV
View exclusive video content online



Stay informed
Sign up to our Swift Group newsletter



Go Social
Social Network for Caravan Enthusiasts



For 2013 the Alde central heating and hot water system gets a user friendly touch screen control system that is exclusive to Swift. The latest Dometic fridges come with either a removable freezer compartment or a separate freezer depending on the model.

Keeping the leisure battery charged is made easy with the new roof mounted solar panel which delivers 20watts of power and the aerodynamic exterior, with distinctive panoramic roof window, continues to be the most stylish shape on the market.

The list of luxury, safety and practical features is almost endless. Infact these models are so complete that they are only missing one thing... you.



Home



Previous



Next



Content



Show Menu



Print



Zoom In



Zoom Out



Save



Find a model
Find a Sterling demonstration model



Swift TV
View exclusive video content online



Stay informed
Sign up to our Swift Group newsletter



Go Social
Social Network for Caravan Enthusiasts

Features

All Sterling tourers come with an impressive array of features.

AL-KO All tourers in this brochure come fitted with the AL-KO ATC trailer control system as standard. This enhances the towing experience and provides extra safety while towing at higher speeds. They also come with the added safety of the AL-KO AKS 3004 stabiliser.

Alde All Eccles SE and Elite models come fitted with the latest Alde radiator heating and hot water system for optimum comfort. All other models have the Truma Combi boiler for dual powered hot water and blown air heating.

TRACKER secure • inform • protect All Swift Group tourers are fitted with the self powered Tracker Retrieve system. This is one of the most effective tracking systems available, recognised by all police forces. Powered by its own battery, it is ideal while the caravan is in use or in storage. Activation of the system is via a specially negotiated annual subscription.

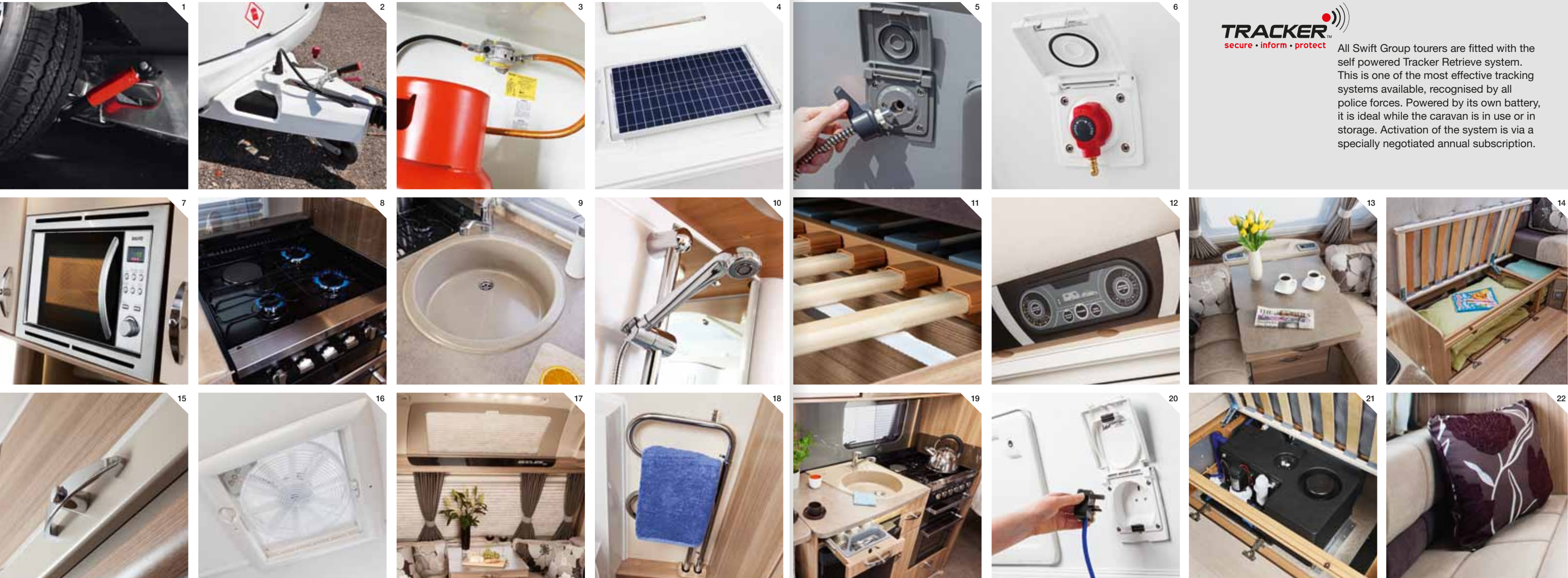

1. Shock absorbers for a smoother towing experience
2. Step on hitch cover for easy cleaning of front windows
3. Gas Regulator with stainless steel braided hose for improved reliability
4. 20W roof mounted solar panel for enhanced independence (Except Sport models)
5. External shower point (Elite only)
6. BBQ point for alfresco cooking (Except Sport models)
7. Ventilated microwave oven with digital control built in at an easily accessible level
8. Dual fuel hob with 800W electric hotplate and 3 gas burners combined with separate grill and glass fronted oven
9. Stylish and practical granite effect sink with removable drainer and pull up sink extension
10. Separate shower mixers with adjustable head positions
11. Bed make-up system with slats retained on track
12. User friendly 12V control panel
13. Pull out chest of drawers with convenient front shelf pod
14. Seat bases with spaceframe construction, full front access and space for larger items
15. Positive locker catches for secure storage on the move
16. Omnivent three speed, two way roof fan (Except Sport models)
17. Rollo pleated blinds (Except Sport models)
18. ALDE towel radiator in washroom (Model specific in Eccles SE models, not included in Sport models)
19. Low Energy lighting system featuring:
 - Over locker lights and LED task lighting
 - LED kitchen splash back panel and worktop drip lighting (Except Sport models)
 - LED Low level lighting in end of beds (Except Sport models)
 - LED backlights in washroom mirrors (Except Sport models)
20. 230V Exterior socket (Except Sport models)
21. 30 litre internal fresh water tank with additional pump for tank filling or direct feed to taps (Except Sport and single axle SE models)
22. Optional 'Impala' stain-resistant, easy clean seating fabric with soft nubuck texture

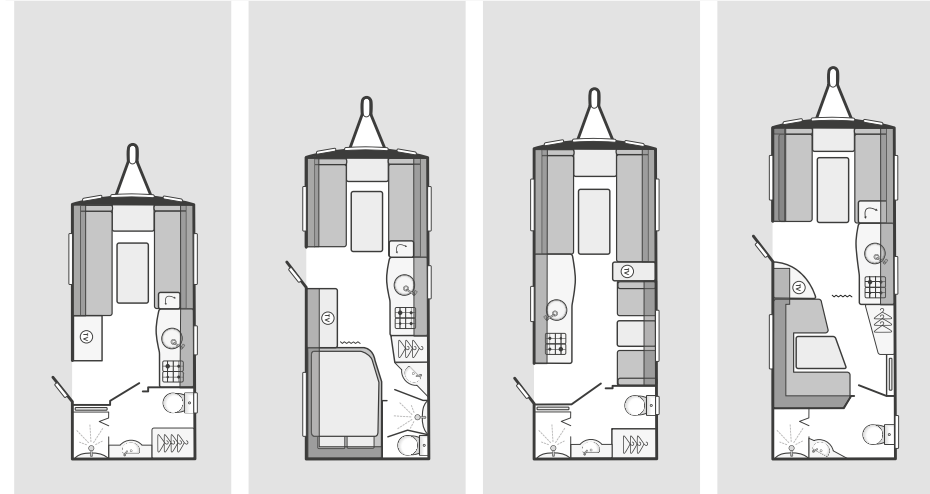
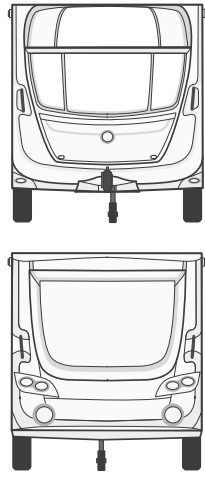

Berths	2	4	4	4
Number of Axles	1	1	1	1
Internal Length (at bed box height)	4.40m / 14' 5"	5.23m / 17' 2"	5.29m / 17' 4"	5.60m / 18' 4"
Overall Width	2.25m / 7' 5"	2.25m / 7' 5"	2.25m / 7' 5"	2.25m / 7' 5"
Overall Height (inc. TV Aerial) *	2.64m / 8' 8"	2.65m / 8' 8"	2.65m / 8' 8"	2.65m / 8' 8"
Maximum Internal Headroom	1.95m / 6' 5"	1.95m / 6' 5"	1.95m / 6' 5"	1.95m / 6' 5"
Overall Length	6.06m / 19' 11"	6.88m / 22' 7"	6.94m / 22' 9"	7.25m / 23' 9"
Awning A/A Dimension	8.79m / 28' 10"	9.62m / 31' 7"	9.68m / 31' 9"	9.99m / 32' 9"
Mass in Running Order (inc. tolerance)	1114kg / 21.9cwt	1230kg / 24.2cwt	1265kg / 24.9cwt	1282kg / 25.2cwt
Maximum Technical Permissible Laden Mass	1235kg / 24.3cwt	1380kg / 27.2cwt	1415kg / 27.9cwt	1435kg / 28.2cwt
Total User Payload	121kg / 2.4cwt	150kg / 3.0cwt	150kg / 3.0cwt	153kg / 3.0cwt
Personal Effects Payload	121kg / 2.4cwt	150kg / 3.0cwt	150kg / 3.0cwt	153kg / 3.0cwt
Tyre Size	185 R14C 102 Q	185 R14C 102 Q	185 R14C 102 Q	185 R14C 102 Q
Thermal Insulation Grade	THREE	THREE	THREE	THREE
Front Double	202cm x 180cm/6'8" x 5'11"	202cm x 153cm / 6'8" x 5'0"	202cm x 180cm / 6'8" x 5'11"	202cm x 159cm / 6'8" x 5'3"
Or Front Nearside Single	190cm x 72cm / 6'3" x 2'4"	153cm x 72cm / 5'0" x 2'4"	180cm x 72cm / 5'11" x 2'4"	160cm x 72cm / 5'3" x 2'4"
And Front Offside Single	180cm x 72cm / 5'11" x 2'4"	160cm x 72cm / 5'3" x 2'4"	190cm x 72cm / 6'3" x 2'4"	160cm x 72cm / 5'3" x 2'4"
Rear Double		198cm x 133cm / 6'6" x 4'4"		191cm x 133cm / 6'3" x 4'4"
Side Single Offside			180cm x 62cm / 5'11" x 2'0"	
Side Single Nearside				
Side Bunk Nearside				
Side Bunk Offside			176cm x 59 / 5'9" x 1'11"	
Side Fixed Lower Bunk				
Side Fixed Upper Bunk				

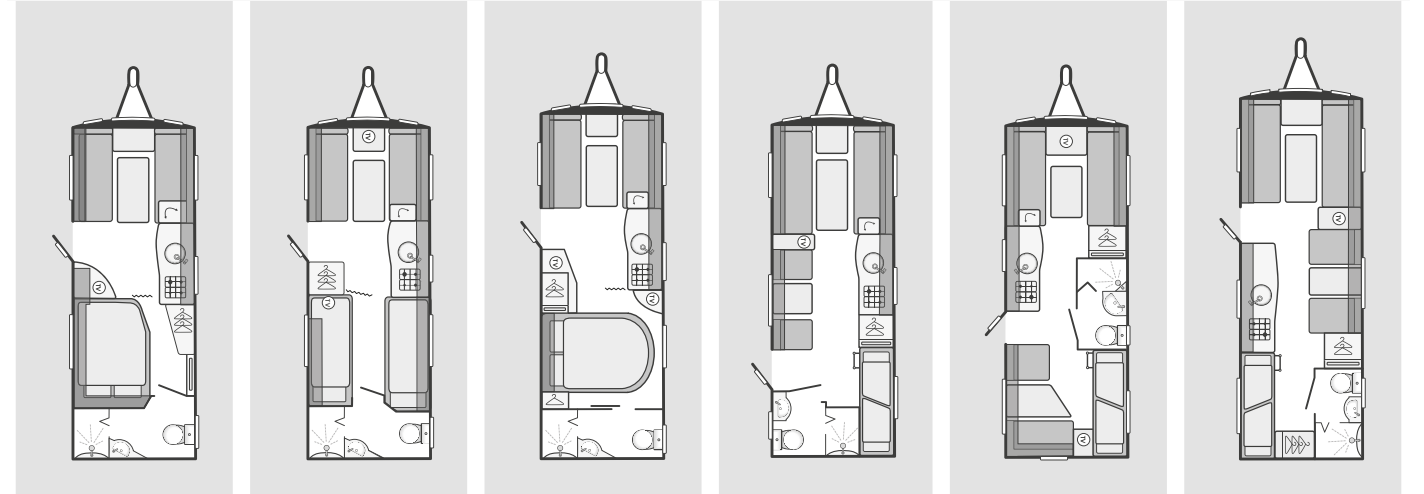

4	4	4	6	6	6
1	1	1	1	1	2
5.60m / 18' 4"	5.60m / 18' 4"	5.83m / 19' 2"	5.60m / 18' 4"	5.83m / 19' 2"	6.27m / 20' 7"
2.25m / 7' 5"	2.25m / 7' 5"	2.25m / 7' 5"	2.25m / 7' 5"	2.25m / 7' 5"	2.25m / 7' 5"
2.65m / 8' 8"	2.65m / 8' 8"	2.65m / 8' 8"	2.65m / 8' 8"	2.65m / 8' 8"	2.62m / 8' 7"
1.95m / 6' 5"	1.95m / 6' 5"	1.95m / 6' 5"	1.95m / 6' 5"	1.95m / 6' 5"	1.95m / 6' 5"
7.25m / 23' 9"	7.25m / 23' 9"	7.48m / 24' 6"	7.25m / 23' 9"	7.48m / 24' 6"	7.93m / 26' 0"
9.99m / 32' 9"	9.99m / 32' 9"	10.22m / 33' 6"	9.99m / 32' 9"	10.22m / 33' 6"	10.66m / 35' 0"
1277kg / 25.1cwt	1290kg / 25.4cwt	1308kg / 25.7cwt	1312kg / 25.8cwt	1381kg / 27.2cwt	1470kg / 28.9cwt
1430kg / 28.1cwt	1443kg / 28.4cwt	1464kg / 28.8cwt	1485kg / 29.2cwt	1557kg / 30.6cwt	1650kg / 32.5cwt
153kg / 3.0cwt	153kg / 3.0cwt	156kg / 3.1cwt	173kg / 3.4cwt	176kg / 3.5cwt	180kg / 3.5cwt
153kg / 3.0cwt	153kg / 3.0cwt	156kg / 3.1cwt	173kg / 3.4cwt	176kg / 3.5cwt	180kg / 3.5cwt
185 R14C 102 Q	185 R14C 102 Q	185 R14C 102 Q	185 R14C 102 Q	195/70 R15C 104 R	185/70 R14 88 T
THREE	THREE	THREE	THREE	THREE	THREE
202cm x 159cm / 6'8" x 5'3"	202cm x 159cm / 6'8" x 5'3"	202cm x 159cm / 6'8" x 5'3"	208cm x 180cm / 6'8" x 5'11"	202cm x 180cm / 6'8" x 5'11"	202cm x 180cm / 6'8" x 5'11"
160cm x 72cm / 5'3" x 2'4"	160cm x 72cm / 5'3" x 2'4"	160cm x 72cm / 5'3" x 2'4"	180cm x 72cm / 5'11" x 2'4"	190cm x 72cm / 6'3" x 2'4"	180cm x 72cm / 5'11" x 2'4"
160cm x 72cm / 5'3" x 2'4"	160cm x 72cm / 5'3" x 2'4"	160cm x 72cm / 5'3" x 2'4"	180cm x 72cm / 5'11" x 2'4"	180cm x 72cm / 5'11" x 2'4"	190cm x 72cm / 6'3" x 2'4"
191cm x 133cm / 6'3" x 4'4"		185cm x 133cm / 6'1" x 4'4"			
	192cm x 71cm / 6'4" x 2'4"				180cm x 82cm / 5'11" x 2'8"
	183cm x 75cm / 6'0" x 2'6"		180cm x 62cm / 5'11" x 2'0"	180cm x 67cm / 5'11" x 2'2"	
			176cm x 59cm / 5'9" x 1'11"	176cm x 59cm / 5'9" x 1'11"	
					176cm x 59cm / 5'9" x 1'11"
			183cm x 57cm / 6'0" x 1'10"	183cm x 57cm / 6'0" x 1'10"	181cm x 57cm / 5'11" x 1'10"
			183cm x 57cm / 6'0" x 1'10"	183cm x 57cm / 6'0" x 1'10"	181cm x 56cm / 5'11" x 1'10"

Sterling Plus Points

You can be reassured when you buy a Sterling Caravan that they all come with the following market leading features

- European Whole Vehicle Type Approval ensures compliance with strict weight, dimension and safety regulations
- EN1645 Grade 3 classification for heating and thermal insulation
- 1.95m (6'5") headroom
- One-piece, 5000 Series marine grade aluminium sidewalls
- Higher tyre rating - a minimum of 150kg extra load margin at 130kph (law permitting)
- Shock absorbers for a smoother towing experience
- Step-on hitch cover for easy cleaning of front windows
- Gas regulator fitted with stainless steel braided hose for improved reliability
- High security entrance lock for peace of mind
- Aerial point in battery box for portable satellite dish connection
- TV station with 230V, 12V and aerial sockets (two in 586, 564 and 584 models)
- Bed make-up system with slats retained on track
- Seat bases with spaceframe construction, full front access and space for larger items
- Areas under beds and seats warmed by blown air system and underfloor ducting insulated to minimise heat loss
- Front chest of drawers with convenient slide-out extending top
- Large dining table (960mm x 600mm) for full-size place settings
- Positive overhead locker catches for secure storage on the move
- Dual fuel hob with 800W electric hotplate and 3 gas burners with electronic ignition
- Ventilated microwave oven with digital controls built at an easily accessible level
- High flow rate in-board pump with chrome finish brass taps for reliable, high performance water supply
- Separate shower mixers with adjustable head positions
- High impact, scratch resistant floor lino
- Large capacity (15 litre) waste bin on lower door
- Freestanding solar panel connection (provision only)
- New Panoramic front sunroof - now standard
- New Thatcham approved tracker fitted as standard

Additional Features

- Exterior**
 - Aerodynamic front in closed-mould GRP with wide front door
 - Full height moulded rear panel
 - Fully bonded roof for extra strength and flatness
 - Semi-recessed body colour awning rail both sides
 - Overall body width 2.25m/7'4½"
 - AL-KO galvanised steel chassis with Euro-axle
 - AL-KO Euro overrun device with two-way assisted handbrake
 - Exclusive alloy wheels
 - Steel spare wheel and carrier
 - 13-pin 'Jaeger' 12V car connector
 - Status 530 directional digital and analogue TV aerial
 - Fully double-glazed opening windows (no single-glazed cold areas)
 - New LED awning light
 - Exterior two-part door with interior moulded liner, window and blind
 - Exterior access battery box with mains electric inlet (battery not included)
 - Entrance step
 - 25mm 'sandwich' sidewalls with HD polystyrene insulation core
 - 32mm 'sandwich' roof with HD polystyrene insulation core
 - 44mm 'sandwich' floor with high rigidity Styrofoam core
- Interior**
 - New 'Italian Ash' woodgrain with contemporary colouring and defined woodgrain texture with complementary fabrics
 - Granite effect kitchen sink with removable extension drainer
 - Kitchen worktop extensions (except 524 and 636 models)
 - Cutlery drawer on smooth-action steel runners
 - Two pull-out wire baskets in kitchen cupboard
 - Door flyscreen with easy concertina action
 - Beech slat seat and bed bases with sprung hinged tops for extra comfort and easy access
 - Midi-Heki roof window with flynet and adjustable concertina blind
 - Cassette flyscreens and blinds on all windows
 - Multi-directional clear roof lights in kitchens, bedrooms and washrooms
 - Twin curtain track for improved hanging and ease of use
 - Sprung interior mattresses in fixed bed models
 - Fixed beds with steel bed frames to maximise strength and storage space
 - Seat and backrest ventilation boards
 - Two scatter cushions

- Two bolster cushions
- Removable carpets
- Retained embroidered entrance mat
- Thick washroom doors with domestic style locks and handles
- Removable drainer with dedicated storage
- Food grade nylon chopping board with dedicated storage
- Equipment**
 - New Truma dual fuel combi boiler with programmable timing for heating and hot water and touch screen control
 - User-friendly large 12V control panel with battery selection, battery state meter and water pump circuit control
 - Fully protected mains electric system
 - 25 Amp switchmode charger/transformer
 - Radio/CD/MP3 player with iPod connection
 - New Thetford 113ltr fridge/freezer with electronic ignition, LED controls and a black effect finish
 - Thetford C260 toilet with electric flush and 18 litre wheeled waste tank
 - Thetford thermostatic oven and separate grill
- Glass hob lid with safety cut-out feature
- Blown air ducted to living, sleeping and washroom areas
- Isolation taps for gas appliances
- Low energy over-locker lighting in seating and bedroom areas
- Low energy LED lights in main habitation area (not washrooms)
- Four 230V sockets including twin in front shelf pod
- 25 metre mains hook-up cable
- Safety and Security**
 - AL-KO ATC trailer stability control fitted as standard
 - AKS 3004 Stabiliser
 - Receiver for optional AL-KO Secure wheel lock
 - Smoke alarm
 - CRIS identity number etched to windows and caravan chassis
 - Concealed security data chip within caravan construction
 - High security entrance lock
 - Carbon monoxide detector
 - New Thatcham approved tracker fitted as standard
- Factory-fit Option**
 - Alternative fabric scheme
- Dealer-fit Options**
 - Alarm system (infra-red with tilt sensor and key-fob operation)
 - AL-KO Secure wheel lock
 - AL-KO side lift jack
 - Wrap-around seating in addition to drawer chest
 - Coordinated bedding set for fixed bed layouts

WEIGHTS: The method of calculating the Mass in Running Order (MRO) and user payload figures has changed in order to bring it in line with European Vehicle Directives.

Allowances for essential equipment (e.g. gas cylinders) previously allowed for in the user payload are now contained within the MRO. A provision for a leisure battery which used to be within the essential equipment payload has now been included within the personal effects payload allowance.

Although the method of calculation has changed, the overall effect is that the amount of payload available to the customer has remained the same, it is just calculated in a different manner.

BED SIZES: Please note that the front double bed sizes quoted are for seating configurations without a chest of drawers. The front double bed width for a layout with a chest of drawers fitted, will be reduced by 0.4m (1'4") from that stated.

AWNING SIZES: Due to varying awning designs and sizes the awning sizes given are approximate only. Specific awning sizes must be confirmed by your dealer or awning manufacturer prior to purchase.

* The dimensions given are approximate due to slight variations in suspension ride heights, loading conditions and tyre pressures.

Customers should verify the actual dimensions of their touring caravan before committing to anything that could be impacted by these dimensions

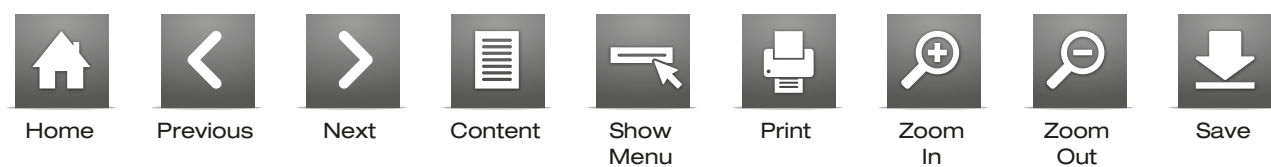

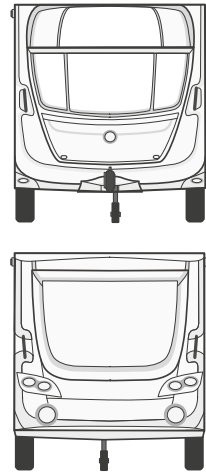

Topaz **Moonstone** **Solitaire**

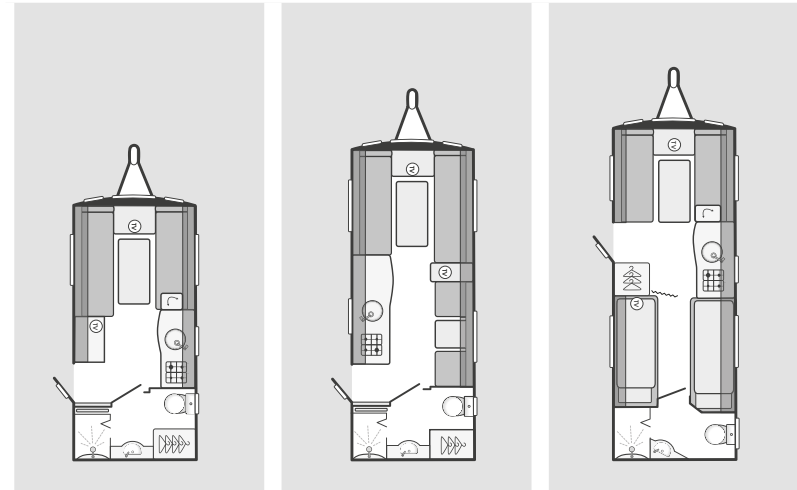

	Topaz	Moonstone	Solitaire
Berths	2	4	4
Number of Axles	1	1	1
Internal Length (at bed box height)	4.40m / 14' 5"	5.29m / 17' 4"	5.60m / 18' 4"
Overall Width	2.25m / 7' 5"	2.25m / 7' 5"	2.25m / 7' 5"
Overall Height (inc. TV Aerial)*	2.64m / 8' 8"	2.65m / 8' 8"	2.65m / 8' 8"
Maximum Internal Headroom	1.95m / 6' 5"	1.95m / 6' 5"	1.95m / 6' 5"
Overall Length	6.06m / 19' 11"	6.94m / 22' 9"	7.25m / 23' 9"
Awning A/A Dimension	8.77m / 28' 9"	9.65m / 31' 8"	9.96m / 32' 8"
Mass in Running Order (inc. tolerance)	1161kg / 22.9cwt	1324kg / 26.1cwt	1400kg / 27.6cwt
Maximum Technical Permissible Laden Mass	1282kg / 25.2cwt	1474kg / 29.0cwt	1553kg / 30.6cwt
Total User Payload	121kg / 2.4cwt	150kg / 3.0cwt	153kg / 3.0cwt
Personal Effects Payload	121kg / 2.4cwt	150kg / 3.0cwt	153kg / 3.0cwt
Tyre Size	185 R14C 102 Q	185 R14C 102 Q	195 R15C 104 R
Thermal Insulation Grade	THREE	THREE	THREE
Front Double	202cm x 176cm / 6'8" x 5'9"	202cm x 176cm / 6'8" x 5'9"	202cm x 156cm / 6'8" x 5'1"
Or Front Nearside Single	186cm x 72cm / 6'1" x 2'4"	176cm x 72cm / 5'9" x 2'4"	156cm x 72cm / 5'1" x 2'4"
And Front Offside Single	176cm x 72cm / 5'9" x 2'4"	186cm x 72cm / 6'1" x 2'4"	156cm x 72cm / 5'1" x 2'4"
Rear Double			
Side Single Offside		180cm x 62cm / 5'11" x 2'0"	192cm x 68cm / 6'4" x 2'3"
Side Single Nearside			183cm x 73cm / 6'0" x 2'5"
Side Bunk Offside		176cm x 59cm / 5'9" x 1'11"	

Ruby **Jade** **Quartz** **Amethyst**

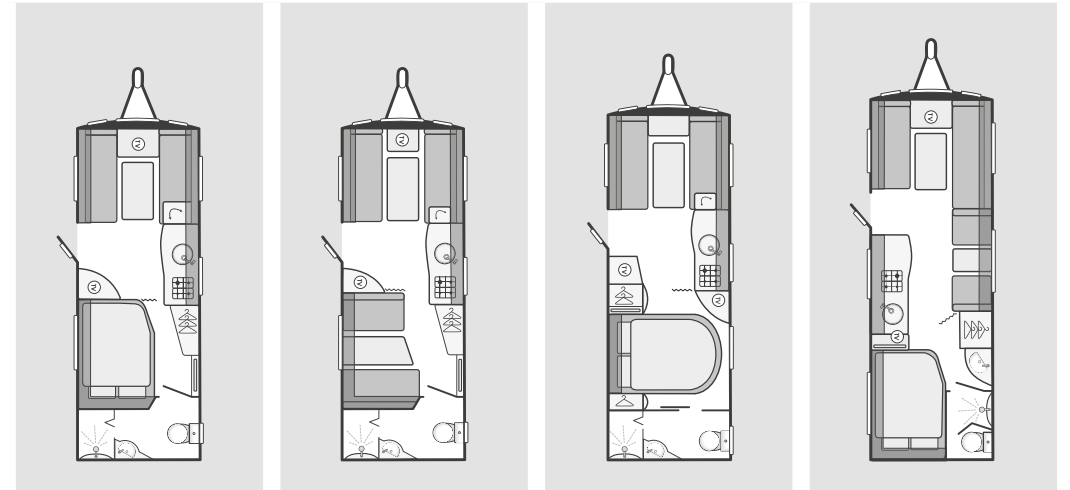

	Ruby	Jade	Quartz	Amethyst
Berths	4	4	4	6
Number of Axles	1	1	1	2
Internal Length (at bed box height)	5.60m / 18' 4"	5.60m / 18' 4"	5.83m / 19' 2"	6.27m / 20' 7"
Overall Width	2.25m / 7' 5"	2.25m / 7' 5"	2.25m / 7' 5"	2.25m / 7' 5"
Overall Height (inc. TV Aerial)*	2.65m / 8' 8"	2.65m / 8' 8"	2.65m / 8' 8"	2.62m / 8' 7"
Maximum Internal Headroom	1.95m / 6' 5"	1.95m / 6' 5"	1.95m / 6' 5"	1.95m / 6' 5"
Overall Length	7.25m / 23' 9"	7.25m / 23' 9"	7.48m / 24' 6"	7.93m / 26' 0"
Awning A/A Dimension	9.96m / 32' 8"	9.96m / 32' 8"	10.19m / 33' 5"	10.64m / 34' 11"
Mass in Running Order (inc. tolerance)	1342kg / 26.4cwt	1342kg / 26.4cwt**	1357kg / 26.7cwt**	1570kg / 30.9cwt**
Maximum Technical Permissible Laden Mass	1495kg / 29.4cwt	1495kg / 29.4cwt**	1513kg / 29.8cwt**	1750kg / 34.4cwt**
Total User Payload	153kg / 3.0cwt	153kg / 3.0cwt	156kg / 3.1cwt	180kg / 3.5cwt
Personal Effects Payload	153kg / 3.0cwt	153kg / 3.0cwt	153kg / 3.0cwt	180kg / 3.5cwt
Tyre Size	185 R14C 102 Q	185 R14C 102 Q	195/70 R15C 104 R	185/70 R14 88 T
Thermal Insulation Grade	THREE	THREE	THREE	THREE
Front Double	202cm x 156cm / 6'8" x 5'1"	202cm x 156cm / 6'8" x 5'1"	202cm x 156cm / 6'8" x 5'1"	202cm x 176cm / 6'8" x 5'9"
Or Front Nearside Single	156cm x 72cm / 5'1" x 2'4"	156cm x 72cm / 5'1" x 2'4"	156cm x 72cm / 5'1" x 2'4"	176cm x 72cm / 5'9" x 2'4"
And Front Offside Single	156cm x 72cm / 5'1" x 2'4"	156cm x 72cm / 5'1" x 2'4"	156cm x 72cm / 5'1" x 2'4"	186cm x 72cm / 6'1" x 2'4"
Rear Double				
Side Single Offside				180cm x 69cm / 5'11" x 2'3"
Side Single Nearside				
Side Bunk Offside				176cm x 59cm / 5'9" x 1'11"

Find a model

To find a Sterling demonstration model visit swiftgroup.co.uk

WEIGHTS: The method of calculating the Mass in Running Order (MRO) and user payload figures has changed in order to bring it in line with European Vehicle Directives. Allowances for essential equipment (e.g. gas cylinders) previously allowed for in the user payload are now contained within the MRO. A provision for a leisure battery which used to be within the essential equipment payload has now been included within the personal effects payload allowance.

Although the method of calculation has changed, the overall effect is that the amount of payload available to the customer has remained the same, it is just calculated in a different manner.

BED SIZES: Please note that the front double bed sizes quoted are for seating configurations without a chest of drawers. The front double bed width for a layout with a chest of drawers fitted, will be reduced by 0.4m (1'4") from that stated.

AWNING SIZES: Due to varying awning designs and sizes the awning sizes given are approximate only. Specific awning sizes must be confirmed by your dealer or awning manufacturer prior to purchase.

* The dimensions given are approximate due to slight variations in suspension ride heights, loading conditions and tyre pressures.

** Estimated weight

Customers should verify the actual dimensions of their touring caravan before committing to anything that could be impacted by these dimensions

Sterling Plus Points

You can be reassured when you buy a Sterling Caravan that they all come with the following market leading features

- European Whole Vehicle Type Approval ensures compliance with strict weight, dimension and safety regulations
- EN1645 Grade 3 classification for heating and thermal insulation
- 1.95m (6'5") headroom
- One-piece, 5000 Series marine grade aluminium sidewalls
- Higher tyre rating - a minimum of 150kg extra load margin at 130kph (law permitting)
- Shock absorbers for a smoother towing experience
- Step-on hitch cover for easy cleaning of front windows
- Gas regulator fitted with stainless steel braided hose for improved reliability
- High security entrance lock for peace of mind
- Aerial point in battery box for portable satellite dish connection
- Two TV stations with 230V, 12V and aerial sockets
- Bed make-up system with slats retained on track
- Seat bases with spaceframe construction, full front access and space for larger items
- Areas under beds and seats warmed by Alde radiator system
- Front chest of drawers with convenient slide-out extending top
- Large dining table (960mm x 600mm) for full-size place settings
- Positive overhead locker catches for secure storage on the move
- Dual fuel hob with 800W electric hotplate and 3 gas burners with electronic ignition
- Ventilated microwave oven with digital controls built at an easily accessible level
- High flow rate in-board pump with chrome finish brass taps for reliable, high performance water supply
- Separate shower mixers with adjustable head positions
- High impact, scratch resistant floor lino
- Large capacity (15 litre) waste bin on lower door
- New** 20 Watt solar panel fitted as standard
- Panoramic front sunroof
- New** Thatcham approved tracker fitted as standard

Additional Features

- Exterior**
- New** Exterior profile with Aerodynamic front in closed-mould GRP with wide front door
 - Full height moulded rear panel
 - Fully bonded roof for extra strength and flatness
 - Semi-recessed body colour awning rail both sides
 - Panoramic front sunroof
 - 2.25m (7'4½") overall width for a more spacious interior
 - 25mm 'sandwich' side walls with HD polystyrene insulation core
 - 32mm 'sandwich' roof with HD polystyrene core
 - 44mm 'sandwich' floor with high rigidity Styrofoam core
 - Wheel arches insulated with high density foam to prevent cold spots in storage areas
 - New** exclusive design alloy wheels
 - Heavy duty corner steadies all round, lockable at rear
 - BBQ point
 - Exterior two part door with interior moulded liner window and blind (45mm / 2" wider and 50mm / 3" taller than standard size)
- Interior**
- 'Italian Ash' woodgrain with contemporary colouring and defined woodgrain texture with new complementary fabrics
 - Overhead lockers with injection-moulded spaceframe construction and **new** re-styled furniture doors with cream infill and chrome effect handles
 - Granite effect kitchen sink with larger integrated drainer and removable extension drainer
 - New** Additional lift up sink extension (Not available in Amethyst & Moonstone)
 - Heki 2 Deluxe large tilting panoramic roof window with flynet and pleated blind

- Multi-position 'Mini-Heki' or 'Midi-Heki' clear roof light with flyscreen and blind in kitchen, bedrooms and washroom
 - Pleated blinds and fly nets to all windows
 - New** Removable wear resistant hawood quality carpet
 - 'Ultra Comfort' luxury deep sprung bed mattress in fixed bed models
 - Lined washroom cubicle in all separate washrooms
 - Fixed beds with steel frames to maximise strength and storage space
 - Hinged seat and bed tops supported in open position for easy access
 - New** Access flaps in fixed bed surrounds and day seat ends
 - Mattresses and seat cushions supported by beech slats for extra comfort
 - Seat and backrest ventilation boards
 - Two scatter cushions
 - Twin curtain track for improved hanging and ease of use
 - New** Luxury curtains with double width fabric on all windows
 - Food grade nylon chopping board with dedicated storage
 - Slide-out storage rack
 - New** Second moulded cutlery drawer on smooth steel runner above fridge
 - 32mm thick lightweight washroom door with metal domestic style handle
 - New** Washroom hanging rail
 - New** Fabric blinds to washroom window (model specific)
- Equipment**
- New** ALDE radiator central heating and water heating with daily programming with LCD touch screen control and choice of 1KW, 2KW or **new** 3KW setting
 - New** ALDE towel radiator in washroom (except Amethyst)
 - New** 20 Watt solar panel fitted as standard
 - Low energy lighting system throughout with ambient over-locker lights, LED task lights and **new** low level night lights
 - New** LED back-lit acrylic sink splash back and kitchen under worktop lighting
 - New** LED backlights in washroom mirrors
 - LED down lighters set in plinth over kitchen locker
 - Status 530 directional Digital / Analogue TV/FM aerial and booster
 - Radio/CD/MP3 player with iPod/MP3 player connection
 - 25 metre mains hook-up cable

- Factory-Fit Option**
- Alternative fabric scheme including the 'Impala' stain-resistant, easy-clean seating fabric with soft nubuck texture
- Dealer-Fit Options**
- AL-KO Secure wheel lock
 - AL-KO side lift jack
 - Wrap-around seating in addition to drawer chest
 - Coordinated bedding set for fixed bed layouts
- Safety and Security**
- AL-KO ATC trailer stability control fitted as standard
 - AKS 3004 Stabiliser
 - Receiver for optional AL-KO Secure wheel lock
 - Smoke alarm
 - CRIS identity number etched to windows and caravan chassis
 - Concealed security data chip within caravan construction
 - High security entrance lock
 - Carbon monoxide detector
 - Passive infra-red alarm system with tilt sensor and key fob operation
 - New** Thatcham approved tracker fitted as standard

Home
 Previous
 Next
 Content
 Show Menu
 Print
 Zoom In
 Zoom Out
 Save

Find a model
Find a Sterling demonstration model
 Swift TV
View exclusive video content online
 Stay informed
Sign up to our Swift Group newsletter
 Go Social
Social Network for Caravan Enthusiasts

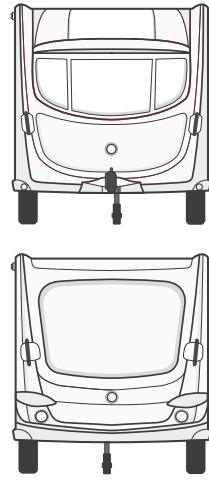

Diamond **Emerald** **Opal**

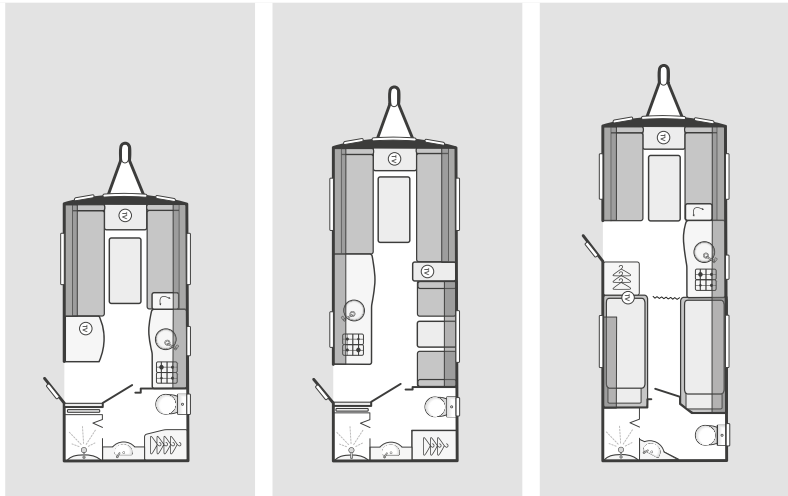

Berths	2	4	4
Number of Axles	1	1	1
Internal Length (at bed box height)	4.74m / 15' 7"	5.50m / 18' 1"	5.60m / 18' 4"
Overall Width	2.31m / 7' 7"	2.31m / 7' 7"	2.31m / 7' 7"
Overall Height (inc. TV Aerial)*	2.62m / 8' 7"	2.67m / 8' 9"	2.67m / 8' 9"
Maximum Internal Headroom	1.95m / 6' 5"	1.95m / 6' 5"	1.95m / 6' 5"
Overall Length	6.46m / 21' 2"	7.22m / 23' 8"	7.32m / 24' 0"
Awning A/A Dimension	9.12m / 29' 11"	9.88m / 32' 5"	9.98m / 32' 9"
Mass in Running Order (inc. tolerance)	1355kg / 26.7cwt	1517kg / 29.9cwt	1516kg / 29.8cwt
Maximum Technical Permissible Laden Mass	1480kg / 29.1cwt	1670kg / 32.9cwt	1670kg / 32.9cwt
Total User Payload	125kg / 2.5cwt	153kg / 3.0cwt	154kg / 3.0cwt
Personal Effects Payload	125kg / 2.5cwt	153kg / 3.0cwt	153kg / 3.0cwt
Tyre Size	185 R14C 102 Q	195/70 R15C 104 R	195/70 R15C 104 R
Thermal Insulation Grade	THREE	THREE	THREE
Front Double	207cm x 186cm / 6'9" x 6'1"	207cm x 176cm / 6'9" x 5'9"	207cm x 156cm / 6'9" x 5'1"
Or Front Nearside Single	186cm x 72cm / 6'1" x 2'4"	176cm x 72cm / 5'9" x 2'4"	156cm x 72cm / 5'1" x 2'4"
And Front Offside Single	186cm x 72cm / 6'1" x 2'4"	186cm x 72cm / 6'1" x 2'4"	156cm x 72cm / 5'1" x 2'4"
Rear Double			
Side Single Offside		180cm x 69cm / 5'11" x 2'3"	192cm x 72cm / 6'4" x 2'4"
Side Single Nearside			183cm x 73cm / 6'0" x 2'5"
Side Bunk Offside		176cm x 59cm / 5'9" x 1'11"	

Amber **Searcher** **Explorer**

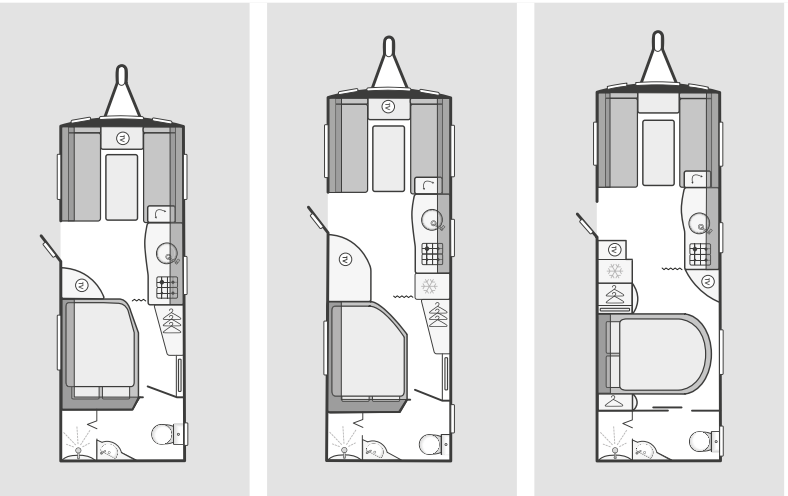

Berths	4	4	4
Number of Axles	1	2	2
Internal Length (at bed box height)	5.60m / 18' 4"	6.27m / 20' 7"	6.27m / 20' 7"
Overall Width	2.31m / 7' 7"	2.31m / 7' 7"	2.31m / 7' 7"
Overall Height (inc. TV Aerial)*	2.67m / 8' 9"	2.62m / 8' 7"	2.62m / 8' 7"
Maximum Internal Headroom	1.95m / 6' 5"	1.95m / 6' 5"	1.95m / 6' 5"
Overall Length	7.32m / 24' 0"	7.99m / 26' 3"	7.99m / 26' 3"
Awning A/A Dimension	9.98m / 32' 9"	10.65m / 34' 11"	10.65m / 34' 11"
Mass in Running Order (inc. tolerance)	1516kg / 29.8cwt	1674kg / 33.0cwt	1644kg / 32.4cwt
Maximum Technical Permissible Laden Mass	1670kg / 32.9cwt	1834kg / 36.1cwt	1804kg / 35.5cwt
Total User Payload	154kg / 3.0cwt	160kg / 3.1cwt	160kg / 3.1cwt
Personal Effects Payload	154kg / 3.0cwt	160kg / 3.1cwt	160kg / 3.1cwt
Tyre Size	195/70 R15C 104 R	185/70 R14 88T	185/70 R14 88T
Thermal Insulation Grade	THREE	THREE	THREE
Front Double	207cm x 156cm / 6'9" x 5'1"	207cm x 156cm / 6'9" x 5'1"	207cm x 156cm / 6'9" x 5'1"
Or Front Nearside Single	156cm x 72cm / 5'1" x 2'4"	156cm x 72cm / 5'1" x 2'4"	156cm x 72cm / 5'1" x 2'4"
And Front Offside Single	156cm x 72cm / 5'1" x 2'4"	156cm x 72cm / 5'1" x 2'4"	156cm x 72cm / 5'1" x 2'4"
Rear Double			
Side Single Offside	192cm x 134cm / 6'4" x 4'5"	192cm x 134cm / 6'4" x 4'5"	185cm x 133cm / 6'1" x 4'4"
Side Single Nearside			
Side Bunk Offside			

Join us online

Social Network for Caravan Enthusiasts
swift-talk.co.uk

Find a model

To find a Sterling demonstration model visit
swiftgroup.co.uk

WEIGHTS: The method of calculating the Mass in Running Order (MRO) and user payload figures has changed in order to bring it in line with European Vehicle Directives.

Allowances for essential equipment (e.g. gas cylinders) previously allowed for in the user payload are now contained within the MRO. A provision for a leisure battery which used to be within the essential equipment payload has now been included within the personal effects payload allowance.

Although the method of calculation has changed, the overall effect is that the amount of payload available to the customer has remained the same, it is just calculated in a different manner.

BED SIZES: Please note that the front double bed sizes quoted are for seating configurations without a chest of drawers. The front double bed width for a layout with a chest of drawers fitted, will be reduced by 0.4m (1'4") from that stated.

AWNING SIZES: Due to varying awning designs and sizes the awning sizes given are approximate only. Specific awning sizes must be confirmed by your dealer or awning manufacturer prior to purchase.

* The dimensions given are approximate due to slight variations in suspension ride heights, loading conditions and tyre pressures.

Customers should verify the actual dimensions of their touring caravan before committing to anything that could be impacted by these dimensions

Sterling Plus Points

You can be reassured when you buy a Sterling Caravan that they all come with the following market leading features

- European Whole Vehicle Type Approval ensures compliance with strict weight, dimension and safety regulations
- EN1645 Grade 3 classification for heating and thermal insulation
- 1.95m (6'5") headroom
- One-piece, 5000 Series marine grade aluminium sidewalls
- Higher tyre rating - a minimum of 130kg extra load margin at 130kph (law permitting)
- Shock absorbers for a smoother towing experience
- Step-on hitch cover for easy cleaning of front windows
- Gas regulator fitted with stainless steel braided hose for improved reliability
- High security entrance lock for peace of mind
- Aerial point in battery box for portable satellite dish connection
- Two TV stations with 230V, 12V and aerial sockets
- Bed make-up system with slats retained on track
- Seat bases with spaceframe construction, full front access and space for larger items
- Areas under beds and seats warmed by A/C radiator system
- Front chest of drawers with convenient slide-out extending top
- Large dining table (960mm x 600mm) for full-size place settings
- Positive overhead locker catches for secure storage on the move
- Dual fuel hob with 800W electric hotplate and 3 gas burners with electronic ignition
- Ventilated microwave oven with digital controls built at an easily accessible level
- High flow rate in-board pump with chrome finish brass taps for reliable, high performance water supply
- Separate shower mixers with adjustable head positions
- High impact, scratch resistant floor lino
- Large capacity (15 litre) waste bin on lower door
- **New** 20 Watt solar panel fitted as standard
- Panoramic front sunroof
- **New** Thatcham approved tracker fitted as standard

Additional Features

- Exterior**
- 2.31m (7'7") overall width
 - Metallic silver finish side walls
 - AL-KO Secure wheel lock (two on twin-axle models)
 - AL-KO side-mounted jack
 - Panoramic front roof window with automotive style roof locker system as standard
 - Full height front with wide door made with strong closed-mould GRP
 - Rain water deflector over front windows incorporating brand badge
 - Imposing rear panel with latest generation rear light clusters
 - Roof capping rails integrating with front and rear panels
 - Semi-recessed body coloured awning channel on both sides
 - Extra strong, thermally efficient 32mm thick fully bonded walls and roof
 - 44mm 'sandwich' floor with pre-treated plywood and Styrofoam insulation core
 - Wheel arches insulated with high density foam to prevent cold spots in storage areas
 - Profiled side skirts in tough self coloured uPVC with integrated awning channel
 - **New** exclusive design alloy wheels in glitter silver finish
- Interior**
- Heavy duty corner steadies all round lockable at rear
 - BBQ point
 - **New** External shower point
 - Exterior two part door with interior moulded liner window and blind (45mm (2") wider and 50mm (3") taller than standard size)
 - External access door under front nearside seat
 - Large external access door under fixed beds (model specific)
 - Exterior access battery box and mains electric inlet (battery not included)
 - AL-KO galvanised steel chassis with Euro-Axle
 - AL-KO Euro overrun device with two-way assisted handbrake
 - 13-pin 'Jaeger' 12V car connector
 - Spare wheel (steel) and underslung carrier
 - Exclusive shape double-glazed opening windows with night ventilation position
 - **New** LED awning light with key fob control
 - Entrance step
 - Door flyscreen with easy concertina action
- Interior**
- 'Italian Ash' woodgrain with contemporary colouring and defined woodgrain texture with **new** complementary fabrics

- Large overhead lockers with injection-moulded spaceframe construction and curved doors with **new** cream infill
 - Granite effect kitchen sink with larger integrated drainer and removable extension drainer
 - Heki Deluxe large tilting panoramic roof window with flynet and pleated blind
 - Multi-position 'Mini-Heki' or 'Midi-Heki' clear roof light with flyscreen and blind (model specific)
 - Removable wear resistant Harewood quality carpet
 - 'Ultra Comfort' luxury deep sprung bed mattress in fixed bed models
 - Lined washroom cubicles in all models
 - Fixed beds with aluminium frames to maximise strength and storage space
 - Hinged seat and bed tops supported in open position for easy access
 - **New** Access flaps in fixed bed surroundings and dayseat ends
 - Mattresses and seat cushions supported by beech slats for extra comfort
 - Seat and backrest ventilation boards
 - Two scatter cushions
 - **New** Luxury curtains with double width fabric on all windows
 - Twin curtain track for improved hanging and ease of use
 - Removable sink drainer with dedicated storage
 - Food grade nylon chopping board with dedicated storage
 - **New** Additional cutlery drawer on smooth steel runner above fridge
 - 32mm thick lightweight washroom door with metal domestic style handle
 - **New** Washroom hanging rail
 - **New** Fabric blinds to washroom window (model specific)
- Equipment**
- ALDE radiator central heating and water heating with daily programming, **new** LCD touch screen control and choice of 1kW, 2kW or **new** 3kW setting
 - ALDE towel radiator in washrooms
 - **New** 20W solar panel fitted as standard
 - 30 litre internal fresh water tank with additional external pump for filling or direct feed to taps
 - Low energy lighting system throughout with ambient over-locker lights, LED task lights and **new** low level night lights

- **New** LED back-lit acrylic sink splash back and kitchen under worktop lighting
 - **New** LED backlights in washroom mirrors
 - LED down lighters set in plinth over kitchen locker
 - Light in wardrobe
 - Six 230V sockets including two in compact new front shelf pod
 - Locker mounted eye level power supply unit & power management for easy access
 - User friendly 12V control panel with battery selection, battery state meter, lighting, water tank level (Twin Axle models) and water pump circuit controls set in decorative housing
 - **New** 8-Series Dometic 110 litre, electronic ignition fridge with removable freezer compartment, black effect finish and digital controls (190 litre in twin axles incorporating 35 litre freezer compartment)
 - Thermostatic oven and separate grill
 - Glass hob lid with safety cut-out feature
 - **New** Omnivent three speed, two way roof fan
 - Thetford C260 toilet with 18 litre wheeled holding tank
 - Inboard semi-rigid fresh water pipes
 - Isolation taps for gas appliances
 - Large bore underslung rigid waste pipes
 - 25 Amp switchmode charger/transformer
 - Status 530 directional Digital / Analogue TV/FM aerial and booster
 - Radio/CD/MP3 player with iPod/MP3 player connection
 - **New** Speakers in washrooms
 - 25 metre mains hook-up cable
 - External 230V mains socket
- Safety and Security**
- AL-KO ATC trailer stability control fitted as standard
 - AKS 3004 Stabiliser
 - Passive infra-red alarm system with tilt sensor and key fob operation
 - Smoke alarm
 - Carbon Monoxide alarm
 - CRIS identity number etched to windows and caravan chassis
 - Concealed security data chip within caravan construction
 - AL-KO secure wheel lock
 - **New** Thatcham approved tracker fitted as standard

- Factory-Fit Option**
- Alternative fabric scheme including the 'Impala' stain-resistant, easy-clean seating fabric with soft nubuck texture
- Dealer-Fit Options**
- Wrap-around seating in addition to drawer chest
 - Dometic B2200 roof-mounted air conditioner (twin-axle models only)
 - Coordinated bedding set for fixed bed layouts

