

# MOTORHOMES



*Grenzenlos wohlfühlen*





# CONTENTS

4	An unlimited sense of comfort and well-being
6	Competencies
8	Overview of models
10	<b>BREVIO</b>
20	<b>TRAVEL VAN</b>
26	<b>SEMI-INTEGRATED MODELS</b> NEXXO TIME - NEXXO
40	<b>IXEO CLASS</b> IXEO TIME - IXEO
54	<b>INTEGRATED MODELS</b> VISEO - ELEGANCE - GRAND PANORAMA
74	<b>ALCOVE MODELS</b> ARGOS
84	Clima Concept
86	Ergonomics Concept
88	Sleep Well Concept
90	Storage Concept
92	Safety Concept
94	Chassis and technology
96	Company and quality
98	Selection of materials
102	Overview of floor plans



# AN UNLIMITED SENSE OF COMFORT AND WELL-BEING ...

## ... FOR COUPLES

No matter whether you are young or young at heart, couples who want to spend the best time of the year together will quickly notice that absolutely nothing is missing in a Bürstner. The interior will indulge your senses with lots of amenities. From the tasteful interior design that you can customise to suit your needs to premium sleeping comfort, you will experience “an unlimited sense of comfort and well-being” as your new travel standard.







## ... FOR ACTIVE ADVENTURERS

Set off on a great expedition in your Bürstner. Experience the spectacular adventure of becoming one with nature and regenerating your body and soul. We strive to create a framework that will completely meet your needs. Our motorhomes give you a base camp for any sporting activity you like. They also provide the sleeping comfort you need to wake up refreshed in the morning and ready to start a new day.

## ... FOR FAMILIES

Escape from your everyday routine and enjoy unforgettable experiences with the entire family. Take time for each other and your hobbies. This is what drives us to develop motorhomes that make unique moments possible. We offer family floor plans that give parents and children their own domains and provide plenty of room to take along everything you might need while on holiday.



# YOUR PERSONAL TASTE IS THE DECIDING FACTOR



# CREATE YOUR VERY OWN STYLE

**38**

Fabrics to choose from



## Innovative and customer-oriented:

- Up to 38 high-quality living designs to choose from
- Greater seating comfort thanks to the new upholstery design
- The back cushions can be removed and cleaned

The new, innovative living design concept from Bürstner gives you the option to add your own personal touch to the interior design. Choose your favourite material from four different upholstery qualities. The combination with the back cushions adds a splash of colour – and harmonises perfectly with the furniture finish.



The back cushions can be attached with a zip on the top and bottom so that they won't slip and can be easily removed for cleaning.

The use of high-quality materials and the skilfully crafted living designs ensure that you will enjoy your individual upholstery selection for a long time to come.

# NEW FURNITURE FINISHES



**2**

Finishes to choose from

In two of our model series you have the option to choose from two furniture finishes.

# 5 EXTERIOR PAINT FINISHES

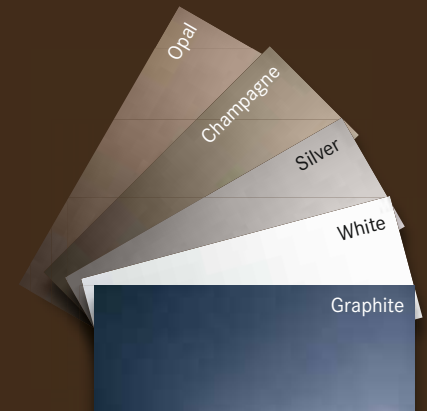

Choose your preferred colour (colour selection depends on the model).



# THE MOTORHOME MANUFACTURER FOR YOUR DREAM VEHICLE

## COMPACT MODELS

Page 10

### BREVIO COMFORT-CLASS



As compact as a panel van but as generously sized as a semi-integrated model.

## COMPACT MODELS

Page 20

### TRAVEL VAN COMFORT-CLASS



Sporty and compact. Ideal for couples who are new to mobile holidays.

## SEMI-INTEGRATED MODELS

Page 26

### NEXXO TIME COMFORT-CLASS



Lots of freedom, lots of fun – low price.

### NEXXO PREMIUM-CLASS



The perfect blend of genuine comfort and sporty compactness.

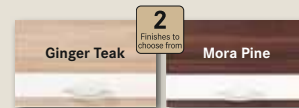

## IXEO CLASS

**THE ORIGINAL  
FROM BÜRSTNER**

Page 40

### IXEO TIME COMFORT-CLASS



For everyone who enjoys travelling with friends or family – at an attractive price.

### IXEO PREMIUM-CLASS



The first semi-integrated model with a fold-down bed: the original from Bürstner.

## NEXXO SOVEREIGN COLLECTION

Three more Nexxo floor plans with attractive extra features in the “Sovereign Collection”. Contact your dealer or go online to [www.buerstner.com](http://www.buerstner.com) to learn more about our special Nexxo “Sovereign” models.



## IXEO TIME SOVEREIGN COLLECTION

Three more Ixeo time floor plans with attractive extra features in the “Sovereign Collection”. Contact your dealer or go online to [www.buerstner.com](http://www.buerstner.com) to learn more about our special Ixeo time “Sovereign” models.

INTEGRATED  
MODELS Page 54

### AVIANO



COMFORT-CLASS

Both inside and out: The comprehensive features will satisfy every demand.

### ELEGANCE



DELUXE-CLASS

For a holiday as elegant as in a 5-star hotel.

### GRAND PANORAMA

FIRST-CLASS

Exclusive views through the large front windscreen and pure luxury on board.

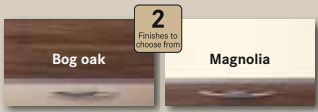

2 Finishes to choose from

ALCOVE  
MODELS Page 74

### ARGOS

DELUXE-CLASS



The year-round motorhome for everyone who spends a lot of time on the road.



Many of our motorhomes do not exceed the 3.5-tonne class.

- For you this means:
- + More loading reserves
  - + Lower fuel consumption
  - + No additional requirements to comply with road traffic regulations

## VEISO SOVEREIGN COLLECTION

Be sure to ask for more information about our Viseo integrated models available in the "Sovereign Collection". Contact your dealer or go online to [www.buerstner.com](http://www.buerstner.com).



## BREVIO

The Brevio is the perfect companion for all kinds of fun, especially if you are the kind of person who not only wants to spend your holiday relaxing but is also up for action and adventure. No matter whether you're travelling in winter or summer, the Brevio is compact and versatile like a panel van but is also as comfortable and spacious as a semi-integrated model. The Brevio combines the benefits of both worlds. Its dynamic lines from the cappuccino to the attractively designed rear give the Brevio its distinctive look.

### Exterior advantages

- + Fiat Ducato low-frame chassis for a higher loading capacity
- + GRP roof for better protection from hail and severe weather
- + Maximum authorised mass (MAM) on all models: 3.5 tonnes
- + Vehicle height only 2.75 m







Brevio t 645

## FREEDOM BEGINS HERE

The Brevio impresses inside with its atmosphere of comfort and well-being. Everything seems so spacious thanks to the straight walls made using modern XPS technology for optimum insulation. This also allows for maximum standing headroom. The second seating area in the back features a comfortable fold-down bed. What's more, the large, fully equipped kitchen will guarantee culinary enjoyment.

### Interior advantages

- ⊕ Berths for up to 4 people (t 645)
- ⊕ Optimum sleeping comfort: cold foam mattresses with special slatted frames in all fixed beds
- ⊕ Spacious storage options thanks to folding beds and fold-down beds





**As compact as a panel van  
and as generously sized as  
a semi-integrated model:**

- ⊕ Low-frame chassis
- ⊕ Up to 735 kg of loading capacity
- ⊕ Large rear hatch with low loading sill
- ⊕ Side walls with XPS insulation
- ⊕ GRP floor with Bürstner lightweight construction technology
- ⊕ GRP roof with less sensitivity to hail
- ⊕ Skyroof over the cab
- ⊕ Electrically operated step
- ⊕ Gas compartment for 2 x 11 kg
- ⊕ Spacious living area
- ⊕ 1.95 m of standing headroom
- ⊕ Spacious compact bathroom
- ⊕ Lots of storage space
- ⊕ Fully equipped kitchen



European Innovation Award for successfully combining a panel van and a semi-integrated model in the Brevio.



## BREVIO – THE FIRST SEMI-INTEGRATED MODEL WITH A REAR HATCH AND A FOLD-DOWN BED

The large rear hatch **1** is perfect for anyone who wants to bring along bulky items without any problems. The fold-down bed in the rear **2** is another added bonus. In a matter of seconds, the sleeping area will be ready for the night. The Brevio class thus comes with four full-size berths in the t 645 model. After all, the seating area under the new fold-down bed can also be converted into a comfortable double bed.

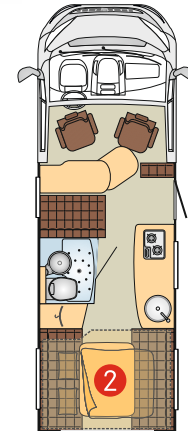

*All images are examples and depend on the model and floor plan.*



## LIVING COMFORT



Brevio t 645

**A room with a view:** Take a seat and enjoy your holiday. Here you will find plenty of space to sit back and relax in comfort. The skyroof brightens up the interior and lets in fresh air. The table can be easily extended in a matter of seconds.



Brevio Performance t 605

## THE JOY OF COOKING



**Spacious comfort:** When you look at your fully equipped kitchen with a hob, fridge and lots of storage space, you'll know that you won't have to do without anything while on holiday.

# SLEEPING COMFORT



1 **Multitalented:** In just a matter of seconds, the fold-down bed lowers to reveal two full-size berths.

2 **A peaceful oasis:** Rubber-supported slatted frames and comfortable cold foam mattresses guarantee a restful night's sleep.

# BATHROOM CULTURE



**A true wonder in terms of space:** When the washbasin is swivelled to the side, you can comfortably shower.



# STANDARD FEATURES (EXCERPTS)



**Multijet II engine technology**  
The engines transmit their power via a 6-speed gearbox.



**Width: 2.10 m**  
The Brevio is even more versatile with a width of just 2.10 m.

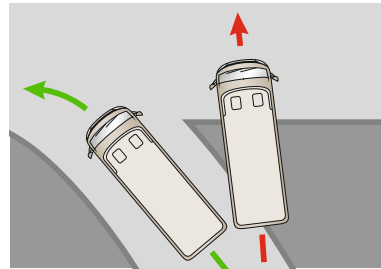

**ABS/ASR**  
For more safety: The tyres will stay in lane when you hit the brakes and will not spin when you accelerate.



**Fiat Ducato low-frame chassis**  
Lightweight but stable to increase the loading capacity and lower the centre of gravity.



**3<sup>rd</sup> brake light in the shape of the logo**  
The third brake light will make sure you are noticed thanks to its brightness and unique design.



**Rear hatch/loading**  
Comfortable loading and unloading made possible thanks to the wide rear hatch and low loading sill.



**Securely transport bulky items**  
Secure larger items with the lashing rings. A track at the top allows the lashing rings to be adjusted as needed.



**Electrically operated step**  
The electrically operated extending step makes it easier to get in and out of the vehicle.



**Awning light**  
LED technology not only brightens things up but is also extremely energy efficient.



**TV mounting bracket**  
A TV mounting bracket has already been integrated so you can keep up with your favourite shows.



**XPS side walls**  
We have used tried and tested light-weight construction technologies to significantly reduce the unladen weight of our vehicles while still maintaining the highest level of quality and insulation.



**Airbags**  
The safety technology will protect you in the event of an accident. A driver airbag comes as standard in all Brevio models. A passenger airbag is also an available option.



**Power windows**  
Need some fresh air? Then just press the button (available in an optional wood finish).



**Driver and passenger seats**  
The driver and passenger seats in the Brevio are upholstered in the same design as the interior as a standard feature. The height and tilt are adjustable.



**Upholstery options**  
Add your very own personal touch to the living space with your choice of 36 living designs.





Skyroof

**Skyroof**  
The skyroof over the cab brightens up the entire seating area and lets in fresh air.



Clima-Concept

**Mini Heki skylight**  
More light, more air – more comfort thanks to the Mini Heki skylight. Also available in the larger Midi Heki option upon request.



**Halogen spotlights and 12V reading spotlights**  
Light in all the right places. The spotlights can be tilted and moved along the track as needed.



**Steps to the fold-down bed**  
Steps make getting into bed even easier. You will also find extra storage space in the steps to keep your shoes within reach (t 605).



Storage-Concept

**Storage compartments under the single beds**  
You'll find lots of storage space under the bed (t 640).



Storage-Concept

**Illuminated wardrobe**  
Be well organised while on holiday. Thanks to the light installed in the wardrobe, you'll find what you're looking for in no time – even at night.



**Sliding toilet**  
In a matter of seconds, you can slide the toilet to the side for more room to shower (t 640).



Storage-Concept

**Storage compartment under the floor**  
A practical use of space thanks to the extra storage compartment integrated into the floor.



**A footrest in the entrance area**  
The footrest folds out to expand your seating area. Put your legs up and relax.

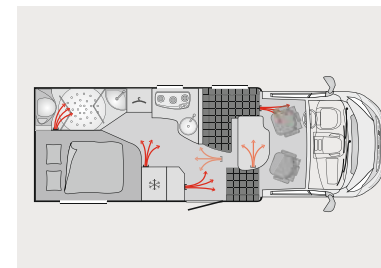

**Truma warm air heating system**  
The quiet and powerful fans guarantee the optimum distribution of warm air inside.



Sleep-well-Concept

**5-star sleeping comfort**  
More information about the Sleep Well Concept can be found on page 88.

## STANDARD FEATURES (EXCERPTS)

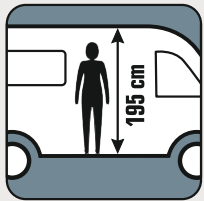

**1.95 m of standing headroom** means that even tall people can move around inside the vehicle in comfort.



**3.5-tonne class**  
Conserve fuel and enjoy the advantages of a Bürstner even with a Class B driving licence.



**GRP floor**  
Impact-resistant, glass-fibre-reinforced plastic floor, insulating and rot-resistant.



**Four full-size berths** – the fold-down bed and seating area that converts into a double bed make it possible for four people to sleep in comfort (t 645).



**GRP roof:** The glass-fibre-reinforced plastic (GRP) roof for better protection from hail and severe weather.

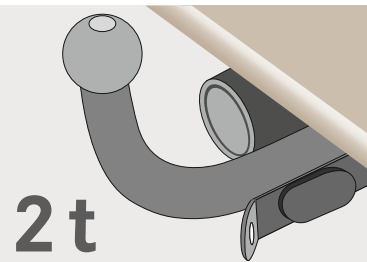

**Two-tonne trailing load:** With the Brevio, you can take along your boat, motorcycle or whatever you like (trailer hitch optional).



Development, production and sales are certified according to the international standard ISO 9001:2008.



Each Bürstner motorhome is covered by a comprehensive warranty for two years from the date of purchase.



We offer a five-year water ingress guarantee for your motorhome with an annual inspection (requires payment).

## ACCESSORIES (EXCERPTS)



**Alloy rims**  
The alloy rims not only cut down on weight but are also sporty.



**Bike rack**  
The bike rack can be swivelled to the side – even with bikes on it.



**Cruise control**  
The cruise control makes abiding by the speed limit easy and effortless.

Winter package\*



Wastewater tank and drainage insulated and heated, electric floor heating, electric auxiliary heating for the Truma Combi 4 system, heated driver and front passenger seats, exterior winter insulation mat, a second 90 Ah cabin battery.

Design package\*



Alloy rims, one-piece cabin door with window and window screen (Hartal Premium), special paint finish.

Chassis package\*



Passenger airbag, electrically adjustable and heated door mirrors, cab air conditioning including particle filter, cruise control.

\*Information about the packages can be found in the "Technical specifications".

# Performance

## BREVIO PERFORMANCE 15"-PACKAGE

- + 15" alloy rims
- + Performance silver special paint finish
- + Leather steering wheel and leather gearstick knob
- + Dashboard finishing in an aluminium look
- + Product graphics in black
- + LED daytime running lights
- + Rear window
- + Truffo Elm furniture finish
- + Base upholstery: Bianca/Harlow

## BREVIO PERFORMANCE 17"-PACKAGE

- + 17" alloy rims
- + Wheel arch extensions (high-gloss, black)
- + Performance silver special paint finish
- + Leather steering wheel and leather gearstick knob
- + Dashboard finishing in an aluminium look
- + Product graphics in black
- + LED daytime running lights
- + Rear window
- + Truffo Elm furniture finish
- + Base upholstery: Bianca/Harlow

## EXTERIOR COLOURS

### BREVIO

White (standard)

Silver

Pictured with the Performance package (optional)

Champagne



## FLOOR PLANS

t 605

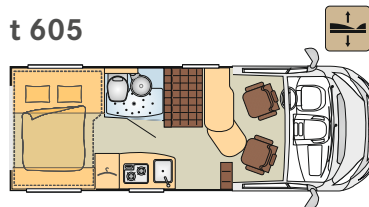

t 640

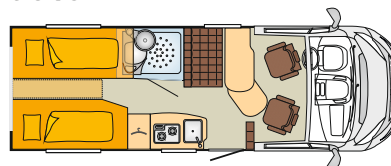

t 645

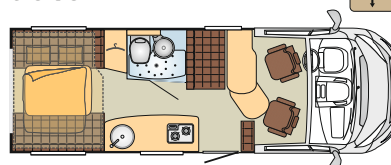

## ADVANTAGES

- + 3 paint finishes available, smooth metal panelling
- + 36 upholstery designs to choose from (at no extra charge)
- + Compact size
- + Side walls with XPS insulation
- + Truma Combi 4 heater
- + Large rear hatch
- + Low-frame chassis
- + GRP floor with Bürstner lightweight construction technology
- + 2 t trailing load
- + Skyroof in the cab
- + Spacious interior with straight walls and more standing headroom
- + Lashing rails in the rear
- + Lots of storage space
- + Rotating pilot seats in the same design as the living area
- + Fold-down beds with cold foam mattresses (t 605 and t 645)



t 605 +  
t 645



100 l



90 l



Explanatory legend on the fold-out page on the back





## TRAVEL VAN

Let your imagination run wild when you plan your holiday. The completely revamped Travel Van will make travelling truly enjoyable, thanks in part to the many well-thought-out and tested concepts in Bürstner's new "Comfort" strategy. Its compact exterior dimensions will give you a sporty, versatile ride on coastal highways, tightly winding roads and narrow city streets. The sporty exterior design with the sweeping lines of the cappuccino and rounded roof edges, the new Bürstner front end and the comfortable low-frame chassis stand for pure driving dynamics.

### Exterior advantages

- + Low-frame chassis
- + GRP roof for better protection from hail and severe weather
- + Maximum authorised mass (MAM) on all models: 3.5 tonnes
- + Standing headroom: 1.98 m
- + Service unit

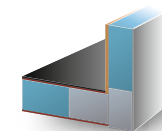

Wood-free design  
with XPS insulation





Travel Van t 590 G

## NICE AND BRIGHT

The interior of the new Travel Van is characterised by an attractive, highly functional design. The two-tone furniture fronts emphasise the interior's modern look.

When it comes to variety and individuality, Bürstner is a clear trendsetter. Choose from 38 living designs to express your personal style. The clever lighting concept with adjustable LED spotlights and indirect lighting creates just the right atmosphere to suit your mood.

### Interior advantages

- + Berths for up to 3 people
- + Optimum sleeping comfort: cold foam mattresses with special slatted frames in all fixed beds
- + New furniture concept in a light Ginger Teak finish
- + Closed wardrobe in the entry area







Light and airy: The large skyroof XL (optional) floods the interior with fresh daylight. And thanks to 1.98 metres of standing headroom, you'll have enough space to move around as you like.

Comfort and food go together. The three-burner gas hob with a glass cover will make cooking a sheer delight. Everything will find a permanent home in the kitchen cabinets with deep, soft-close drawers. The new 145-litre fridge (t 690 G) has enough room for you to always have your favourite specialities on board.



# SLEEPING COMFORT



Travel Van t 620 G



Travel Van t 590 G



Travel Van t 590 G

**It all makes sense:** The step not only helps you get into bed comfortably but also contains extra storage space – without inhibiting access to the bathroom.

**A hideaway for your clothes:** A space-saving wardrobe is located underneath the laterally installed double bed.

# BATHROOM CULTURE



**A true wonder in terms of space:** The bathroom in the Travel Van has twice as much to offer. The entire washbasin area including the base cabinet can be simply swivelled to the side to create lots of room for extensive showering pleasure. The warm air vents in the bathroom are not only practical but also suitable for winter. When it's cold outside, the bathroom will be warm and cosy – even before you get into the shower. The roof light allows for ventilation.





# STANDARD FEATURES (EXCERPTS)



## Multijet II engine technology

The engines transmit their power via a 6-speed gearbox.

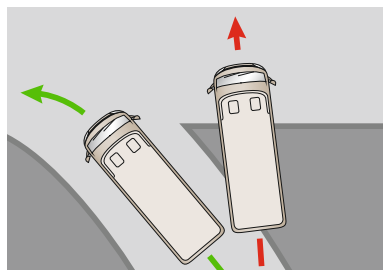

## ABS/ASR

For more safety: The tyres will stay in lane when you hit the brakes and will not spin when you accelerate.



## Fiat Ducato low-frame chassis

Lightweight but stable to increase the loading capacity and lower the centre of gravity.

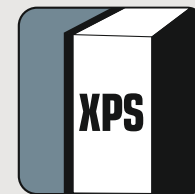

## XPS side walls

We have used tried and tested lightweight construction technologies to significantly reduce the unladen weight of our vehicles while still maintaining the highest level of quality and insulation.

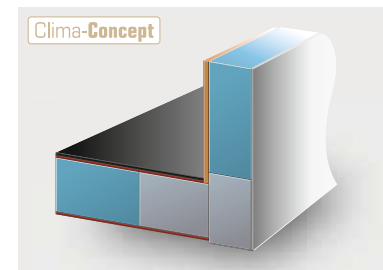

## Wood-free design with XPS insulation

More information about the Clima Concept can be found on page 84.



## GRP roof

The glass-fibre-reinforced plastic (GRP) roof for better protection from hail and severe weather.



## Rounded roof

The tops of the walls are nicely rounded where they connect with the GRP roof.



## Service unit

Now all of the service connections can be conveniently accessed in one place.



## Rear garage

With its spacious dimensions, the rear garage offers lots of room and easy access.



## TV mounting bracket

Ready to easily install your TV.



## 5-star sleeping comfort

More information about the Sleep Well Concept can be found on page 88.



## Driver and passenger seats

The driver and passenger seats in the Brevio are upholstered in the same design as the interior as a standard feature. The height and tilt are adjustable.



## A wardrobe in the entry area

This makes changing clothes easy. You'll have the right outfit for any weather conveniently within reach.



## Seating group converts into a bed

Cosy seats during the day and a comfortable bed at night. Easy and practical.

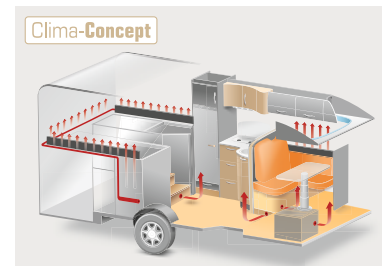

## Heating in the living area

The heating system guarantees the optimum distribution of heat throughout the entire vehicle.



**Aluminium frame windows**

The aerodynamic design of the tinted windows with flush-fitting aluminium frames minimises wind resistance and wind noise.



**Door sills**

Striking sills on the driver's and passenger's doors emphasise the dynamic character of the Travel Van.



**Perfect lighting**

In XL format – for more light and fresh air inside the vehicle.

TRAVEL VAN

White (standard)

Graphite

Silver

Champagne



FLOOR PLANS

t 590 G

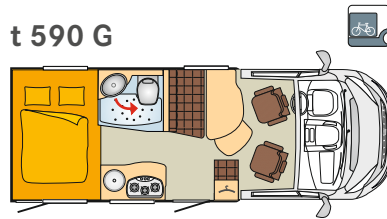

t 620 G

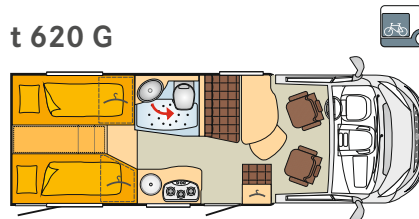

t 690 G

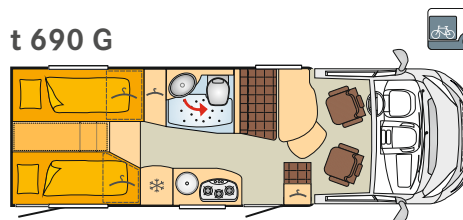

ADVANTAGES

- + Aerodynamic design
- + Up to 3 berths
- + Compact size, exterior width only 2.20 m
- + 4 exterior paint finishes to choose from
- + 2-tonne trailing load
- + Well-thought-out space concept
- + At least one single bed over 200 cm long
- + 38 upholstery designs available
- + Rotating pilot seats in the upholstery design
- + Adjustable and extendable table top
- + Pleated blackout blinds in the cab
- + Flexo Bathroom
- + Flush-fitted hob with glass cover
- + Midi Heki skylight
- + Lockable service hatches
- + Electrically operated step
- + Options: Chassis package, Design package, Ambience package, Winter package

● Fixed bed  
 ● Seating areas  
 ● Bathroom/toilet  
 ● Table/cabinets/shelves  
 Wardrobe  
 Refrigerator (freestanding)  
 Garage version

38  
Fabrics to  
choose from



90 l



60/110 l



Explanatory  
legend on the  
fold-out page  
on the back





# SEMI-INTEGRATED MODELS

## SPORTY AND COMPACT

Unstoppable on your way to your holiday destination: Welcome to the class of semi-integrated models. A semi-integrated motorhome offers nearly the same living quality as a fully integrated motorhome at a comparatively lower cost.

Büirstner combines the standard cab of the Fiat Ducato with the living area, which is made possible thanks to the 180° rotating pilot seats.

All semi-integrated models are constructed for optimum aerodynamics, which not only cuts down on fuel consumption but also enhances the sporty look. Thanks to their compact dimensions, these vehicles can master even tight curves and narrow roads, thus giving you plenty of freedom to be spontaneous.

Büirstner gives you the choice of two model series: the compact Nexxo time and the larger Nexxo.





## NEXXO TIME

A breath of fresh air in the semi-integrated class: The Nexxo time is the latest development from Bürstner, fulfilling every wish and demand when it comes to enjoying “an unlimited sense of comfort and well-being” from the very start. Six models – all of which are under 7 m long – are available to choose from. All models come with clear advantages in terms of functionality, design and price as standard.

### Exterior advantages

- + Low-frame chassis for a higher loading capacity
- + Maximum authorised mass (MAM) on all models: 3.5 tonnes
- + Low vehicle height of 2.75 m
- + Standing headroom: 1.95 m
- + Coupe entry to make it easier to get in and out of the vehicle





Nexxo time t 685

## COMPACT CAN BE THIS COMFORTABLE

Comfortably step through the XL door to access the spacious interior. The comfort continues here: The semi-dinette or the optional L-shaped seating area will invite you to linger. The optimised heating system ensures just the right climate. Positioned underneath the seating area, you'll feel heat where you need it. No matter which floor plan you choose, the new Clima Concept has been implemented in all models.

### Interior advantages

- ⊕ New furniture concept in a modern Truffo Ros finish
- ⊕ Optimum sleeping comfort: cold foam mattresses with special slatted frames in all fixed beds
- ⊕ A new 145-litre fridge (depending on the floor plan)
- ⊕ Optimised heating system, standard: Truma Combi 4





## LIVING COMFORT



Nexxo time t 670 G

## THE JOY OF COOKING



Nexxo time t 685



**True greatness comes from within:** The large fridge with narrow exterior dimensions holds up to 145 litres. The hob with electric ignition is set further back to create a bigger work surface in the front. Even the sink impresses with its depth. Cooking is a real pleasure in the Nexxo time.



## SLEEPING COMFORT



**1 Easy up:** The steps make it easy and safe for you to get into your comfortable bed with a Super-Flex cold foam mattress and anti-allergenic mattress ticking. One of the beds is at least 2 m long. After an exciting day of adventures, the reading spotlights create the right mood to curl up with a nice book before turning in for the night.

**2 A sensible use of space:** You'll find storage almost everywhere. There's even a wardrobe for all of your clothes under the beds and storage in the top step.

## BATHROOM CULTURE



**3 An XL shower experience:** The Vario Bathroom always makes optimum use of space. To shower, simply swivel the wash basin to the side. The tap with an extendible hose turns into a showerhead.





## NEXXO

A classic and bestseller in one: The new Nexxo combines clear and high design standards with functionality and ergonomics. It will please everyone, both those who are always searching for that new special place and those who have already found it. Thanks to its excellent road performance, every kilometre of road will be part of your holiday. Plus, the well-thought-out floor plans will pamper you with many attractive and practical details. It's not without good reason that this is one of the most popular motorhomes in the Bürstner fleet.

### Exterior advantages

- + Low-frame chassis for a higher loading capacity
- + Maximum authorised mass (MAM) on all models: 3.5 tonnes
- + Vehicle height only 2.75 m
- + Coupe entry to make it easier to get in and out of the vehicle

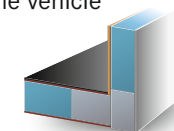

Wood-free design  
with XPS insulation





Nexxo t 745

## TAILORED TO YOUR WISHES

You could hardly ask for more choice: With 5 different floor plans for the Nexxo (+ 3 more in the “Sovereign Collection”), you can add your own individual touch by selecting from two furniture finishes and 38 living designs to make the interior just the way you like. The rotating pilot chairs are upholstered in the same design as the interior to integrate perfectly into the cosy ambience.

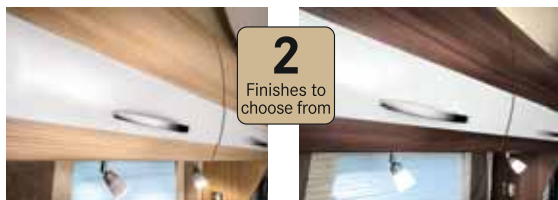

Ginger Teak

Mora Pine

### Interior advantages

- + Improved standing headroom: 198 cm
- + Optimum sleeping comfort: cold foam mattresses with special slatted frames in all fixed beds
- + A new 145-litre fridge
- + New furniture concept available in 2 options (Ginger Teak or Mora Pine)
- + Optimised heating system, standard: Truma Combi 6







1

**1 Well thought out:** The table top can be easily moved for an optimum use of space. The same is true for the television, which simply disappears behind the storage cabinet when not in use.



2

**2 Design meets ergonomics:** The rounded overhead cabinets in the kitchen are perfect for their intended purpose. Practical pull-out drawers even have enough room for 1.5-litre bottles. Feel at home thanks to metal tracks and soft-close features.

# SLEEPING COMFORT



**1 Sleep like royalty:** Thanks to optimised side access, you can comfortably get into the permanently installed queen-size bed measuring 200 cm.

**2 For a comfortable start to the night:** The convenient step solution makes getting in bed easy.



**3 Even more function:** Thanks to Easy-Flex, you can adjust the headboard to your desired position. Take advantage of the practical spotlights for your nightly read.

# BATHROOM CULTURE



**Make room:** The Flexo Bathroom makes it possible to swivel the entire wash basin area

and base cabinet to the side to create room for extensive showering pleasure.



# STANDARD FEATURES (EXCERPTS)



## Multijet II engine technology

The engines transmit their power via a 6-speed gearbox.

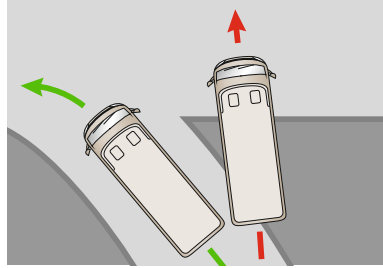

## ABS/ASR

For more safety: The tyres will stay in lane when you hit the brakes and will not spin when you accelerate.



## Fiat Ducato low-frame chassis

Lightweight but stable to increase the loading capacity and lower the centre of gravity.



## Wide-track rear axle

Greater driving stability and spaciousness are ensured thanks to the widely spaced wheel arches.



## XPS side walls

We have used tried and tested lightweight construction technologies to reduce the unladen weight of our vehicles while still maintaining the highest level of quality and insulation (not Nexxo time).



## GRP roof

The glass-fibre-reinforced plastic (GRP) roof for better protection from hail and severe weather.



## Rear spoiler

Enhanced rear with a new design.



## Cappuccino

The sleek cappuccino shines in a new design with rounded roof edges.



## Rounded roof

For an even nicer transition between the side walls and roof.



## Service unit

All important controls for on-board utilities and waste disposal are easily accessible in a central location.



## Aluminium frame windows

The aerodynamic design of the tinted windows with flush-fitting aluminium frames minimises wind resistance and wind noise (only on the Nexxo).



## Awning light

LED technology not only brightens things up but is also extremely energy efficient.



## Rear garage

Those who enjoy being athletic while on holiday will find plenty of secure space for their bikes in models with a rear garage.



## Coupe entry

The low entry makes it easier to get in and out of the vehicle.



## Driver and passenger seats

The driver and passenger seats in the Nexxo are upholstered in the same design as the interior as a standard feature (not available on the Nexxo time).



**XL cabin door**  
The XL coupe entry is now even more convenient. With a 1-point locking mechanism and integrated waste bin.



**New hob**  
The new hob now comes with electric ignition as standard.



**Soft-close drawers**  
The same comfort as at home thanks to soft-close technology.



**Rounded overhead cabinets**  
To give you more standing headroom, the cabinets above the kitchenette are now rounded without losing any of their depth (only in the Nexxo).



**5-star sleeping comfort**  
More information about the Sleep Well Concept can be found on page 88.



**Illuminated entry rail**  
The backlit entry rail provides more safety, even in the dark.

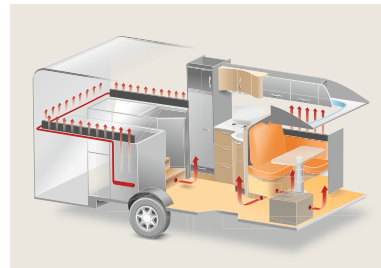

**Heating in the living area**  
The heating system guarantees the optimum distribution of heat throughout the entire vehicle.



**Upholstery options**  
Add your very own personal touch to the interior with 38 living designs to choose from.

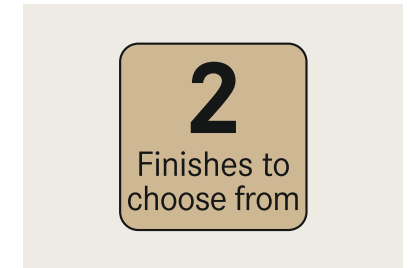

**2 finishes to choose from**  
You can choose from two finishes (only in the Nexxo).

## ACCESSORIES (EXCERPTS)



**Mini Heki skylight**  
More light, more air – more comfort thanks to the Mini Heki skylight.

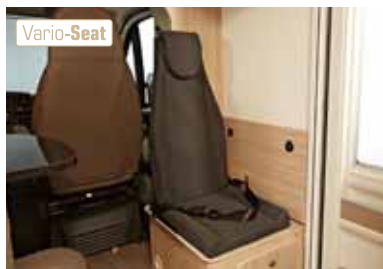

**A fifth seat with a seat belt**  
In just a matter of seconds, you'll have an extra seat with a seat belt for one more passenger (not available on the t 685).



**A flexible table top**  
Can be moved and folded up – for an optimum use of space (depending on the model and floor plan).



**Child's seat**  
Simply fold up the table and you'll have more room for a seat-belt-secured child's car seat (depending on the model and floor plan).



**Skyroof XL premium**  
For maximum light: the Midi-Heki and the skyroof XL with integrated LED lighting (only in the Nexxo).



# EXTERIOR COLOURS

## NEXXO TIME

White (standard)

Graphite

Champagne



## NEXXO

White (standard)

Champagne

Graphite

Silver



## NEXXO TIME

t 569

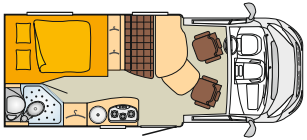

t 670 G

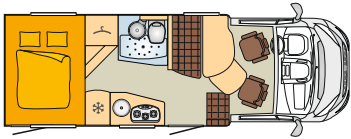

t 660

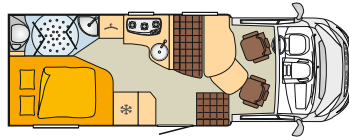

t 685

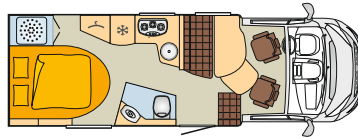

t 665

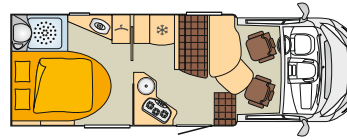

t 690 G

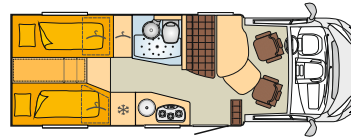

## NEXXO

t 685

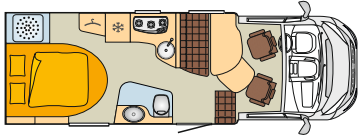

t 729

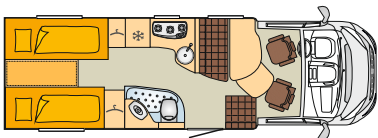

t 720

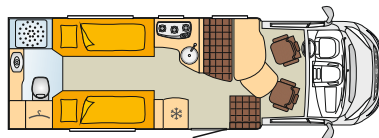

t 745

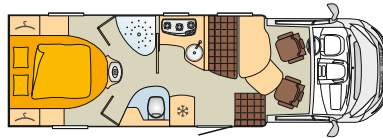

t 728 G

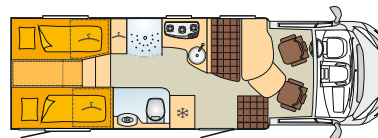

### NEXXO SOVEREIGN COLLECTION

3 more Nexxo floor plans with attractive extra features in the "Sovereign Collection". Contact your dealer or go online to [www.buerstner.com](http://www.buerstner.com) to learn more about our special Nexxo "Sovereign" models.

## NEXXO TIME

- + Low-frame chassis with wide-track rear axle
- + 3 paint finishes to choose from
- + XL cabin door with 1-point locking mechanism and a waste bin
- + Coupe entry
- + Pleated blackout blinds in the cab
- + 38 upholstery designs available
- + Fixed beds with slatted frames and cold foam mattresses
- + Fitted sheets for all bed options (standard)
- + Mounting bracket for flatscreen TV (some up to 21")
- + Lockable service unit
- + LED awning light

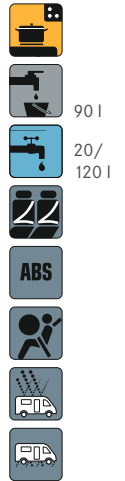

## NEXXO

- + Low-frame chassis with wide-track rear axle
- + 4 paint finishes to choose from
- + Available in 2 different furniture finishes
- + Coupe entry
- + Pleated blackout blinds in the cab
- + Rotating pilot seats in the same design as the living area
- + Large skyroof for more light in the seating area
- + Height and tilt of driver and passenger seats can be adjusted
- + 38 upholstery designs available
- + Fixed beds with slatted frames and cold foam mattresses
- + Fitted sheets for all bed options (standard)
- + Mounting bracket for flatscreen TV (some up to 21")
- + Lockable service unit
- + LED awning light



Explanatory legend on the fold-out page on the back



# IXEO CLASS

THE ORIGINAL  
FROM BÜBSTNER



## SLEEK AND EFFICIENT ON THE ROAD

The comparably low total height of only 2.75 m as well as its flowing, aerodynamic design give the Ixeo class top marks when it comes to wind resistance. Not only is the engine power used more efficiently, thus

lowering fuel consumption, but sensitivity to lateral wind and wind noise are also reduced. These are the basic prerequisites for a pleasant holiday journey – even over long distances.

## SEMI-INTEGRATED MODELS WITH A FOLD-DOWN BED



Invented by Bürstner, semi-integrated models with a fold-down bed have become the best-selling class of motorhomes in Europe within a very short time. And with good reason: Never before could up to six people enjoy an unlimited sense of comfort and well-being in a compact motorhome. In the Ixeo time, the childproof fold-down bed is located above the seating area. The ceiling electrically lowers straight down (down to the level of the bench in the Ixeo time it 586 and it 590) to reveal two full-size, easily accessible berths.

Variable positioning

In the Ixeo time it 586 and it 590, the bed lowers down to the level of the bench for easy access

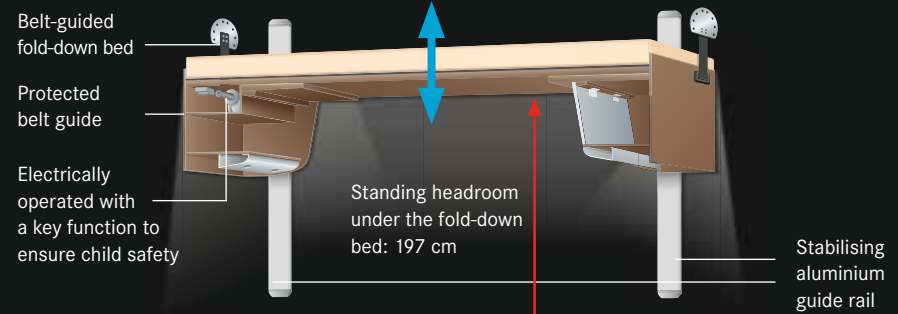

Model illustration of the fold-down bed function in the Ixeo time it 586 and it 590





## IXEO TIME

Why complicate things when they can be simple: With the Ixeo time, simplicity can be fun. The Ixeo time boasts a clear exterior design, appealing exterior and improved functionality, which has been realised in many clever ideas such as the fold-down bed. All of that stands for pure holiday pleasure – whether as a couple, with your family or with friends. Not only that, but focussing on the essential has another advantage in the shape of the affordable price.

### Exterior advantages

- + Low-frame chassis for a higher loading capacity
- + GRP roof for better protection from hail and severe weather
- + Maximum authorised mass (MAM) on all models: 3.5 tonnes
- + Vehicle height only 2.75 m
- + XL cabin door and coupe entry to make it easier to get in and out of the vehicle





Ixeo time it 590

## PLENTY OF ROOM TO MAKE YOURSELF AT HOME

As soon as you get into the Ixeo time, you'll notice that there is more room inside than its compact exterior dimensions might suggest. Even larger groups can sit together comfortably since the combination of the L-shaped seating area, side bench and rotating driver and passenger seats offer a lot of room. Large windows also flood the interior with lots of light and air.

### Interior advantages

- + Unique spatial concept with up to 6 berths
- + Interior standing headroom up to 2.00 m
- + Optimum sleeping comfort: cold foam mattresses with special slatted frames in the fixed bed and fold-down bed
- + Fold-down bed with a spacious surface
- + Optimised heating system





## LIVING COMFORT



Ixeo time it 590

## THE JOY OF COOKING



Ixeo time it 726 G

**Tasteful across the board:** The kitchens in the Ixeo time combine sleek elegance with pure ergonomics. All of your kitchen utensils will be conveniently within reach in the

spacious drawers. The 3-burner gas hob with electric ignition comes with a glass cover to expand the work surface. The 145-litre fridge has room for everything you need.



1 **Comfortable access:** The fold-down bed lowers down to the level of the seating area (it 586 and it 590).

2 **A step up:** Use the steps to easily get into one of the 2 m beds.

**An optimum use of space:** The bathroom not only has plenty of room to move around but also a lot of storage. Part of the spacious wardrobe in the bathroom can also be used as a storage compartment from outside.





## IXEO

THE ORIGINAL  
FROM BÜSTNER

The Ixeo set new standards as the first motorhome with a fold-down bed over the seating area and has been able to maintain its leading position in this class ever since. With the gently sweeping silhouette of the cappuccino, the Ixeo is also ahead of the game when it comes to aerodynamics and design. With its many special features – such as the large skyroof – that already come as standard, all three Ixeo floor plans will satisfy every demand for a successful holiday.

### Exterior advantages

- + Low-frame chassis for a higher loading capacity
- + Wide-track chassis on the rear axle with outstanding handling
- + Maximum authorised mass (MAM) on all models: 3.5 tonnes
- + Vehicle height only 2.75 m
- + Coupe entry to make it easier to get in and out of the vehicle





Ixeo it 664

## DESIGN AND FUNCTIONALITY IN PERFECT HARMONY

The flowing design of the overhead cabinets with hidden locks immediately stands out, giving the interior a bright, friendly ambience. The fold-down bed is inconspicuously integrated into the living area. A cosy bed at night and a design element during the day that brightens up the seating area perfectly with its numerous spotlights.

### Interior advantages

- + Interior standing headroom up to 2.00 m
- + Optimum sleeping comfort: cold foam mattresses with special slatted frames in the fixed bed and fold-down bed
- + Fold-down bed with a spacious surface
- + Truma heating system for the optimal distribution of warm air
- + Rotating pilot seats in the same design as the living area (height and tilt are adjustable)

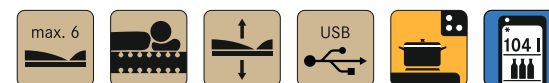



## LIVING COMFORT



**Quality you can touch and feel:** The drawers with roller-mounted metal tracks impress with their durability. The stainless steel sink with a large drying area and integrated

## THE JOY OF COOKING



LED spotlights above the work surface will make your eyes light up. The optional TEC Tower features a large fridge with a separate freezer compartment as well as an oven.

## SLEEPING COMFORT



**Deep sleep zone:** The spacious fold-down bed over the seating area can be easily lowered down and comes with a cold foam mattress as standard to guarantee a good night's sleep. Simply open the skyroof to let in light and air.

## BATHROOM CULTURE



**Sleep better:** The large double bed with a flexible slatted frame is perfect for relaxing at any time of day, not just at night. It's also just a few steps away from the bathroom.



# STANDARD FEATURES (EXCERPTS)



## Multijet II engine technology

The engines transmit their power via a 6-speed gearbox.

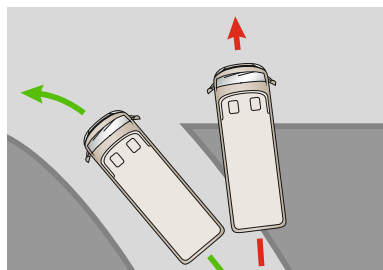

## ABS/ASR

For more safety: The tyres will stay in lane when you hit the brakes and will not spin when you accelerate.



## Low-frame chassis

Lightweight but stable to increase the loading capacity and lower the centre of gravity.



## Wide-track rear axle

Greater driving stability and spaciousness are ensured thanks to the widely spaced wheel arches.



## 3<sup>rd</sup> brake light

Make a statement: The third brake light will make sure you are noticed thanks to its brightness and unique design.



## Airbag

The safety technology will protect you in the event of an accident. A driver airbag comes as standard in all semi-integrated models.



## Remote-controlled central locking system

For more comfort and security (only available as a cabin door option in combination with the premium XL cabin door, only on the Ixeo time).



## Painted front spoiler

The front spoiler is painted the same colour as the vehicle to enhance the high-quality overall impression.



## GRP roof

The glass-fibre-reinforced plastic (GRP) roof for better protection from hail and severe weather.



## Service unit

All important controls for on-board utilities and waste disposal are easily accessible in a central location.



## Awning light

LED technology not only brightens things up but is also extremely energy efficient.



## Storage compartment in the rear

The extra storage compartment in the rear can be easily accessed from both inside and out (Ixeo time it 590).



## Storage compartment under the seating area

The storage compartment can also be easily loaded and unloaded from the outside (Ixeo time it 586 and it 590).



## Gas hob

The 3-burner gas hob comes with a glass cover to expand the work surface.



## Driver and passenger seats

The driver and passenger seats in the Ixeo are upholstered in the same design as the interior as a standard feature.

**Vario-Seat**

**A fifth seat with a seat belt**  
In just a matter of seconds, you'll have an extra seat with a seat belt for one more passenger.

**Clima-Concept**

**Midi Heki skylight**  
The easily accessible Midi Heki in the roof gives the interior more light.

**Electric fold-down bed**

Spacious bed dimensions, high-quality Super-Flex cold foam mattress and easy operation for lowering and raising (Ixeo time it 586 and it 590).

**Child safety feature**

New electrically operated fold-down bed with key function to ensure child safety (Ixeo time it 586 and it 590).

**Sleep-well-Concept**

**5-star sleeping comfort**  
More information about the Sleep Well Concept can be found on page 88.

**USB port**

A USB connection via the 230 V socket supplies electricity to charge your smartphone or tablet.

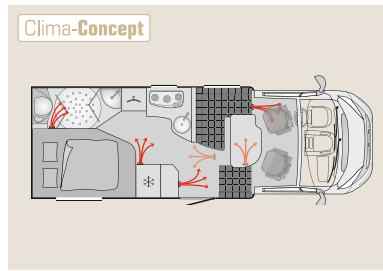
**Clima-Concept**

**Heating in the living area**  
The heating system guarantees the optimum distribution of heat throughout the entire vehicle.

**Upholstery options**

Add your very own personal touch to the interior with 38 living designs to choose from.

**Useability-Concept**

**Coupe entry**  
The low entry makes it easier to get in and out of the vehicle.

**Good entertainment**

There's room for your TV (up to 21") in the chic TV cabinet so that you won't miss your favourite show.

## ACCESSORIES (EXCERPTS)

**Alloy rims**

The alloy rims not only cut down on weight but are also sporty.

**Safety-Concept**

**Passenger airbag**  
A passenger airbag is also available as an option on all models.

**Cruise control**

The cruise control makes abiding by the speed limit easy and effortless.

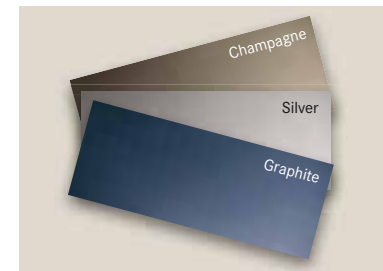
**Paint options**

Three optional colours are available to choose from (options depend on the model).

**Oven/grill**

For cooking as comfortably as at home.



# EXTERIOR COLOURS

## IXEO TIME

White (standard)



Graphite



Champagne



## IXEO

Champagne



White (standard)



Graphite



Silver



## IXEO TIME

it 590

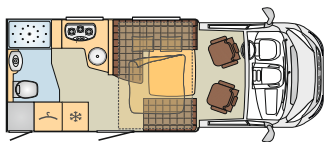

it 710 G

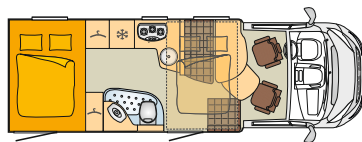

### IXEO TIME SOVEREIGN COLLECTION

3 more Ixeo time floor plans with attractive extra features in the “Sovereign Collection”. Contact your dealer or go online to [www.buerstner.com](http://www.buerstner.com) to learn more about our special Ixeo time “Sovereign” models.

## IXEO TIME

- + Low-frame chassis with wide-track rear axle
- + Unique spatial concept with up to six berths
- + Maximum authorised mass (MAM) on all models: 3.5 tonnes
- + Vehicle height only 2.75 m
- + Interior standing headroom up to 2.00 m
- + Driver airbag
- + Cold foam mattress with special slatted frame in the fixed bed and fold-down bed
- + Coupe entry
- + The height and tilt of the driver’s seat can be adjusted
- + 120/20l water tank (for variable use)



## IXEO

it 664

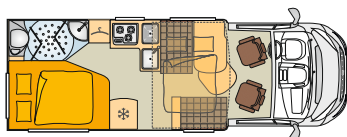

it 735

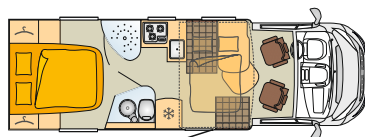

## IXEO

- + Wide-track chassis with outstanding handling
- + Diesel particulate filter
- + Maximum authorised mass (MAM) on all models: 3.5 tonnes
- + Available in 4 different exterior paint finishes
- + Coupe entry
- + Rotating pilot seats in the same design as the living area (height and tilt are adjustable)
- + Pleated blackout blinds in the cab
- + Convenient heating/warm water supply (Truma)
- + Fixed beds with Super-Flex cold foam mattresses
- + Ventilated storage cabinets (Air Plus)
- + Skyroof
- + 12/230V sockets

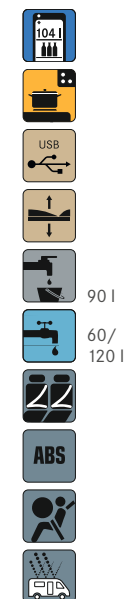





# INTEGRATED MODELS

## BÜRSTNER'S ELITE CLASS

Fully integrated motorhomes are referred to as the “elite class”. They offer a unique sense of spaciousness in the large living area thanks to the seamless transition between the cab and the interior.

### Advantages and characteristics of integrated models:

- + Distinctive look
- + Panoramic experience thanks to the large windscreen
- + Spacious living area
- + The fold-down bed disappears above the cab
- + High roof in the cab
- + Good insulation for the perfect interior temperature
- + Complete high-quality furnishings

## WISEO

### SOVEREIGN COLLECTION

Bürstner not only makes this kind of luxury something you can experience; it also makes it affordable. In the 2015 season, the Viseo “Sovereign” is an attractive option to introduce you to the elite class. It impresses with many extra features at an especially attractive price. More information about the “Sovereign Collection” is available at [www.buerstner.com](http://www.buerstner.com) or in our separate brochure.

## A PERFECT ALL-ROUND VIEW

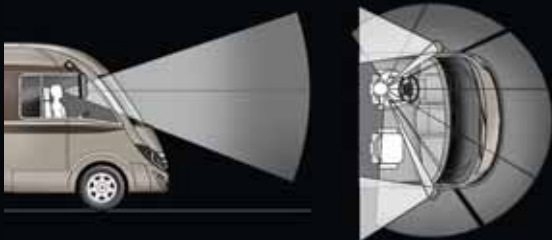

A safe ride means having the best view of everything happening on the road. The integrated models impress with their optimised field of vision thanks to the low windscreen and the narrow A-pillar. The combination of large side mirrors and windows means that you'll hardly have any blind spots when you look behind you.





## AVIANO

With its striking front and LED daytime running lights, the Aviano is classy and clearly part of the elite class. Its chic exterior design will turn heads wherever it goes. This won't only make you especially confident while on the road but also especially safe thanks to the wide-track chassis.

Both on the inside and outside, the Aviano scores points thanks to its comprehensive furnishings, which are sure to satisfy sophisticated demands. If you expect more from an integrated model, you should step inside the Aviano.

### Exterior advantages

- + AL-KO chassis with wide-track rear axle
- + GRP roof for better protection from hail and severe weather
- + Vehicle height only 2.75 m
- + XL premium cabin door (i 840 G)





## LOTS OF ROOM TO ENJOY

No matter whether you feel like spending a cosy night together as a couple or inviting friends over: The tastefully designed living area in the Aviano offers plenty of space. When the pilot seats in the cab are turned 180°, a genuine oasis of well-being is created in combination with the L-shaped seating area.

### Interior advantages

- + Rotating pilot seats in the same design as the living area
- + Now with the Truma Combi 6 heating system
- + Optimum sleeping comfort: cold foam mattresses with special slatted frames in all fixed beds
- + All lighting uses LED technology

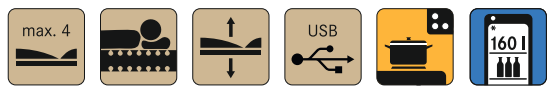





**For large groups:** The extra side bench with a headrest is integrated into the cosy seating area to make sure that even unexpected guests will feel at home.

**Pure enjoyment:** The modern kitchen with designer fittings will make cooking an exquisite experience. For meals large or small: With its 160-litre capacity, the fridge has plenty of room for storage (oven optional).



## SLEEPING COMFORT



**1 For a wonderful night's sleep:** There's extra storage space under the comfortable single beds with steps for easy access.

**2 Sweet dreams:** The spacious fold-down bed over the cab is equipped with cold foam mattresses. The reading spotlights integrated into the ceiling create a relaxing ambience.

## BATHROOM CULTURE



**More space:** Experience maximum freedom of movement in the Space Bathroom, which has a door to visually separate it from the living area. The spacious layout makes it possible for one person to shower on one side and another person to use the wash basin on the other side (only in the i 727).





## ELEGANCE

Travelling in the Elegance means enjoying a luxurious holiday as if you were in a 5-star hotel. At first glance, its timelessly attractive lines and stylish colour options show that this model lives up to its name. The interior's design will spoil even the most discriminating connoisseurs. No matter where you look, harmonious and luxurious ambience is found everywhere. With its masterful appearance, upscale features and a variety of functional details, the Elegance has found many fans in the elite class.

### Exterior advantages

- + Wide-track rear axle
- + GRP roof for better protection from hail and severe weather
- + Driver and passenger airbags
- + Heated double floor
- + Aluminium frame windows





## LUXURY IS AT HOME HERE

In the Elegance, you will love the spacious and open layout; the exquisite materials and the best workmanship used here will delight you. Everything has been designed with the sole purpose of providing you with an unlimited sense of comfort and well-being. Handles, fittings, taps, lighting – every detail has been lovingly designed and harmoniously coordinated. Exclusive quality and elegant design are brought to perfection here.

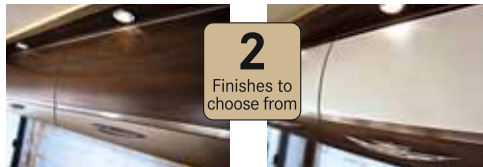

Bog oak

Magnolia

### Interior advantages

- + Electric fold-down bed
- + Optimum sleeping comfort: cold foam mattresses with special slatted frames in all fixed beds
- + Indirect lighting concept
- + Double floor with floor storage compartments







Elegance i 810 G



**Only the best:** Even the kitchen reveals that the Elegance is something special. The harmonious rounded edges, subtle colours and surprising details like LED light strips enhance the ambience of comfort and well-being. Of course the technology is also the finest in its class: A large gas stove with a glass cover, a 160-litre fridge in a monolithic look and large, fully extendible drawers provide the perfect conditions for preparing culinary delights.



Reliner



**Reliner seating:** Practical, functional and extremely comfortable – in 3 manual steps the bench turns into lounging furniture. An easily accessible storage compartment is located under the comfortable couch.



## SLEEPING COMFORT



The sleeping areas in the Elegance also impress with high-quality Super-Flex cold foam mattresses and rubber-supported slatted frames in all fixed beds. In the rear you can choose from two single beds or a king-size bed that can be accessed from both sides.

## BATHROOM CULTURE

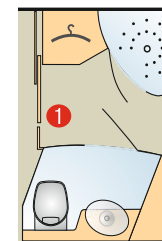

**Luxury spa:** The bathroom is a wellness oasis. In the Elegance that goes without saying. The separate shower offers plenty of room for extensive showering pleasure. Other premium details include a large, illuminated mirror, practical radiators, a towel holder and lots of shelves for hygiene articles and cosmetics. A large wardrobe stores your clothing. A sliding door ❶ can be used to separate the bathroom from the bedroom.





## GRAND PANORAMA

The Grand Panorama redefines spaciousness and comfort in the premium class of integrated motorhomes. Everything is bigger, more comfortable and more luxurious. When you step inside, the gigantic panoramic windscreen will impress you with breath-taking views of enchanting landscapes. Exquisite furnishings await you. Every single little detail is designed to create a unique atmosphere of comfort and well-being to delight you and ensure that every second of your holiday will be a very special moment.

### Exterior advantages

- + AL-KO low-frame chassis
- + GRP roof for better protection from hail and severe weather
- + Aluminium frame windows
- + Insulated and heated double floor
- + Premium XL cabin door
- + Coupe entry with electric step







Grand Panorama i 920 G

## A LUXURY SUITE WITH A BETTER VIEW

Attractive furniture with an elegant finish wherever you look. Only the best is good enough for the interior of the Grand Panorama. It's a grand feeling to know that you don't have to do without anything. This is seduction at the highest level, which you will enjoy with all of your senses. An electric blackout blind system meets the need for privacy and protection from the sun.

### Interior advantages

- + Gigantic panoramic front windscreen
  - + Electric fold-down bed
  - + Optimum sleeping comfort: cold foam mattresses with special slatted frames in all fixed beds
- + Alde hot water heating system Auxiliary heating
  - + Reliner seating
  - + Double floor with floor storage compartments
  - + 5.1 sound system

60/  
120 l





Grand Panorama i 920 G

The fascination of the Grand Panorama can only be experienced. What makes it special can be seen – and felt – throughout. The loving attention to detail makes all the difference. Whether it's the lighting applications, which are even integrated into the edge of the table,

the brilliant furniture finishes or the exclusive leather – everything around you exudes an ambience of comfort and well-being that's in a class of its own. For a completely new type of travelling experience.



**Pleasure comes from enjoyment:** Anyone travelling in a Grand Panorama is searching for something special. In the kitchen, high-quality materials, stylish forms and first-class functions pay tribute to sophisticated

demands. Every corner of the Grand Panorama shines with elegant applications. An indescribable experience of complete harmony with the highest degree of comfort.



## SLEEPING COMFORT



**Relax like a king:** Everything is of the highest standard! You should relax in the same way you travel. In the Grand Panorama, this means on high-quality Super-Flex cold foam mattresses with rubber-supported slatted frames. Perfect for ending an eventful day.



**You'll feel like royalty in your own wellness area** thanks to the many details meant to make you feel comfy and cosy. This includes the hidden, yet easily accessible sockets under the nicely illuminated mirror cabinet. So you can start and end each day refreshed and in a good mood.



## STANDARD FEATURES (EXCERPTS)

**Multijet II engine technology**

The engines transmit their power via a 6-speed gearbox.

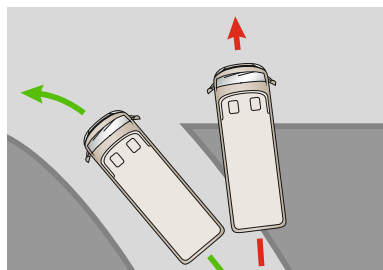
**ABS/ASR**

For more safety: The tyres will stay in lane when you hit the brakes and will not spin when you accelerate.

**3<sup>rd</sup> brake light**

The third brake light in the design of the Bürstner logo provides more safety as well as high recognition value.

**Cab Door – left side**

The separate left side door provides quick access to the cockpit.

**Aluminium frame windows**

The tinted windows with aluminium frames minimise wind resistance and wind noise.

**Airbag**

The safety technology will protect you in the event of an accident. A driver airbag comes as standard in all integrated models (passenger airbag comes as standard in the Grand Panorama).

**Blackout blinds in the cab**

The pleated cab blinds protect you from the sun and curious glances (not available on the Grand Panorama).

**Alloy rims**

The alloy rims not only cut down on weight but are also sporty.

**GRP roof**

The glass-fibre-reinforced plastic (GRP) roof for better protection from hail and severe weather.

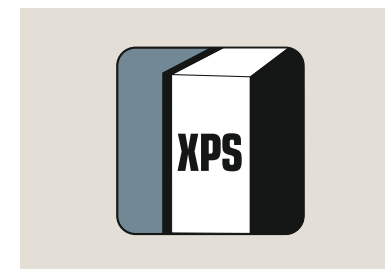
**XPS side walls**

We have used tried and tested lightweight construction technologies to significantly reduce the unladen weight of our vehicles while still maintaining the highest level of quality and insulation.

**Bus mirrors**

The large mirrors increase the rear viewing field and minimise blind spots.

**LED daytime running lights**

See and be seen: The popular daytime running lights impress with their brightness and energy efficiency.

**Bürstner double floor**

The heated double floor provides lots of storage space for bulky luggage and protects it from the cold when temperatures drop below freezing (not Viseo).

**Premium XL cabin door**

The new, extra-wide premium cabin door with a window, window screen and low coupe entry makes it easier to get inside (only on the Grand Panorama).

**Central locking for the cab and cabin doors**

For more security, simply press a button to lock and unlock the cab door (not available on the Viseo).



### Driver and passenger seats

The driver and passenger seats in all integrated models are upholstered in the same design as the interior as a standard feature.



### Electric fold-down bed

The fold-down bed above the cab has an electric lowering function (only in the Elegance and Grand Panorama).



### USB port

A USB connection via the 230 V socket supplies electricity to charge your smartphone or tablet.



### 2 finishes to choose from

You can choose from 2 furniture finishes (Elegance).



### 5-star sleeping comfort

More information about the Sleep Well Concept can be found on page 88.



### Soft-close kitchen drawers

With a touch of your fingertip, the drawers will slide back into the cabinet quietly and smoothly (Viseo).



### A combination fridge and freezer

A 160-litre fridge with a separate 30-litre freezer compartment (Elegance and Grand Panorama).



### Electric wastewater valve

Conveniently empty the wastewater tank. The release mechanism is practically located for easy access (Elegance and Grand Panorama).



### High-performance pump

No trickling water but an impressive flow with good water pressure in the kitchen and bathroom.



### Webasto auxiliary heating

Perfect for creating the right indoor climate, preventing condensation on the windows and warming up the engine (Grand Panorama).



### Upholstery options

Add your very own personal touch to the interior with 38 living designs to choose from.



### Storage compartment under the floor

Extra floor storage compartments are located in the double floor (Elegance and Grand Panorama).



### Rear garage

Those who enjoy being athletic while on holiday will find plenty of secure space for their bikes in models with a rear garage.



### BUS system technology

The BUS system technology makes it possible to control the individual light modules with a single switch (only on the Elegance and Grand Panorama).



### Navigation device

It's got it all: A radio and navigational system with an integrated display for route planning and a reverse driving camera (Grand Panorama).



# EXTERIOR COLOURS

## AVIANO

White (standard)



## ELEGANCE

Opal (standard)



Silver



White



## GRAND PANORAMA

Opal (standard)



White and silver (options)



## AVIANO

i 727

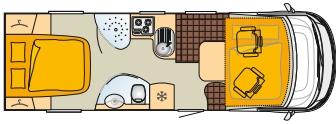

i 840 G

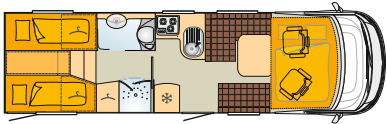

i 728 G

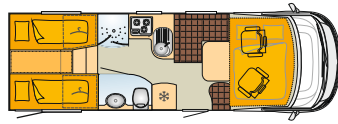

## VEISO SOVEREIGN COLLECTION

Be sure to ask for more information about our Viseo integrated models available in the "Sovereign Collection". Contact your dealer or go online to [www.buerstner.com](http://www.buerstner.com).

## ELEGANCE

i 800 G

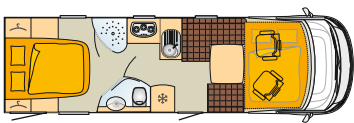

i 890 G

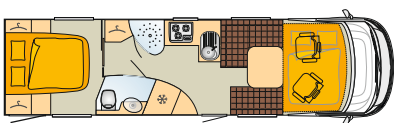

i 810 G

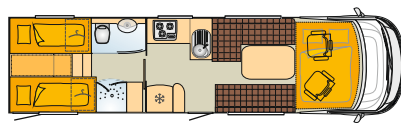

## GRAND PANORAMA

i 830 G

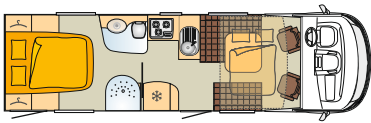

i 920 G

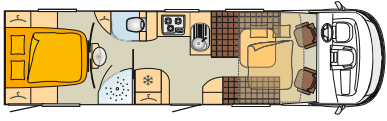

i 915 G

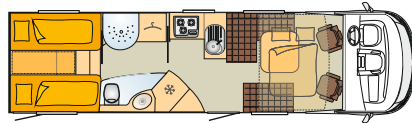

- Fixed bed
- Seating areas
- Bathroom/toilet
- Table/cabinets/shelves
- Wardrobe
- Refrigerator (freestanding)
- Fold-down bed
- Garage version

## AVIANO

- + AL-KO chassis with wide-track rear axle
- + Diesel particulate filter
- + Fog lights
- + Cab blinds with cassette storage
- + LED daytime running lights
- + 2 furniture finishes to choose from
- + Rotating pilot seats in the same design as the living area
- + Indirect lighting concept
- + Electrically operated step
- + Awning light
- + 12/230 V sockets

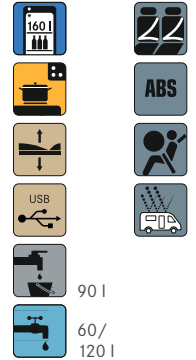

## ELEGANCE

- + AAL-KO low-frame chassis with wide-track rear axle
- + Fog lights
- + Cruise control
- + Dashboard finishing
- + Electric wastewater valve
- + Reverse driving camera
- + Cab air conditioning (manual)
- + Central locking system for the cab and cabin doors
- + Rotating pilot seats, height and tilt are adjustable
- + Carpeting in the cab
- + Electrically operated step
- + Indirect lighting concept

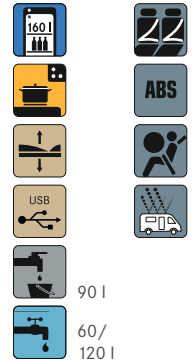

## GRAND PANORAMA

- + Gigantic panoramic front windscreen
- + AL-KO low-frame chassis
- + Hanging bus side mirrors
- + Up to 2 t trailing load
- + Cruise control
- + LED daytime running lights
- + Alloy rims
- + Double floor with floor storage compartments
- + Up to approx. 200 cm of standing headroom
- + Fog lights
- + Leather steering wheel
- + Multifunctional pleated cab blinds
- + Auxiliary heating
- + Electrically operated step
- + Reverse driving camera
- + Dashboard finishing
- + Air conditioning in the cab (automatic)
- + Alde hot water heating system
- + Reliner seating
- + Fully extending drawers
- + 5.1 sound system

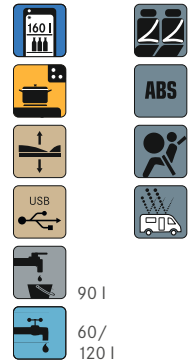

Explanatory legend on the fold-out page on the back



# ALCOVE MODELS

Alcove models are motorhomes with a sleeping niche above the cab. They are ideal for anyone who wants to go on holiday with the entire family without having to leave anything behind. The floor plans and standing headroom are practically perfect – even for tall people. The affordable price – compared to many integrated and semi-integrated motorhomes – makes this model series so popular.

## Advantages and characteristics of alcove models:

- + Especially attractive for families (family-friendly floor plans, some with up to 7 berths) and motorhome enthusiasts who travel year-round
- + Sleep without converting beds each day thanks to the fixed bed in the fold-down alcove
- + Optimal use of space and ample storage options, some models with a garage
- + Insulated living space in the winter thanks to thermal partitioning of the cab in the Argos
- + Up to 6 seats – all equipped with 3-point seat belts



## POPULAR SINCE THE LATE 1980S



The history of Bürstner motorhomes began with an alcove model. The first A 570 rolled off the assembly line in 1986.

Alcove models are still extremely popular today thanks to their spacious floor plans and storage options. To make sure this trend continues in the future, we are constantly making improvements to enhance the experience in this class of motorhomes.





## ARGOS

Want to set off on major holiday trips in any season? This is no problem with the Argos, which is well suited for winter travelling. With its impressive length of nearly 9 m, its AL-KO low-frame chassis makes it easy and safe to drive. In its standard version, the Argos already comes fully equipped with brilliant features such as the XL premium cabin door, aluminium frame windows and an Alde hot water heating system – not to mention its excellent value for money.

### Exterior advantages

- + AL-KO wide-track, low-frame chassis
- + GRP roof for better protection from hail and severe weather
- + Reverse driving camera
- + Aluminium frame windows
- + Insulated and heated double floor





Argos A 747-2 G



## EXCLUSIVE IS INCLUDED

Quality with a touch of luxury: The large side bench can be combined with the seating area to create a huge, relaxing couch. Lean back in the comfortable Reliner seat and enjoy the day. The storage cabinets are ventilated to prevent condensation from forming, even in the event of temperature differences. The integrated spotlights accentuate the tasteful furniture finish. Perfectly finished genuine wood edges give the interior its final touch. The underfloor double floor has plenty of storage space and can be heated so that you can relax and enjoy your freedom even when temperatures drop below freezing.

### Interior advantages

- + Alde hot water heating system
- + Fold-down alcove
- + Optimum sleeping comfort: cold foam mattresses with special slatted frames in all fixed beds
- + Wooden sliding partition door to the cab
- + Large seating area with Reliner seating for relaxing







Argos A 747-2 G



**Multifunctional:** Not only can the table be extended in a matter of seconds; at night the entire seating area can also be turned into a comfortable bed. The TV is nicely hidden away in a cabinet with rolling doors.



**A gourmet kitchen:** This kitchen offers everything that cooks love. With four gas burners and an oven, the possibilities are endless. The elevated sink is easy on your back. The extractor hood over the stove will keep smells out of the living area. Power sockets provide electricity.

## SLEEPING COMFORT



**Sleep well:** The high-quality cold foam mattress will guarantee a good night's sleep. Since it can be heated, the alcove will have a pleasant climate even on cold days.

## BATHROOM CULTURE



**A wellness oasis:** When you step inside the spacious bathroom in the Argos, luxury awaits you everywhere you look. Look forward to enjoying the illuminated mirror, a large designer wash basin, high-quality fittings and shelves.



## STANDARD FEATURES (EXCERPTS)

**Multijet II engine technology**

The engines transmit their power via a 6-speed gearbox.

**Cruise control**

The cruise control makes abiding by the speed limit easy and effortless.

**Bürstner double floor**

The heated double floor provides lots of storage space for bulky luggage and protects it from the cold when temperatures drop below freezing.

**Power windows**

Need some fresh air? Then just press the button.

**Rear garage**

The spacious rear garage provides room for a bicycle or scooter, which can be secured with straps and rails. The garage also comes with lots of practical shelves (Argos depicted here).

**Aluminium frame windows**

The aerodynamic design of the tinted windows with flush-fitting aluminium frames minimises wind resistance and wind noise.

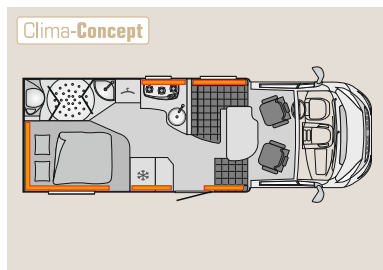
**Alde hot water heating system**

Guarantees that heat is equally distributed throughout the vehicle. Quiet and energy-efficient (Argos).

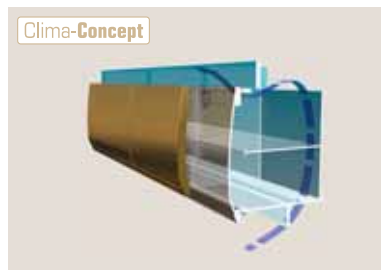
**Air-Plus**

Ventilated storage cupboards ensure a fresh and pleasant climate (Argos).

**Safe travels**

Even the seats facing the back of the vehicle in the seating area come with three-point seat belts (optional).

**Reverse driving camera**

The reverse driving camera makes it easy to see low obstacles when manoeuvring the vehicle.

**Electrically operated step**

The electrically operated extending step makes it easier to get in and out of the vehicle.

**Door sills**

Striking sills on the driver's and passenger's doors emphasise the dynamic character of the Argos.

**Toptron Crash Protection Unit**

Seals off the gas supply in the event of a crash (or if the vehicle is dangerously tilted at a sharp angle) and turns off all gas-consuming devices.

**HARTAL premium cabin door**

The double locking mechanism on the premium door provides additional security and is integrated into the central locking system as a standard feature.



Sleep-well-Concept

**5-star sleeping comfort**

More information about the Sleep Well Concept can be found on page 88.

**USB port**

A USB connection via the 230 V socket supplies electricity to charge your smartphone or tablet.

**Service panel**

You'll have all of the technology in view and under control thanks to the on-board control unit.

**Fold-down alcove**

Fold up the bed for more headroom above the pilot seats and easier access to the living area.

**Lighting in the alcove bed**

Whether you prefer mysteries or romances, reading in the alcove will always be perfectly comfortable.

**Lighting above the storage cabinet**

The attractive lamp casts everything in just the right light.

**Genuine wood edges**

High-quality genuine wood edges underscore the exclusive character of the interior.

**Lighting in the wardrobe**

So you can see exactly where your favourite outfits are hanging (Argos).

**Upholstery options**

Add your very own personal touch to the living space with your choice of 38 living designs.

**Oven/grill**

For cooking as comfortably as at home.

**Reliner XL seating**

Practical, functional and extremely comfortable – in 3 manual steps the bench turns into lounge furniture.



Development, production and sales are certified according to the international standard ISO 9001:2008.



Each Bürstner motorhome is covered by a comprehensive warranty for two years from the date of purchase.



We offer a five-year water ingress guarantee for your motorhome with an annual inspection (requires payment).

**GRP roof**

The glass-fibre-reinforced plastic (GRP) roof for better protection from hail and severe weather.



# EXTERIOR COLOUR

## ARGOS

White



## ARGOS

### A 747-2 G

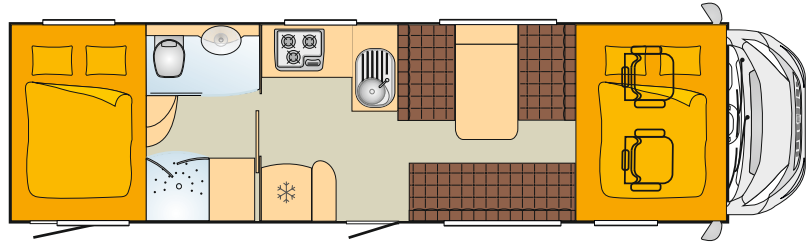

## ARGOS

- + AL-KO wide-track, low-frame chassis
- + Diesel particulate filter
- + Air conditioning (manual) incl. pollen filter
- + Insulated and heated double floor with additional storage capacity
- + Best seating comfort thanks to Reliner XL seating
- + Fold-down alcove
- + Ventilated storage cupboards (Air-Plus)
- + Cold foam mattresses in all beds
- + Space Bathroom
- + Cooker with 4-burner hob, oven and grill
- + Reverse driving camera
- + Rear garage (incl. lashing rings)
- + Aluminium frame windows
- + Alde hot water heating system
- + Mounting bracket for a flatscreen TV
- + Wooden sliding door between the cab and living area
- + Electrically operated step
- + Electric release valve for the wastewater tank



90 l



130 l



Explanatory legend on the fold-out page on the back



# Clima-Concept

## A PERFECT CLIMATE OF COMFORT AND WELL-BEING

With its new Clima Concept, Bürstner ensures the perfect atmosphere at all times. A number of useful improvements do their part to make sure that you can enjoy an unlimited sense of comfort and well-being no matter what the temperature is outside. After all, this should be a given on any holiday in a Bürstner.

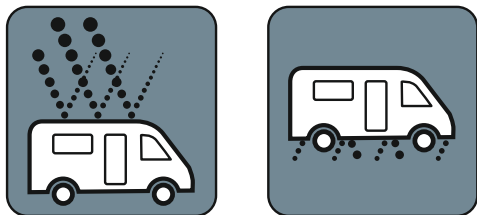

### GRP ROOF AND FLOOR

The glass-fibre-reinforced plastic (GRP) roof provides the best possible protection from hail and severe weather. Thanks to its impact resistance, the GRP sub-floor protects against damage from below.

Please speak with your Bürstner dealer to find out which details are available on your desired model.

### WOOD-FREE DESIGN WITH XPS INSULATION (Travel Van and Nexxo)

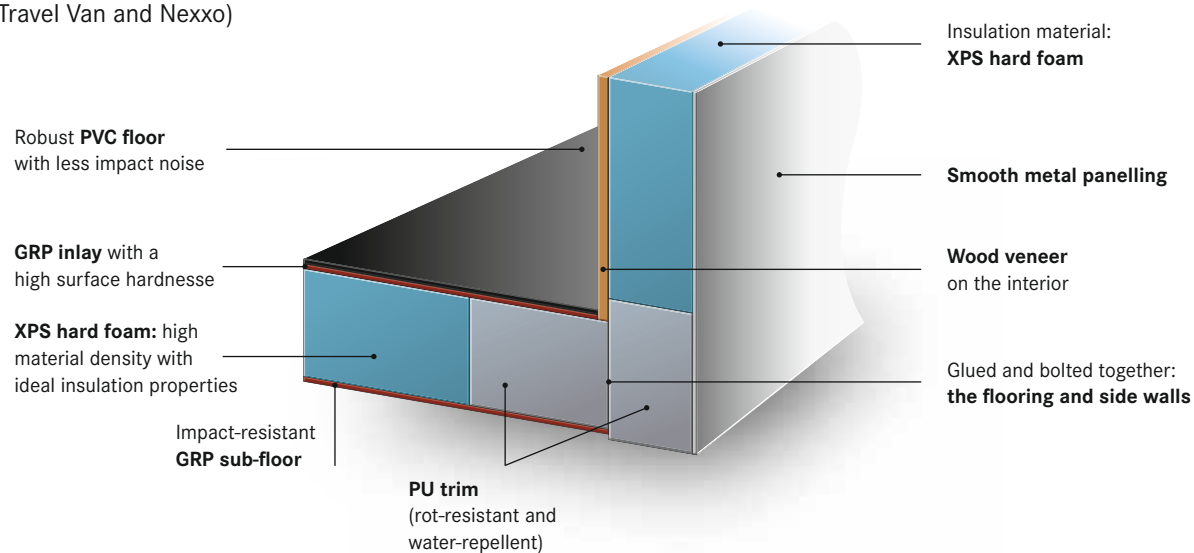

### Air-Plus

### THE BEST AIR CONDITIONING AND HEATING TECHNOLOGY THANKS TO THE TRUMA COMBI HEATING SYSTEM

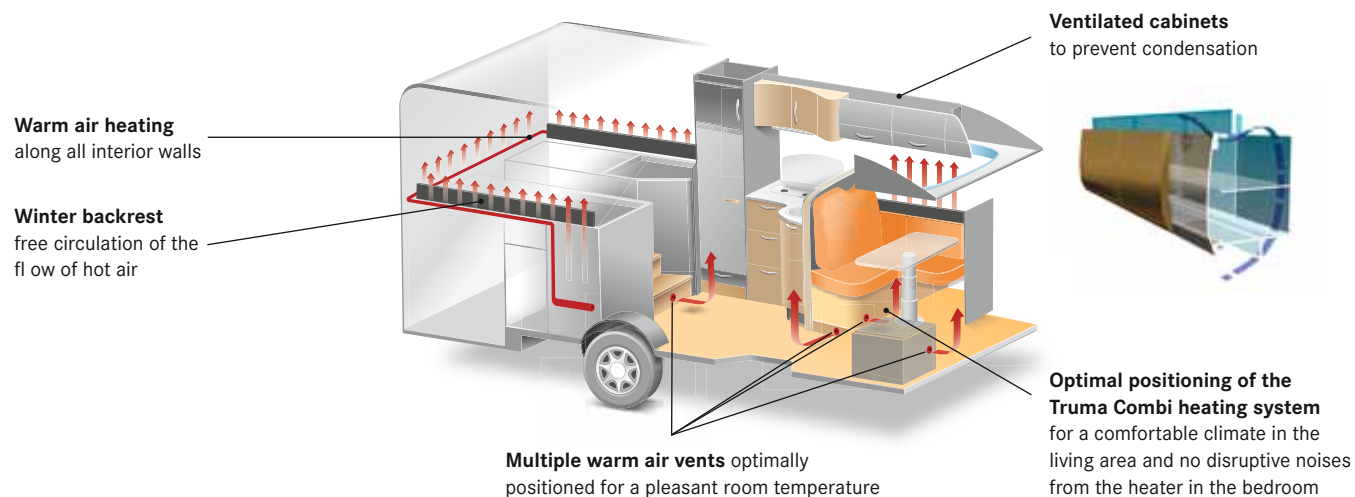

**Optimal positioning of the Truma Combi heating system** for a comfortable climate in the living area and no disruptive noises from the heater in the bedroom

## ALDE HOT WATER HEATING SYSTEM

The Alde hot water heating system will indulge you with balanced heat distribution, low energy consumption and extremely quiet operation. Placed along the exterior walls, the convectors heat the air as well as the walls and furniture to create an air seal that keeps the cold away from the windows.

Ventilated storage cabinets support the optimum flow of air up to the ceiling until the convectors reheat it. The air circulation keeps the inside warm and toasty even when temperatures outside drop below freezing.

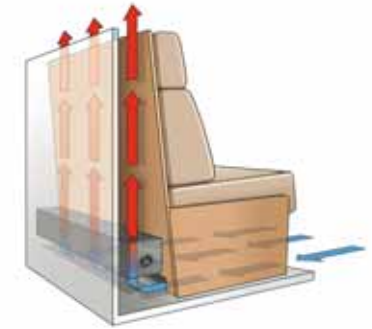
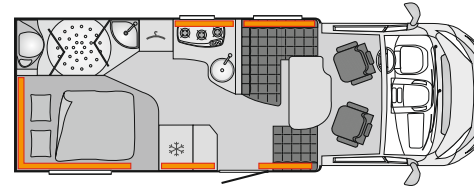

## LIGHT AND VENTILATION

Light and airy: The interior design of every Bürstner strives to live up to this claim. Thanks to many major and minor improvements, Bürstner helps to ensure that your holiday will be fondly remembered for a long time to come.



**Bright and friendly:** Experience enlightening moments at any time with the skyroof.



**Gigantic:** The XL skyroof lets even more light in.

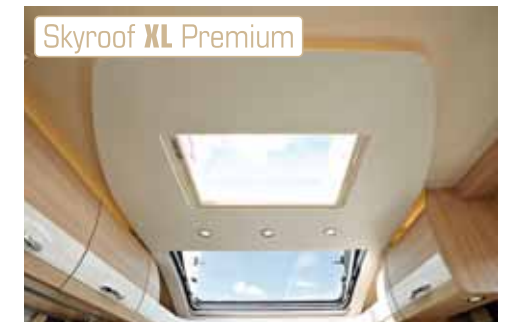

**For maximum light:** the Midi-Heki and the skyroof XL with integrated LED lighting.



No matter whether you are in the kitchen, bedroom or bathroom, you will always be



surrounded by lots of fresh air and daylight. The clever light and ventilation concept



creates a pleasant atmosphere inside.



# Useability-Concept

## ERGONOMIC SOLUTIONS

Ergonomics and functionality are just as important as looks. That is why every Bürstner strives to bring these two aspects into perfect harmony so that an unlimited sense of comfort and well-being isn't just a visual experience but one you can enjoy with all of your senses.

### Service-Unit

All in one place: The new service unit isn't just easy to reach but is also convincing since all relevant supply elements are bundled together. This means that you'll no longer have to ask yourself where things go. Instead, everything is exactly where it belongs.

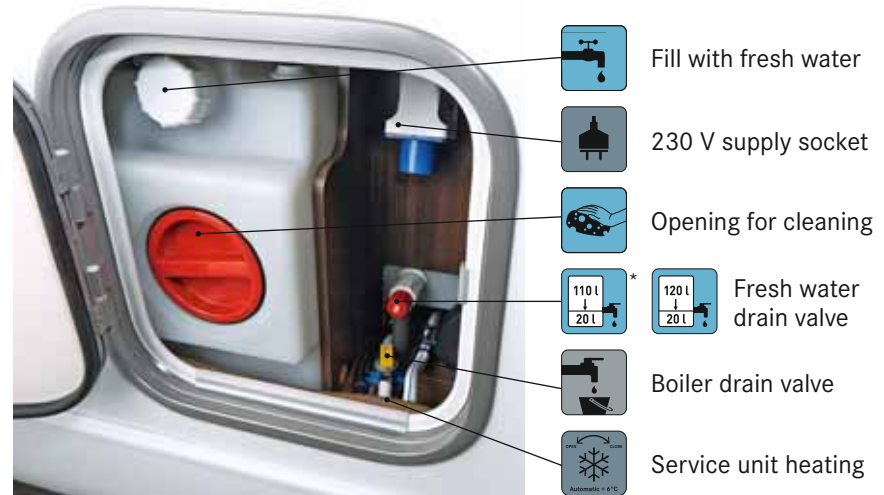

\*Travel Van



**COUPE ENTRY**  
Easily get in and out: The low entry makes it nice and easy to get in and out of the vehicle.



Body door **XL**



Body door **XL Premium**

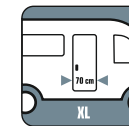

**COMFORTABLE ENTRY THANKS TO A WIDER DOOR**

#### Body door **XL**

- Cabin door measures 700 mm in width (exterior dimensions)
- 1-point locking mechanism
- Waste bin
- Coupe entry

#### Body door **XL Premium**

- Cabin door measures 700 mm in width (exterior dimensions)
- Window
- 2-point locking mechanism
- Waste bin
- Window screen
- Coupe entry
- Central locking (optional)



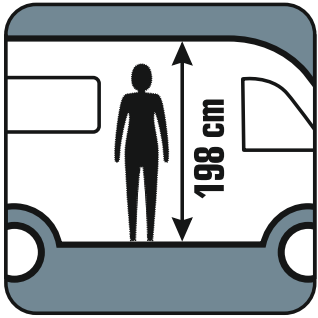

**NEW STANDING HEADROOM:**  
198 cm (+3 cm)

Thinking big: The new standing headroom offers more comfort for tall people as well as a perfect sense of space for all passengers (in the Nexxo and Travel Van).



**Vario Bathroom**

A turning point: For more room to shower, simply swivel the wash basin to the side.



**Flexo Bathroom**

All in one: Swivel the wash basin and back wall to the side to reveal a shower that impresses with its spacious size.



**Space Bathroom**

Nicely separated: Shower on the left, wash basin and toilet on the right: There's room for everything. The bedroom/bathroom can be optimally separated from the rest of the living area.



**A STEP UP TO THE BED IN THE REAR**

Thanks to the pull-out step, which also acts as a storage compartment, getting into bed is easy.



**PASSAGE WIDTH IN THE VEHICLE**

Anyone can get through: Thanks to the wider passage width, getting into bed will be even more comfortable.



**ROUNDED OVERHEAD CABINETS (NEXXO)**

Comfortably positioned: The cabinets above the kitchenette are rounded without losing any of their depth. This gives you more headroom.



**LED-Night-System**

Thanks to the LED Night System with pleasantly reduced lighting, you can easily find your way around, even in the dark.



# Sleep-well-Concept

## YOU'LL SLEEP JUST RIGHT HERE

An unlimited sense of comfort and well-being also includes a restful night's sleep. In a Bürstner you'll enjoy the relaxation you need after an eventful day so that you can recharge for your next adventure.

From double beds to single beds and popular bunk beds for children, we have the right solution for every preference. We've also added clever comfort ideas to make sleeping really comfortable in any position. Sleep well – and sweet dreams!



Super-Flex cold foam

### STANDARD IN ALL FIXED BEDS

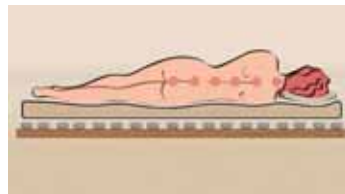

#### Cold foam mattress and special slatted frame

The cold foam mattresses in all fixed beds support the body and relieve the back. Slatted frames with flexible rubber supports optimally distribute your body weight (except in the fold-down bed in the Ixeo time).



#### Mattress cover

Anti-allergenic, removable and washable.



#### Fitted sheets

Fit all the mattresses in the fixed beds.



**THE NEW FOLD-DOWN BED IN THE IXEO TIME**

Deep sleep: The electric fold-down bed (standard) can now be lowered to the same level as the bench. This means that you won't need a ladder or a step (only in the Ixeo time it 586 and it 590).

**FOLD-DOWN BED IN SEMI-INTEGRATED MODELS**

Travel with four people instead of just two: The fold-down bed in the Ixeo makes this possible - and impresses with spacious bed dimensions (197 x 143 cm).

**ALCOVE BED**

The fold-down alcove above the cab reveals two full-size berths.

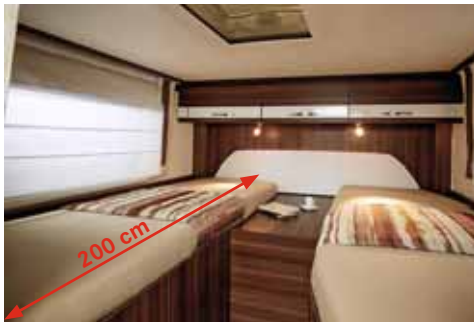

**XL SINGLE BEDS**

Almost every floor plan with single beds has a bed with a minimum length of 200 cm.

**FREESTANDING DOUBLE BED**

A permanently installed queen-size bed measuring 200 x 150 cm (the Nexxo is depicted here).

**ADAPTABLE**

The headboard can be adjusted to a lounging, resting or reading position.

**BRIGHT SPOTS**

The reading spotlights positioned above the beds can be individually adjusted.

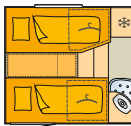

Single beds

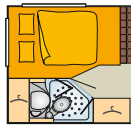

French bed



Rear bed lateral

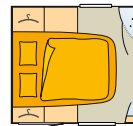

Queen-size bed

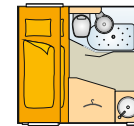

Bunk beds

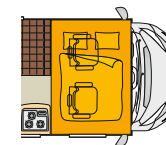

Fold-down/alcove bed

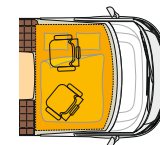

Fold-down bed in integrated models

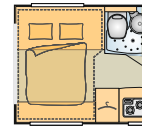

Fold-down bed in the Brevio



# Storage-Concept

## CLEVER STORAGE SOLUTIONS

When you're on the road, you need room for all the big and small things you require on holiday. That is why the new Storage Concept has been designed down to the very last millimetre – to cleverly provide the maximum amount of space. After all, not having to do without anything is part of enjoying an unlimited sense of comfort and well-being.



## GARAGES

The easily accessible garages ensure that you have everything with you. You can take your entire fleet along with you in the rear garage. Depending on the model, some garages are accessible from both sides.



## BÜRSTNER DOUBLE FLOOR

The heated double floor provides lots of storage space for bulky luggage and protects your valuables from the cold when temperatures drop below freezing.



Apothecary drawer

### PULL-OUT DRAWERS

Well sorted: The pull-out drawers have plenty of room for all of your kitchen utensils.



### DEEP STORAGE CABINETS

Now even more things fit in the deeper storage cabinets.



### WARDROBES

You are what you wear: By optimising the floor plans, we were able to create even more space for large, easily accessible wardrobes in the bathroom, living area and under the bed.



### REFRIGERATOR

Well provided for: Thanks to their size, the refrigerators in a Bürstner are now practically as good as your appliances at home.



### SHOE CABINETS

Practically located: The shoe cabinets are exactly where they belong – in the entry area.





# Safety-Concept

## SAFETY IS ALWAYS ON BOARD

On holiday, relaxation and well-being are the top priority. This also includes a good feeling of safety. In a Bürstner you will find a number of solutions that will help you enjoy even greater peace of mind while on holiday.

**ABS**

**ASR**

**ESP**

### ELECTRONIC REGULATION SYSTEMS

Three technologies for more safety: The tyres will stay in lane when you hit the brakes and will not spin when you accelerate thanks to ABS and ASR. The electronic stability programme also helps to keep the vehicle from swerving by applying the brakes specifically to individual wheels. ASR and ESP are available for a surcharge.



### LED DAYTIME RUNNING LIGHTS

You're safer on the road with LED daytime running lights (standard or optional depending on the model series) since other road users can see you in good time.



### AIRBAGS

In case of an emergency, a driver airbag comes as standard in all models. A passenger airbag is also an available option.



### 3<sup>RD</sup> BRAKE LIGHT

The third brake light in the design of the Bürstner logo provides more safety as well as high recognition value.



### REVERSE DRIVING CAMERA

The optional reverse driving camera makes it easy to see even low obstacles when manoeuvring the vehicle.

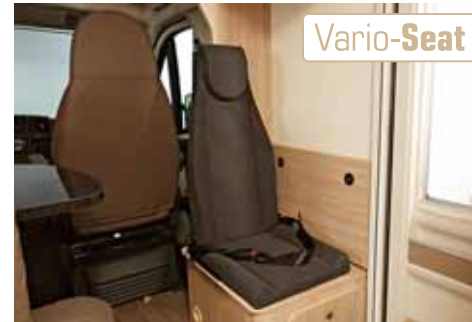

### A FIFTH SEAT WITH A SEAT BELT

In a matter of seconds, you can create an extra seat with a seat belt for another passenger (optional depending on the model and floor plan).

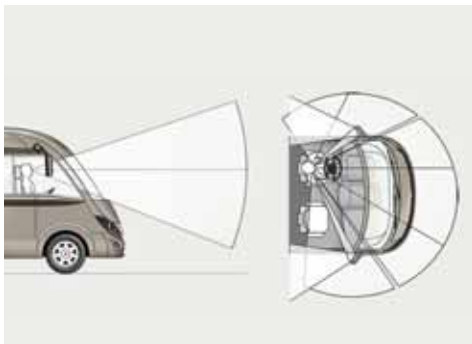

### ALL-ROUND VISIBILITY IN INTEGRATED MODELS

The integrated models convince with an optimised field of vision thanks to the low windscreen. The combination of large side mirrors and windows means that you won't have any blind spots when you look behind you.



### TOPTRON CPU

The optionally available Toptron CPU (Crash Protection Unit) seals off the gas supply and turns off all gas-consuming devices in the event of a crash (or if the vehicle is dangerously tilted at a sharp angle). Thanks to Toptron, you can safely use gas appliances even while on the road (standard on some models).



### WARRANTIES/ISO STANDARD

Each Bürstner motorhome is covered by a comprehensive warranty for two years from the date of purchase. We even offer a five-year water ingress guarantee with an annual inspection (requires payment). Development, production and sales are certified according to the international standard ISO 9001:2008.



### Body door **XL Premium**

The double locking mechanism on the premium door provides additional security. The wide passageway also makes getting in and out even more secure. Standard on the Grand Panorama, available as an option on many models.



# CHASSIS

## GUARANTEES FOR A GOOD RIDE

In a Bürstner you can also expect only the best when it comes to chassis and drive technology. After all, our partners have the same standard of perfection as we do.

All Bürstner models are based on the Fiat Ducato, which is characterised by its reliability and rich variety and is one of the best-selling base vehicles for motorhomes. In this cooperative partnership, the established manufacturer contributes its many years of experience and expertise and incorporates our requirements as a motorhome producer even during vehicle development.

This results in chassis that set standards in terms of functionality and safety. Many model series use a low-frame chassis with a wide-track rear axle, which improves driving comfort and road handling as well as allowing for new floor plans with a lower vehicle height. The engines have also been further developed. The Ducato has modern, efficient Euro 5 diesel engines with particle filters, convincing with good power, low fuel consumption and fewer CO<sub>2</sub> emissions.

### FIAT CHASSIS

#### Spaciousness

The cab offers a lot of freedom to move around and comfortable access to the living area.

#### Seats with armrests on both sides

The seats offer an ideal seating position thanks to the turntables originally supplied by Fiat.



#### Wide-track rear axle

Greater driving stability and spaciousness are ensured thanks to the widely spaced wheel arches.

#### Special low-frame chassis

Developed by Fiat to make the vehicle lighter, yet still stable. It increases the loading capacity and lowers the centre of gravity.



#### Multijet II engine technology

The engines transfer their power via a 5- or 6-speed gearbox, which is specially adapted to the requirements of motorhomes.



### THE STRENGTHS OF THE FIAT DUCATO

- + The latest generation of chassis and engines for safety, functionality and driving comfort
- + High torque in the low RPM range for better acceleration
- + Reduction of fuel consumption and CO<sub>2</sub> emissions
- + Euro 5+ turbo diesel engines with 16 valves and the new Multijet II common rail direct injection
- + Many engine options are available in combination with the latest automatic transmissions

## ADVANTAGES OF OPTIMISED EXTERIOR HEIGHT

- + Comfortable headroom when standing inside creates a pleasant sense of space
- + Good aerodynamics enable more efficient engine power with less fuel consumption
- + Less wind noise and sensitivity to lateral wind for greater driving comfort and safety



## AL-KO AMC-CHASSIS

For the 2015 model year, Bürstner is equipping numerous model series with the AL-KO AMC chassis in a slimmed-down lightweight construction. An important argument in favour of the AL-KO AMC chassis is that, thanks to the weight saved by using this chassis, higher loading capacities can be realised. At the same time, the maximum permissible weight class of up to 3.5 tonnes is observed. The wide axle track width increases driving comfort and offers the best possible safety on the road.



Many of our motorhomes do not exceed the 3.5-tonne class.

For you this means:

- + More loading reserves
- + Lower fuel consumption
- + No additional requirements to comply with road traffic regulations

## ADVANTAGES OF THE AL-KO AMC CHASSIS

- + Lower unladen weight compared to the original frame, thus more loading capacity
- + Allows for customised floor plan layouts thanks to individual wheelbase and overhang variations
- + Low overall vehicle height thanks to the low-frame chassis with frame lowering of up to 220 mm
- + Optimised rolling stability and increased driving safety thanks to low centre of gravity and a wide-track chassis
- + Car-like suspension comfort
- + Optimum corrosion protection thanks to hot-dip galvanised frame components
- + Comprehensive, tested accessories that have been specially tailored to the AL-KO AMC chassis
- + The highest safety standard thanks to permanent quality controls on one of the most modern test tracks in Europe (certified according to DIN ISO 9001)



# COMPANY AND QUALITY

## OUR PRIORITY: SATISFIED CUSTOMERS!

Bürstner is one of the leading manufacturers of caravans and motorhomes. We want anyone who is out and about with a Bürstner to always feel an unlimited sense of well-being wherever they are.

All ideas, concepts and implementations in all model ranges are focused on this requirement.

Bürstner has set new standards in customer service. Bürstner was one of the first manufacturers to open its own Customer Service Centre in 2004. From here, the supply of replacement parts is organised for all of Europe. It is here that all those interested in caravans and motorhomes can get an overview of Bürstner's many innovations. Everything technically and humanly possible is done to make sure that your free time spent in a Bürstner is an unforgettable experience.



*Development, production and sales are certified according to the international standard ISO 9001:2008.*



*Bürstner fulfils the DIN 2001-2 drinking water standard in all vehicles.*

# SERVICE

WHICH MOTORHOME IS RIGHT FOR ME?  
OUR ONLINE ADVISOR CAN HELP.



With 11 model series and 39 floor plans, Bürstner has one of the broadest ranges of motorhomes on the market. By answering just

a few questions, our vehicle advisor will help you to find the right floor plan.

HOW SHOULD MY DREAM VEHICLE BE EQUIPPED?  
OUR ONLINE CONFIGURATOR CAN HELP.



Use the configurator to create your individual recreational vehicle in just a few steps. Once you've found

the right floor plan, you can equip your dream mobile home using our vehicle configurator.

## PASSION FORMED FROM DETAILS

We are known for our high quality, which is the result of a modern production process – and the people who put a great deal of care and attention to detail into this process. At Bürstner, modern computer technology is combined with nearly 30 years of experience in motorhome construction. Each model is first realised virtually down to the very last detail. A close network connects all areas from development to manufacturing and sales, and is certified according to the strict ISO 9001 specifications.

Because only the best is good enough for a Bürstner, our engineers are always on the lookout for optimum solutions. We set standards but are never fully satisfied with them. After all, we want to make sure that we remain a leading producer of motorhomes in the future as well – and that we continue to surprise you with innovative ideas.

A highly qualified team is dedicated to producing the furniture for our caravans and motorhomes. Carefully selected materials, solid craftsmanship and the use of sturdy locks and hinges stand for quality and security.







## 38 LIVING DESIGNS TO CHOOSE FROM

IT TAKES JUST TWO STEPS TO CREATE YOUR INDIVIDUAL AMBIANCE FOR A SENSE OF WELL-BEING



1. Select the upholstery quality you like most. You can choose from a total of 4 high-quality materials.
2. The back cushion adds a splash of colour. Select from up to 7 different options depending on the category.

## CREATE YOUR VERY OWN STYLE

### THE NEW UPHOLSTERY GENERATION

#### Innovative and customer-oriented:

- 28 high-quality textile living designs to choose from
- Greater seating comfort thanks to the new upholstery design
- Back cushions are removable and easy to clean



### 1. SELECT YOUR UPHOLSTERY QUALITY



## 2. SELECT YOUR BACK CUSHION (each available in combination with woven textile or imitation leather upholstery)



ASCOT



BRISA



CALAIS



COVENTRY



FRANCA



HARLOW



WALIS







# FABRIC VARIETY – NOVA QUALITY

EASY TO CLEAN. AGREEABLE TO THE SKIN. LONG-LASTING.



### Innovative and customer-oriented:

- 8 Nova Quality colour combinations to choose from
- Greater seating comfort thanks to the new upholstery design
- Back cushions are removable and easy to clean

## SEAT UPHOLSTERY



## BACK CUSHIONS





Nova Quality is a revolutionary synthetic fibre that is extremely durable and resistant to dirt. If you happen to spill something, you just need a cloth and some fresh water to get rid of any trace.



At the same time, this breathable upholstery feels wonderfully warm and soft – and great on the skin. You'll also like the fact that Nova Quality is available as an option in all models (standard in the Argos and the Elegance).



NOVA LUPA



NOVA GOA



## LEATHER

### LONGLIFE QUALITY LEATHER.



FERRA

LongLife leather is a fascinating material. It is pleasant to feel, smell and cuddle up against. At the same time, it is robust, long-lasting and easy to clean.

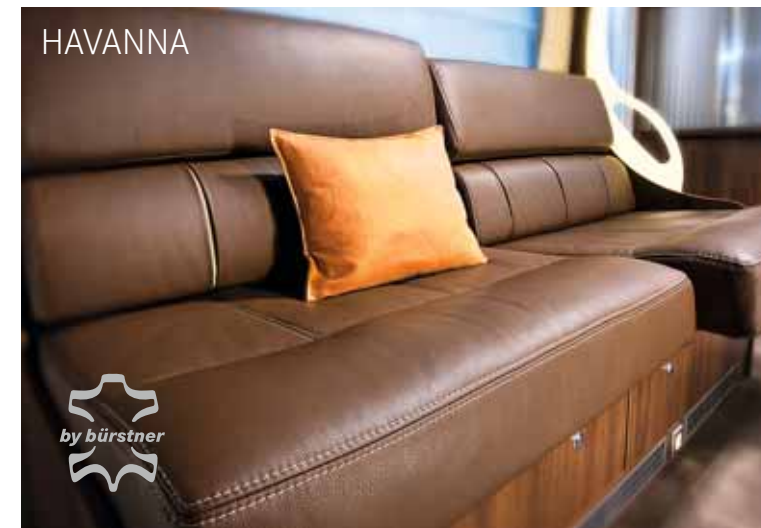

HAVANNA



# COMPACT MODELS

## BREVIO

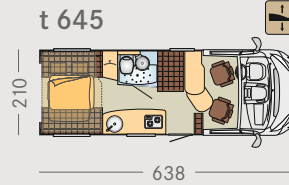
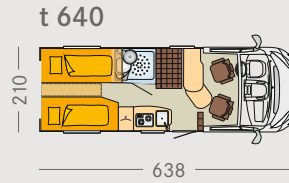
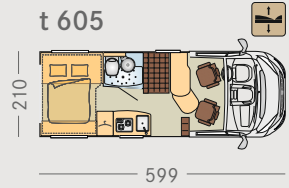

## TRAVEL VAN

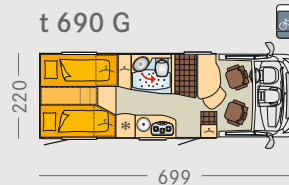
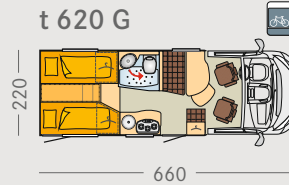
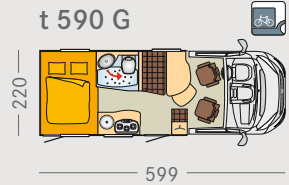

# SEMI-INTEGRATED MODELS

## NEXXO TIME

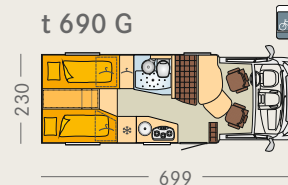
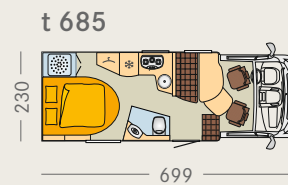
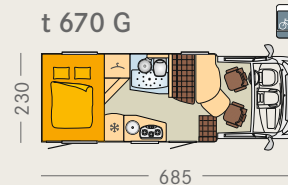
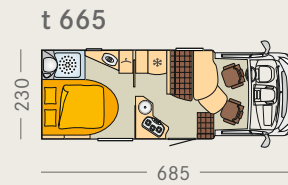
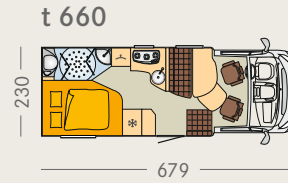
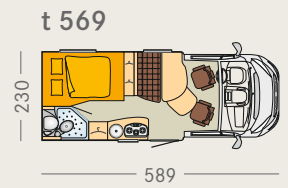

## NEXXO

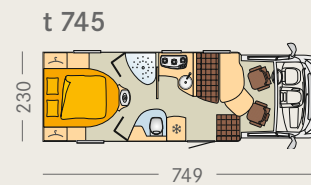
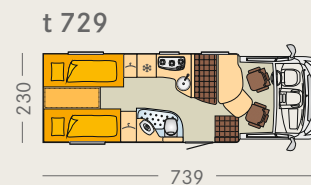
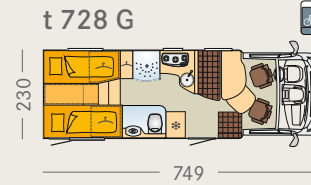
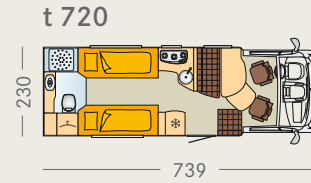
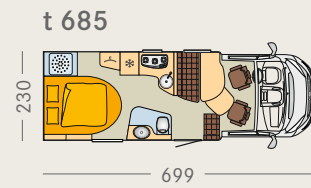

# IXEO-CLASS

## IXEO TIME

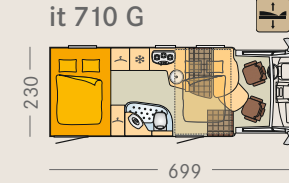
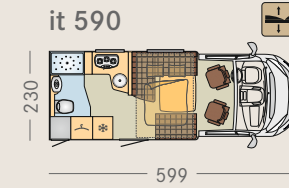

## IXEO

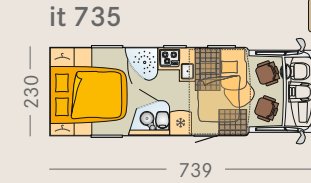
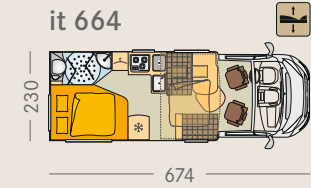

### SOVEREIGN COLLECTION

3 more Nexxo, Ixeo time and Viseo floor plans with attractive extra features in the "Sovereign Collection". Contact your dealer or go online to [www.buerstner.com](http://www.buerstner.com) to learn more about our special "Sovereign" models.

- Fixed bed
- Seating areas
- Bathroom/toilet
- Table/cabinets/shelves
- Wardrobe
- Refrigerator (freestanding)
- Fold-down bed
- Garage version















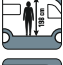
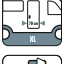
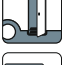



All lengths and widths provided in "cm" from the exterior without a rear ladder.

# INTEGRATED MODELS

AVIANO	ELEGANCE	GRAND PANORAMA
<b>i 727</b>  230 x 756	<b>i 800 G</b>  230 x 812	<b>i 830 G</b>  230 x 842
<b>i 728 G</b>  230 x 756	<b>i 810 G</b>  230 x 920	<b>i 915 G</b>  230 x 900
<b>i 840 G</b>  230 x 841	<b>i 890 G</b>  230 x 900	<b>i 920 G</b>  230 x 900

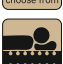
# ALCOVE MODELS

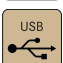
ARGOS
<b>A 747-2 G</b>  230 x 886

-  Vehicle weight under 3.5 t
-  GRP roof
-  GRP floor with Bürstner lightweight construction technology
-  Vehicle height
-  Standing headroom in the vehicle
-  XL cabin door
-  Coupe entry
-  Bicycle garage
-  Central locking system
-  XPS side walls
-  Wastewater tank
-  ABS
-  Airbag
-  Fresh water tank
-  Refrigerator volume in litres
-  Number of burners (hob)
-  2 Finishes to choose from
-  38 Fabrics to choose from
-  Super-Flex cold foam mattress
-  max. 4
-  Fold-down bed
-  USB



Subject to differences in texture and colour in relation to the illustrated fixtures and fittings, insofar as they are in the nature of the materials used and are customary. The same applies to technical modifications to the vehicle, provided that the product quality overall remains equal or is improved, and use is not impaired.

Note: Special driving licences may be required to drive a motorhome!

This brochure does not constitute an offer by Bürstner GmbH. Bürstner reserves the right to alter specifications and prices at any time as materials and conditions demand. Distributors and dealers sell Bürstner products on their own account and not as agents for Bürstner. Accordingly they have no authority to bind Bürstner or to make and representation or undertaking whatsoever on behalf of Bürstner.

All props are for photographic purposes only and are not included in the vehicle specifications.

All Bürstner motorhomes are manufactured to European Whole Vehicle Type Approval (EWTVA). This is your assurance that our vehicles meet all relevant European standards of safety and manufacturing.

Whilst every effort has been made to ensure the accuracy of the information in this brochure Bürstner does not accept liability for any errors or omissions.

The models illustrated in this brochure generally show the specifications for the German market. In part they include optional equipment and accessories not fitted as standard. Alterations in models, standard and optional equipment, as described in the text and illustrations may occur. For precise information on model features, and the exact level of equipment for the UK market, please contact your Bürstner Motorhomes dealer. Design, and equipment are all subject to change.

YOUR BÜRSTNER DEALER LOOKS FORWARD TO SEEING YOU!

**Bürstner UK**

PO Box 164,  
Bishop Auckland,  
DL13 1WZ  
Tel. +44 1388/537960

**Bürstner GmbH**

Weststraße 33  
D-77694 Kehl  
Tel. +49 7851/85-0  
Fax +49 7851/85-201  
info@buerstner.com  
www.buerstner.com

GB



*Grenzenlos wohlfühlen*